

***Full Program ***

Updated 1/14/12

Eastern Economic Association 2012 Meetings

Please be advised that there are probably still errors in this program. Corrections and change requests need to be made to eea@ramapo.edu by January 20, 2012.

If you cannot find your name: use the edit search feature of word, to see if you are in a session and not indexed. If that is the case, contact us.

If you are indexed, but the session does not contain your paper, use the edit search feature of word to find yourself, then contact us.

If you don't exist in the program, contact us immediately.

If you are to appear in multiple locations at the same time, please have yourself cloned or contact us.

Thanks,

The EEA team of sleep deprived schedulers.

WELCOME

Welcome to the 38th Eastern Economic Association Annual Meetings in Boston, Massachusetts. Our incoming President-Elect **James Poterba**, session chairs, organizers, and review committee have done a great job putting together this year's program, which I hope you will find as intellectually exciting as I do. The program furthers the EEA's tradition of encouraging intellectual debate, open to all points of view. I'd particularly like to welcome those attending the conference from other regions of the country and other parts of the world.

This has been another year of growth and increasing outreach for our Association. Starting in 2009, the EEA has partnered with the Federal Reserve Bank of New York and the Federal Reserve Board of Governors to sponsor the Federal Reserve Bank Challenge. This program is a competition by which five person teams from various colleges make 20 minute presentations to academics, practitioners, and Fed economists as to whether the Federal Reserve Open Market Committee should raise, maintain, or lower the targeted Fed Funds Rate. A panel of expert judges also questions the students on a wide range of issues. This year 32 teams participated in New York. Students who participated have very positive feelings about the Challenge. In addition to the program in New York, the Federal Reserve Bank of Philadelphia joined the EEA to sponsor a Fed Challenge program in the Third Federal Reserve district for the second time. Eight teams competed on November 8 and we look forward to seeing more teams next year. By working with the Federal Reserve System, the EEA is fulfilling one of its missions by promoting economic education. I would like to thank the members of the Fed Challenge Advisory Board for their service: **Howard Freeman**, **Ray Stone**, CEO Stone & McCarthy Research Associates, **Hank Bitten**, Supervisor of Social Studies and Economics at Indian Hills High School, **Blake Gwinn**, Federal Reserve Bank of New York Markets Group, **Charles Steindel**, Chief Economist for the State of New Jersey, and professors **Julio Huato** (St. Francis College), **Jeff Rubin** (Rutgers), **Paul Wachtel** (NYU). I also would like to thank Lloyd Bromberg and Sharon Berstein for serving as the coordinators in each district, and their compatriots at each Fed, **Jane Katz** (New York) and **Dede Myers** (Philadelphia).

The Eastern Economics Journal, our Association publication, has continued to flourish under the editorial leadership of **Susan Averett** and **Edward Gamber**. Two officers of the Association, **Alexandre Olbrecht**, our Executive Director, and **Steve Pressman**, our Treasurer, deserve special thanks for their ongoing work tending to the business of the Association.

Finally, I would like to thank The Anisfield School of Business at Ramapo College of New Jersey, the College's Board of Trustees and its president, **Peter Mercer** for providing a home base for the EEA. Ramapo College has given the Association a warm welcome.

At a time when the world needs the kind of vigorous open discussion of economics the EEA fosters, I feel privileged to have served as your President.

Duncan K. Foley
Eastern Economic Association President

EASTERN ECONOMIC ASSOCIATION

Board of Directors

EXECUTIVE COMMITTEE

President: **Duncan K. Foley**, The New School for Social Research

President-Elect: **Glenn Loury**, Brown University

Vice-President: **James Poterba**, Massachusetts Institute of Technology

Past-President: **Paul Krugman**, Princeton University

Executive Director: **Alexandre Olbrecht**, Ramapo College of New Jersey

Treasurer: **Steven Pressman**, Monmouth University

Eastern Economic Journal Co-Editors:

Susan L. Averett, Lafayette College

Edward N. Gamber, Lafayette College

DIRECTORS

Mina Balamoune-Lutz, University of North Florida

Ann E. Davis, Marist College

Giuseppe Fontana, University of Leeds (UK)

Joyce Jacobsen, Wesleyan University

Philip N. Jefferson, Swarthmore College

Martha Starr, American University in Washington D.C.

2012 PROGRAM COMMITTEE

Chair: **James Poterba**, Massachusetts Institute of Technology

Session Organizers:

2012 Program Committee (*continued*)

Exhibitors

Company	Booth Number
Association Book Exhibit	
M.E. Sharpe Inc	
Palgrave Macmillan	1B
Pearson	
The New York Times	
Oxford University Press	
Virginia Tech - Pamplin College of Business	
Worth Publishers	1A

AM I MISSING ANY?

The Eastern Economic Association is grateful for the support of the companies listed above. Please take time during the conference to visit their exhibits in Empire East. Their purchase of space helps pay conference expenses and keeps our fees down. You can show your appreciation by looking over their books and other products during coffee breaks (please see the Calendar of

Events for exhibit hours and times of coffee breaks).

PARTICIPATING ORGANIZATIONS

African Finance and Economics Association (AFEA)

Association for Social Economics (ASE)

Committee on the Status of Women in the Economics Profession (CSWEP)

European Union- European Monetary Union (EU-EMU) Working Group

Issues in Political Economy (IPE)

National Association of Forensic Economics (NAFE)

New Direction in Political Economy (NDIPE)

North American Association for Sports Economics (NAASE)

NYC Computational Economics & Complexity Workshop

Society for the Advancement of Behavioral Economics (SABE)

Union for Radical Political Economics (URPE)

AM I MISSING ANY?

Credits and Thanks

The program chair for this conference is **James Poterba**. Other session organizers and those listed as the program committee, did much of the work. A very heartfelt and most special thanks, however, must be made to the Conference Organizing Committee, who are a group of talented and dedicated scholars who gave up their time to help organize this conference. Without their help, this conference could never occur. Those individuals are:

Ari Belasen, Southern Illinois University- Edwardsville

Juan Cabrera, Ramapo College of New Jersey

Georg Cerf, TBA

Tiffani Gottschall, Washington & Jefferson College

Julio Huato, St. Francis College

Mark LeClair, Fairfield University

Mary Lesser, Lenoir-Rhyne University, Professor Emeritus Iona College, and Former Executive Director of the EEA

Steven Pressman, Monmouth University

Robert H. Scott III, Monmouth University

Natalia V. Smirnova, The College of Mount Saint Vincent

Yongsheng Wang, Washington & Jefferson College

Mark D. White, CUNY- College of Staten Island

The content for this guide and its online version was produced at the Anisfield School of Business at Ramapo College of New Jersey. The Association thanks its Webmaster, **Robert Josic**, Ramapo College's Director of Online Communication, **Stephen Schur**, and its three student assistants, **Marty Cohen**, **Aisling Melillo**, and **Chrissie O'Neill**. We also offer our thanks to **Mark Finnegan** at Rye Printing, in Rye N.Y., for publishing this book. As some of you may notice, **Mary Lesser** continually reappears despite her attempt to retire from the EEA and we wish her well on her subsequent attempts to escape from this Association.

As a very special mention, I would like to thank Lindsey Olbrecht for marrying me and by default, the Eastern Economic Association. In closing, I hope you enjoy this conference and your time in Boston. If my staff and I can do anything to make your time at the EEA meetings more enjoyable, please let us know.

Alexandre Olbrecht

EEA Executive Director

38th Annual Meetings

Calendar of Events

Thursday, March 8, 2012

5:00 p.m. - 8:00 p.m. Registration.....
7:30 p.m. - 9:00 p.m. EEA Board Meeting (by invitation only)

Coffee Breaks on Friday and Saturday will be located in the Georgian Ballroom.

Friday, March 9, 2012

7:30 a.m. - 5 p.m. Registration.....
8:30 a.m. - 9:45 a.m. Sessions A1-A19.....(see listings for rooms)
9:00 a.m. - 5:00 p.m. Exhibits.....
10:15 a.m. - 11:45 a.m. Sessions B1-B19.....(see listings for rooms)
1:00 p.m. - 2:15 p.m. Sessions C1-C19.....(see listings for rooms)
2:30 p.m. - 3:45 p.m. Sessions D1-D19.....(see listings for rooms)
4:00 p.m. - 5:15 p.m. Sessions E1-E19.....(see listings for rooms)

5:30 p.m. - 6:30 p.m. Presidential Address by **Duncan Foley**

Talk entitled: "The Dilemmas of Economic Growth"

Presidential Reception to Follow.....TBA

All conference participants are invited to attend this reception to meet other participants and the Association's officers. Cash bar and complimentary snacks. Musical performances with economic themes:

Rhetoric, Choice Theory and Performance.....TBA

***Andreas Duus Pape**, SUNY Binghamton, voice and harmonica; **Martin Heitzelman**, Clarkson University, keys*

Moderated discussion "Music in Economics Conferences," and informal jam to follow. Economists/musicians, come, play, and discuss the future of musical performance.

Saturday, March 10, 2012

7:30 a.m. - 5 p.m. Registration.....
8:15 a.m. - 9:30 a.m. Sessions F1-F19.....(see listings for rooms)
9:00 a.m. - 5:00 p.m. Exhibits.....
9:45 a.m. – 11:00 a.m. Sessions G1-G19.....(see listings for rooms)

11:30 p.m. – 12:45 p.m. Luncheon and Address.....
James Poterba, EEA Vice-President
Title: “Federal Tax Reform: Prospects and Possibilities”

1:00 p.m. - 2:15 p.m. Sessions H1-H19.....(see listings for rooms)
2:30 p.m. - 3:45 p.m. Sessions I1-I19.....(see listings for rooms)

4:00 p.m. – 5:15 p.m. Sessions J1-J19.....(see listings for rooms)

5:30 p.m. – 6:45 p.m. Main Lecture by **Peter Diamond**, 2010 Nobel Laureate

Talk entitled: “Markets with Search Frictions”

Reception to Follow.....TBA

All conference participants are invited to attend this reception to meet other participants and the Association’s officers. Cash bar and complimentary snacks.

7:30 p.m. URPE Reception.....TBA

Sunday, March 11, 2012

7:30 a.m.- 9:30 a.m. Registration.....
8:15 a.m.- 9:30 a.m. Sessions K1-K19.....(see listings for rooms)
9:45 a.m.- 11:15 a.m. Sessions L1-N19.....(see listings for rooms)
11:30 a.m.- 12:45 p.m. Sessions M1-O19.....(see listings for rooms)

Floor Plans, Boston Park Plaza

Mezzanine Level Second Floor

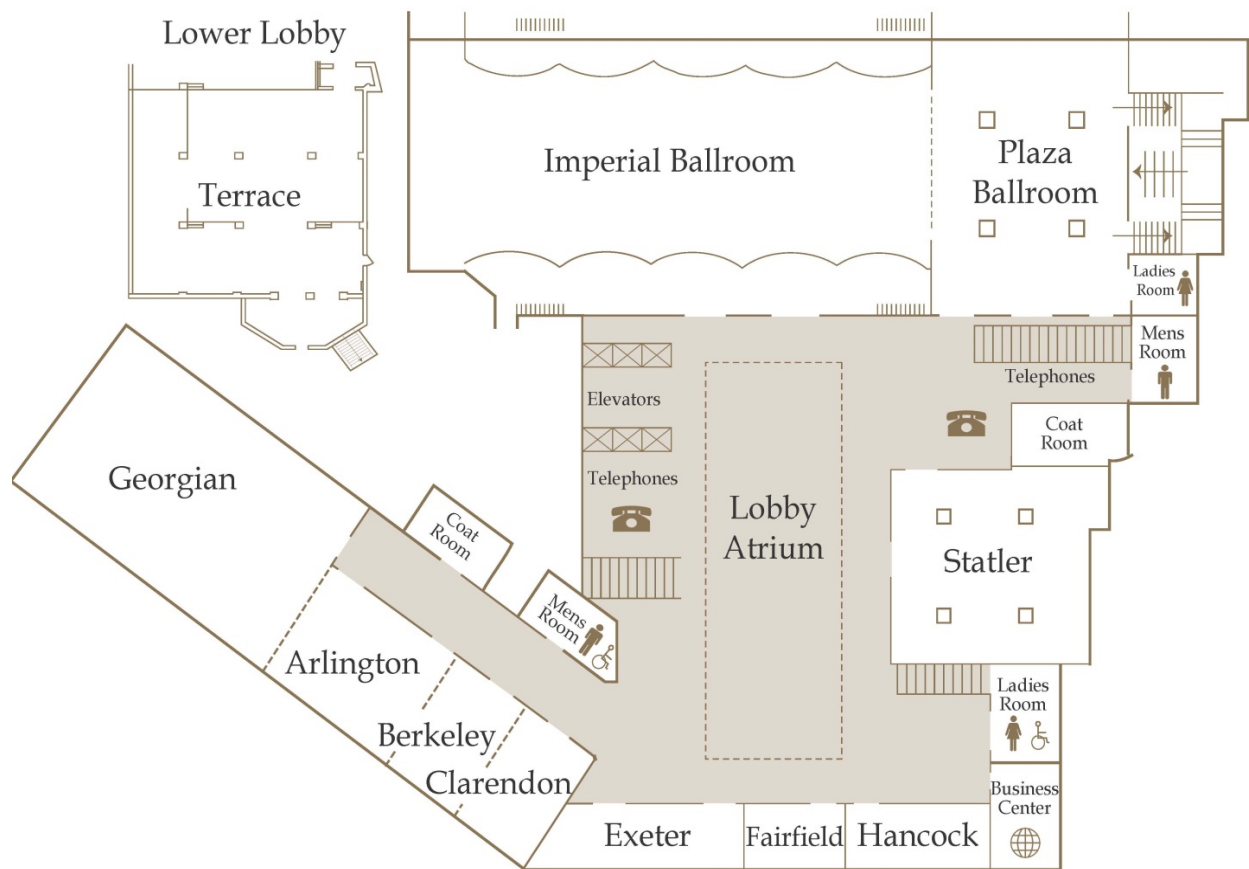

Ladies Room



Telephones



Men's Room



Business Center

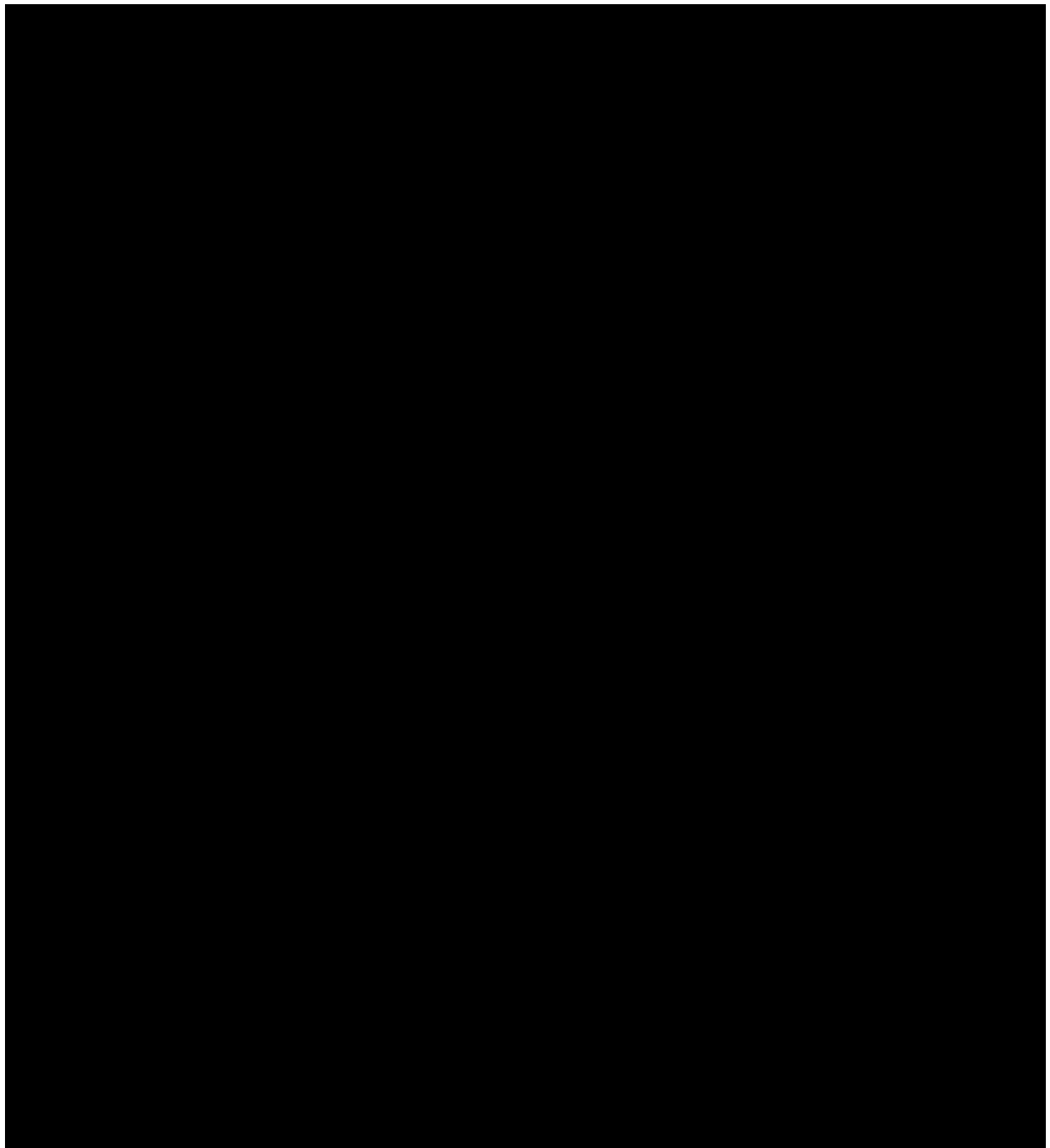

ETIQUETTE AND ABSENTEEISM

The listings in this Program were the most accurate available when we went to press. The addendum sheet provided contains most of the changes that occurred thereafter. Some persons who are on the program, in spite of their best intentions and efforts, may not be able to make it to the Conference or make it in time for their session(s). If the Chair of a session does not arrive, the discussant or presenter of the first paper should assume the responsibility of the Chair.

Each session runs for the specified time period measured in minutes. Normally authors get equal time each to summarize their papers and the discussants get up to 5 minutes each to make their comments. It is the responsibility of the session chair to see that each participant receives the allotted time. It is most important that the first presenter holds to the time constraint for the sake of later presenters.

USER'S GUIDE

How to find your session(s) in this program:

1. Please turn to the index near the end of the booklet.
2. Find your name in the alphabetical listing.
3. Note the session number(s) after your name.
4. Look up the session(s) by number to find days, times, and room locations.

Note: The NA-BIG schedule can be found after the session listing section. The names of NA-BIG participants will be noted in the index as "NA-BIG". All NA-BIG sessions will take place in Liberty 5.

SESSIONS LISTED BY SPONSORING ORGANIZATIONS

African Finance and Economics Association (AFEA)-

Association for Social Economics (ASE)-

Committee on the Status of Women in the Economics Profession (CSWEP)-

European Union- European Monetary Union (EU-EMU) Working Group-

Issues in Political Economy (IPE)-

National Association of Forensic Economics (NAFE)-

New Direction in Political Economy (NDIPE)-

North American Association for Sports Economics

NYC Computational Economics & Complexity Workshop-

Society for the Advancement of Behavioral Economics (SABE)-

Union for Radical Political Economics (URPE)-

Sessions Listed By JEL Code
(Note: Some Sessions are listed under more than one category.)

A. General Economics and Teaching

B. Methodology and History of Economic Thought

C. Mathematical and Quantitative Methods

D. Microeconomics

E. Macroeconomics and Monetary Economics

F. International Economics

G. Financial Economics

H. Public Economics

I. Health, Education, and Welfare

J. Labor and Demographic Economics

K. Law and Economics

L. Industrial Organization

M. Business Economics

N. Economic History

O. Economic Development, Technological Change, and Growth

P. Economic Systems

Q. Agricultural and Natural Resource Economics (includes Environment)

R. Urban, Rural, and Regional Economics (includes Transportation)

Y. Miscellaneous Categories

Z. Other Special Topics (Cultural Economics, Philanthropy)

<Constitution>

<Friday, March 9 8:30-9:45 a.m.>

[A1] INTERNATIONAL FINANCIAL ISSUES I (JEL Code F)

Session Organizer & Chair: **Theologos Homer Bonitsis**, New Jersey Institute of Technology

Financial Crisis and Country Risk: The Greek Case

Eleftherios Thalassinos and Vicky Zampera, University of Piraeus

Domestic Inflation and International Oil Price in a Two-Sector Small Open Economy

Mohammed Mohsin, University of Tennessee; **Kihyun Park**, Korea Energy Economics Institute

The Single European Financial Market and its Uncertain Future

John N. Kallianiotis and Kevin McLaughlin, University of Scranton

<Gloucester>

<Friday, March 9 8:30-9:45 a.m.>

[A2] CAPITAL CONTROLS, MACROPRUDENTIAL POLICIES, AND FINANCIAL STABILITY: A PANEL DISCUSSION

Session Organizers: **Ilene Grabel**, University of Denver; **Kevin Gallagher**, Boston University

Session Chair & Discussant: **Rawi Abdelal**, Harvard Business School

A macroprudential framework for financial stability: The theory and the Latin American experience

José Antonio Ocampo, Columbia University

Managing Capital Inflows in Developing Countries

Kevin Gallagher, Boston University

The resurrection of capital controls in an age of crisis

Ilene Grabel, University of Denver

Discussion amongst participants

<Winthrop>

<Friday, March 9 8:30-9:45 a.m.>

[A3] CORPORATE GOVERNANCE AND COMPANY PERFORMANCE

Session Organizer: **Elena Smirnova**, SUNY Old Westbury

Session Chair: **Alvin Mickens**, SUNY Old Westbury

Do Institutional Investors Herd? A Markov-Switching Approach

Aram Balagozyan, University of Scranton; **Esin Cakan**, University of New Haven

Pro Forma Projection of Rate of Return on Stocks

Rod C. Tabriztchi, JD, MBA, CPA; **Sirousse Tabriztchi**, SUNY Old Westbury

Greening of Corporate Governance: Wealth Effects of Sustainability Officers Hiring

Dr. Waqar Ghani, Saint Joseph's University; **Rajneesh Sharma**, Saint Joseph's University;

A.J. Stagliano, Saint Joseph's University

Agency Costs of Family Firms: Executive Compensation, Valuation and Performance

Elena Smirnova, SUNY Old Westbury; **Sirousse Tabriztchi**, SUNY Old Westbury

Discussants: **Rajneesh Sharma**, Saint Joseph's University; **Aram Balagozyan**, University of

Scranton; **Sirousse Tabriztchi**, SUNY Old Westbury; **Esin Cakan**, University of New Haven

<Thoreau>

<Friday, March 9 8:30-9:45 a.m.>

[A4] SPECIAL INTERESTS, LOBBYING, INTER-STATE COMPETITION, AND PUBLIC POLICY MAKING

Session Chair: **Yoav Wachsman**, Coastal Carolina University

A Model of Cournot Competition with Lobbying

Yoav Wachsman, Coastal Carolina University

A Model of Tradeable Capital Tax Permits

Timothy Hubbard, Texas Tech University; **Justin Svec**, College of the Holy Cross

Loss of Control: Apportionment Changes and the State-Local Relationship

Jessica Hennessey, Furman University

Cash-for-Clunkers or Cash-for-SUVs? The Effects of 2009 Cash-for-Clunker Program

Yizao Liu, University of Connecticut

Discussants: **Emina Cardamone**, Ursinus College; **Shantanu Bagchi**, Georgia Southern University

<Stuart>

<Friday, March 9 8:30-9:45 a.m.>

[A5] CHILD CARE AND MATERNITY LEAVE

Session Chair: **Daniel Perez-Lopez**, US Census Bureau

Job Categories and Returning to Work on Breastfeeding Behavior

Lori Anderson, Framingham State University

Health Insurance Related Job-lock and Maternity Leave

Joshua Congdon-Hohman, The College of the Holy Cross

Determinants of Child Care Choice-The Role of Mother's Work and Family Characteristics:
Findings from the SIPP 2004 and 2008 panels

Daniel Perez-Lopez, US Census Bureau

Discussants: **Daniel Perez-Lopez**, US Census Bureau; **Lori Anderson**, Framingham State University; **Joshua Congdon-Hohman**, The College of the Holy Cross

<Franklin>

<Friday, March 9 8:30-9:45 a.m.>

[A6] CONSUMPTION

Session Chair: **Dmitriy Krichevskiy**, Elizabethtown College

Giving Through Buying

Mark LeClair, Fairfield University

A consumption-based measure of the monetary rewards to entrepreneurship

Dmitriy Krichevskiy, Elizabethtown College

Consumer Loyalty Creation, Search Frictions and Entry Deterrence

Ruth Gilgenbach, Southern Methodist University

Estimating Demand with Brand Choice and Quantity Adjustment:from Non-organic to Organic Food

Catherine Oh, Penn State University; **Edward C. Jaenicke**, Department of Agric. Econ. & Rural Sociology

<White Hill>

<Friday, March 9 8:30-9:45 a.m.>

[A7] LINKS BETWEEN RICHER NATIONS AND LESSER DEVELOPED COUNTRIES

Session Chair: **Scott Bradford**, Brigham Young University

The Global Welfare and Poverty Effects of Rich Nation Migration Barriers
Scott Bradford, Brigham Young University

Socio-Economic Characteristics and Remittance Behavior of Indian and Chinese Immigrants:
Evidence from Canadian Microdata
Murshed Chowdhury, University of Manitoba

<Whittier>

<Friday, March 9 8:30-9:45 a.m.>

**[A8] ISSUES OF ECONOMIC DEVELOPMENT: INVESTMENT, GROWTH,
POVERTY**

**The First of Eighteen Sessions Sponsored by the Union for Radical Political Economics
(URPE)**

Session Organizers: **Armagan Gezici** and **Scott Carter**

Session Chair: **Armagan Gezici**, Keene State College

Investment, assets markets, and the relative unit labor cost in Mexico
Carlos A. Ibarra, Universidad de las Américas Puebla Cholula

The laboring precariat: The case of informal manufacturing workforce in India
Lopamudra Banerjee, New School for Social Research; **Snehashish Bhattacharya**, South
Asian University

The Determinants of Selection into Non-agricultural Self-employment in Ghana
James Heintz, University of Massachusetts, Amherst; **Lynda Pickbourn**, Keene State College

Eighteenth Century Spanish California as a Developing Economy: Was Investment in Religion a
Drag on Growth?
Marie Duggan, Keene State College

Discussants: **Armagan Gezici**, Keene State College; **Ajit Zacharias**, Levy Economics Institute
of Bard College; **Soon Ryoo**, Adelphi University

<Charles River>

<Friday, March 9 8:30-9:45 a.m.>

[A9] LOCAL ECONOMIC DEVELOPMENT FACTORS (JEL Code R)

Session Chair : **Lei Zhang**, Edinboro University of Pennsylvania

Human Capital Use, Negative Externalities in Innovation, and Regional Economic Growth

Amitrajeet Batabyal, Rochester Institute of Technology; **Peter Nijkamp**, Free University of Amsterdam

The Impacts of Entrepreneurship: Using An IV To Determine the Impacts On Growth and Market Characteristics

Matt Saboe, Lehigh University

Discussants: **Lei Zhang**, Edinboro University of Pennsylvania; **Amitrajeet Batabyal**, Rochester Institute of Technology

<Emerson>

<Friday, March 9 8:30-9:45 a.m.>

[A10] AGRICULTURE AND SUSTAINABLE DEVELOPMENT

Session Chair: **Kidaya Ntoko**, Queens College

Agricultural Policy and Rural Development: The case for DRC, Ghana and Ivory Coast

Kidaya Ntoko, Queens College

Lessons in Sustainable Development for China and Taiwan

Sara Hsu, SUNY New Paltz; **Meredith Henshaw**, SUNY New Paltz

Sustainable Agriculture and Economic Development: The Case of Romania

Raluca Iorgulescu, National Institute of Economic Research; **John Polimeni**, Albany College of Pharmacy

Discussants: **Kidaya Ntoko**, Queens College; **John Polimeni**, Albany College of Pharmacy;

Risa Kumazawa, Duquesne University

<Saint James>

<Friday, March 9 8:30-9:45 a.m.>

[A11] TECHNOLOGY AND INFRASTRUCTURE

Session Chair: **Carol McDonough**, University of Massachusetts Lowell

The Economics of the Relationship Between Fixed and Mobile Broadband: Present and Future

Carol McDonough, University of Massachusetts Lowell

Flicking the Switch: Retail Demand-Side Response under Alternative Electricity Pricing Contracts

Rimvydas Baltaduonis, Gettysburg College

The impact of technological change on obesity: Evidence from China's "home appliances going to the countryside" policy

Cheng Chen, Lehigh University; **Shin-Yi Chou**, Lehigh University

Discussion amongst participants

<Stanhope>

<Friday, March 9 8:30-9:45 a.m.>

[A14] TRADE AND FACTOR MOBILIZATION IN THE EU (JEL Code F)

Session Chair: **Joseph Goldman**, Austin College

On The Move: An Evaluation of the Migration Decision in the European Context

Joseph Goldman, Austin College

Club Convergence in the EU: An Empirical Analysis of Motor Fuel Prices and Taxes

Aliya Sassi, UNH

The Effects of the EU Trade Policy on the Welfare of Turkey

Mesut Eren, Istanbul Kultur University

Discussion amongst participants

<Longfellow>

<Friday, March 9 8:30-9:45 a.m.>

[A15] HUMAN CAPITAL, WORK EFFORT AND ECONOMIC GROWTH (JEL Code O)

Consequences of interactions between resident and nonresident kin: Evidence from human capital accumulation during the 1997-8 Indonesian financial crisis

Paul Karner, Boston University

A Macrodynamics of Profit Sharing and Economic Growth with an Evolutionary Microdynamics

Gilberto Tadeu Lima, University of São Paulo

Population Density, Human Capital and Productivity

Juan-Pedro Garces-Voisnat, Wake Forest University

Discussion amongst participants

<Copley>

<Friday, March 9 8:30-9:45 a.m.>

[A16] TOPICS IN TEACHING ECONOMICS (JEL Code A)

Teaching Structure Requires Markets

Ellen Sewell, University of North Carolina at Charlotte

Bringing Economics Texts to Life

Monica Galizzi, University of Massachusetts Lowell

The Class Size Gap and Technology: Is Help a Click Away?

Chiara Gratton-Lavoie, California State University, Fullerton; **Denise Stanley**, California State University, Fullerton

A Simple Model of Entrepreneurship for Principles of Economics Courses

Frank Gunter, Lehigh University

Discussion amongst participants

<Holmes>

<Friday, March 9 8:30-9:45 a.m.>

[A17] BANKING MANAGEMENT I (JEL Code G)

Session Chair: **Viktoria Dalko**, Harvard University & Holt IBS

The Effectiveness of Bank Recapitalization Policies: Evidence from the United States

Heather Montgomery, International Christian University

Measuring Efficiency Using A Composite Non Standard Profit Function Approach: The Case of U.S. Commercial Banks

Diego Restrepo-Tobon, Binghamton University

Discussants: **Milos Vulanovic**, Western New England University; **Mine Aysen Doyran**, Lehman College

<Cabot>

<Friday, March 9 8:30-9:45 a.m.>

[A18] LABOR MARKETS AND ECONOMIC PERFORMANCE (JEL Code E)

Session Chair: **Weifeng Wu**, Johns Hopkins University

The Natural Rate of Unemployment: A State-Level Dynamic Analysis

Bryce Kanago, University of Northern Iowa

Public Investment and Unemployment in the OECD

Robert Derrell, Manhattanville College

Profit, Production and Paradigm

David Axelrod, Falcon Management

Jobless Recoveries: Employment Benefit Cost and Financial Frictions

Weishi (Grace) Gu, Cornell University

Discussants: **Katerina Koka**, Brock University; **Tsun-Feng Chiang**, North Carolina State University; **Weifeng Wu**, Johns Hopkins University

<Cambridge>

<Friday, March 9 8:30-9:45 a.m.>

[A19] ECONOMIC GROWTH

Session Chair: **Kathryn Parr**, University of Connecticut

Economic Growth and the Nutrition Transition

Kathryn Parr, University of Connecticut

Threshold Effects of House Prices and Economic Growth on Bank Instability

Chun Wang, Brooklyn College, CUNY

<Constitution>

<Friday, March 9 10:15-11:45 a.m.>

[B1] INTERNATIONAL FINANCIAL ISSUES II (JEL Codes F, G)

Session Organizer & Chair: **Theologos Homer Bonitsis**, New Jersey Institute of Technology

Causality Relation between Net Assets and Performances of Pension Funds in Romania

Mirela Cristea, University of Craiova; **Eleftherios Thalassinou**, University of Piraeus

The Impact of World Population Aging on International Financial Flows and Health Care Financing

Constantine Haralambos Grivoyannis, Connell University

Dollarization in El Salvador: Revisited

Luis Eduardo Rivera-Solis, Dowling College

<Gloucester>

<Friday, March 9 10:15-11:45 a.m.>

[B2] FIRM ENTRY IN COMPETITIVE MARKETS AND TRADE

Session Organizer and Chair: **Zadia M. Feliciano**, Queens College, CUNY Graduate Center and NBER

Trade in Parts and Components: Exporter Substitution in the Third Market
Iwao Tanaka, Toyo Gakuen University

The Costs and Benefits of Competition in the Telephone Industry
David Gabel, Queens College and CUNY Graduate Center

Foreign Entry into U.S. Service Sector Firms by Takeovers and the Creation of New Firms
Zadia M. Feliciano, Queens College, CUNY Graduate Center and NBER

Globalization and the Environmental Spillovers of sectoral FDI
Nadia Doytch, University of New Haven; **Merih Uctum**, CUNY Graduate Center and Brooklyn College

Discussants: **Zadia M. Feliciano**, Queens College; **Iwao Tanaka**, Toyo Gakuen University; **David Gabel**, Queens College; **Nadia Doytch**, University of New Haven

<Winthrop>

<Friday, March 9 10:15-11:45 a.m.>

[B3] INTERNATIONAL FINANCIAL CRISIS AND MARKET VOLATILITY

Session Organizer and Chair: **Hossein S. Kazemi**, Stonehill College

Uncertainty and Gross Private Fixed Investment: Lessons from the last decade
Anthony J. Laramie, Merrimack College; **Hossein S. Kazemi**, Stonehill College

Monetary Policy Transmission in the Eurozone
Ayla Ogus Binatli, Izmir University of Economics; **Niloufer Sohrabji**, Simmons College

Volatility, Liquidity, Information Asymmetry and Short Sale Constraints
Jinghan Cai, Boston College; **Chiu Yu Ko**, Boston College; **Yuming Li**, California State University; **Le Xia**, Banco Bilbao Vizcaya Argentaria

Discussants: **Jinghan Cai**, Boston College; **Chiu Yu Ko**, Boston College; **Niloufer Sohrabji**, Simmons College

<Thoreau>

<Friday, March 9 10:15-11:45 a.m.>

[B4] ISSUES IN INTERNATIONAL ECONOMIC DEVELOPMENT AND FINANCIAL MARKETS

Session Chair: **Jonathan Ohn**, Bloomsburg University of Pennsylvania

Macroeconometric Study of Ukraine's Growth and Reform

Lawrence R. Klein, University of Pennsylvania; **Fyodor I. Kushnirsky**, Temple University;
Svitlana Maksymenko, University of Pittsburgh

IPO (Dis)incentives: Evidence from Large Russian Banks

Lucy Chernykh, Bowling Green State University; **Victoria Geyfman**, Bloomsburg University of Pennsylvania

Population Change, Financial Crisis, and Stock Markets Performance in US

Jonathan Ohn, Bloomsburg University of Pennsylvania; **Larry Taylor**, Lehigh University

Discussants: **Victoria Geyfman**, Bloomsburg University of Pennsylvania; **Jonathan Ohn**, Bloomsburg University of Pennsylvania; **Svitlana Maksymenko**, University of Pittsburgh

<Stuart>

<Friday, March 9 10:15-11:45 a.m.>

[B5] THE SOCIAL ECONOMICS OF WELL-BEING

The First of Four sessions sponsored by the Association for Social Economics (ASE)

Session Chair and organizer: **Mark D. White**, College of Staten Island

Religions, Religiosity and Subjective Wellbeing in Canada

Maryam Dilmaghani and Jordan Mahar, Saint Mary's University

Happy for How Long? Social Capital, GDP and Well-Being over Time

Stefano Bartolini, University of Siena, CEPS/INSTEAD, Luxembourg; **Francesco Sarracino**, CEPS/INSTEAD Luxembourg

The Distributional Effects of the Great Recession and Its Aftermath

Martha Starr, American University

Discussion amongst participants

<Franklin>

<Friday, March 9 10:15-11:45 a.m.>

[B6] ECONOMICS OF CRIME

Session Chair: **Hannes Lang**

Hate Source: White Supremacist Hate Groups and Hate Crime
Sean Mulholland, Stonehill College

Immigration and Crime: Evidence from Los Angeles Administrative Law Enforcement Data and Neighborhood Characteristics
Anita Pena, Colorado State University; **Gregory DeAngelo**, Rensselaer

Effect of California's Three-Strikes Legislation: Deterrence versus Incapacitation
Anusua Datta, Philadelphia University

Discussants: **Sean Mulholland**, Stonehill College; **Anita Pena**, Colorado State University;
Anusua Datta, Philadelphia University

<White Hill>

<Friday, March 9 10:15-11:45 a.m.>

[B7] AGRARIAN STRUCTURES AND CHANGE

The Fourteenth of Eighteen Sessions sponsored by the Union for Radical Political Economics (URPE)

Session Organizer: **Cem Oyvat**, University of Massachusetts Amherst

Session chair: **Cem Oyvat**, University of Massachusetts Amherst

The Inverse Relationship between Land Size and Productivity and the Household as a collective: the case of Kenya

Mwangi wa Githinji, University of Massachusetts Amherst; **Charalampos Konstantinidis**, University of Massachusetts Amherst; **Andy Barenberg**, University of Massachusetts Amherst

Agrarian Structures, Urbanization and Inequality
Cem Oyvat, University of Massachusetts Amherst

Rural Finance in China: A Comparison before and after the Economic Reform
Ying Chen, University of Massachusetts Amherst

Discussion amongst participants

<Whittier>

<Friday, March 9 10:15-11:45 a.m.>

[B8] IDEOLOGICAL AND FINANCIAL UNDERPINNINGS OF THE GREAT RECESSION

The Second of Eighteen Sessions Sponsored by the Union for Radical Political Economics (URPE)

Session Organizers: **Armagan Gezici** and **Scott Carter**

Session Chair: **Ted P. Schmidt**, SUNY Buffalo State College

The Inequality, Power, Ideology Nexus: Getting to the Roots of the Crisis

John A. Miller, Wheaton College

Financial Underpinnings of the European Crisis

Nina Eichacker, University of Massachusetts, Amherst

QE through the prism of the Barings Crisis in 1890: Central Banks and the International money Markets

Ramaa Vasudevan, Colorado State University

Financialization of Commodities and the Monetary Transmission Mechanism

Ted P. Schmidt, SUNY Buffalo State College

Discussants: **Thomas Masterson**, Levy Economics Institute of Bard College; **Marie Duggan**, Keene State College; **Mona Ali**, SUNY New Paltz

<Charles River>

<Friday, March 9 10:15-11:45 a.m.>

[B9] MIGRATION AND MOBILITY (JEL Code J)

Session Chair: **Nicholas Jolly**, Central Michigan University

Population Economics- A Historical Review

Marcel Fulop, Kean University

The Impact of Work-Limiting Disabilities on the Inter-temporal Movement of Workers through the Earnings and Income Distributions

Nicholas Jolly, Central Michigan University

[https://editorialexpress.com/cgi-](https://editorialexpress.com/cgi-bin/conference/conference.cgi?action=paper&subaction=info&info3=88)

[bin/conference/conference.cgi?action=paper&subaction=info&info3=88](https://editorialexpress.com/cgi-bin/conference/conference.cgi?action=paper&subaction=info&info3=88)INTERNAL MIGRATION OF COLLEGE GRADUATES: out-of-state versus in-state students and foreign-born versus U.S. born students

Ritu Sapra, Rutgers University

[https://editorialexpress.com/cgi-](https://editorialexpress.com/cgi-bin/conference/conference.cgi?action=paper&subaction=info&info3=185)

[bin/conference/conference.cgi?action=paper&subaction=info&info3=185](https://editorialexpress.com/cgi-bin/conference/conference.cgi?action=paper&subaction=info&info3=185)Is Job Stability at the Outset of One's Career Good for Its Continuation?

Aviad Tur-Sinai, Israel Central Bureau of Statistics and Ben-Gurion University of the Negev;
Dmitri Romanov, Central Bureau of Statistics

Discussion amongst participants

<Emerson>

<Friday, March 9 10:15-11:45 a.m.>

[B10] CAPITAL FLOWS, TRADE, EXCHANGE RATE REGIMES AND ECONOMIC PERFORMANCE IN AFRICAN ECONOMIES

The First of Three Sessions sponsored by the African Finance and Economics Association (AFEA)

Session Organizer and Chair: **Mina Balamoune-Lutz**, University of North Florida

On Remittances and Economic Growth in Sub-Saharan Africa: Impacts of Human Capital
William Amponsah, Georgia Southern University; **Pablo Garcia-Fuentes**, Southeastern Louisiana University

Exchange Rate Regime and Economic Performance: CFA Franc Zone versus Non-CFA Sub-Saharan African Countries
Julie Lohi, West Virginia University

The Environmental Effects of Trade: Do Institutions Matter?
Mina Balamoune-Lutz, University of North Florida

<Saint James>

<Friday, March 9 10:15-11:45 a.m.>

[B11] MICRO THEORY

Session Chair: **Marc Gurtler**, University of Braunschweig, Institute of Technology

Bayesian Persuasion with Multiple Receivers
Yun Wang, University of Pittsburgh

Inequality Aversion and Externalities
Marc Gurtler, University of Braunschweig, Institute of Technology; **Oliver Guertler**, University of Cologne

Godlike Compensation Rationally Linked to Godlike Personal Liabilities through SKAT, the Stages of Knowledge Ahead Theory of Risk
Robin Pope, University of Bonn

Assortative Matching of Risk Averse Agents with Endogenous Risk
Sanxi LI, Toulouse School of Economics

Discussion amongst participants

<Stanhope>

<Friday, March 9 10:15-11:45 a.m.>

[B14] ECONOMIC AND FINANCIAL CRISIS (JEL Code F)

Session Chair: **Kazimierz Dadak**, Hollins University

The Principles of Solidarity and Subsidiarity and the Current Crisis in the European Union
Kazimierz Dadak, Hollins University

Eurozone crisis and policy responses
Augustin Mbemba, University of Richmond

Is the Recent Financial crisis A Prelude to a “New economic order?”
Arav Ouandlous, Savannah State University; **John Barkoulas**, Georgia Southern University

Discussion amongst participants

<Longfellow>

<Friday, March 9 10:15-11:45 a.m.>

[B15] MACROECONOMIC POLICY SPACE (JEL Code E)

Session organizers: **Esteban Pérez Caldentey**, ECLAC, Chile; **Matías Vernengo**, University of Utah

Session Chair: **Nathan Perry**

Quantitative Easing and Long Term Interest Rates During the Great Depression
Steve Bannister, University of Utah; **Matías Vernengo**, University of Utah

The Pattern of Debt in Developing Economies: Higher Commerce of Financial Instruments without Financial Crisis
Noemí Levy, UNAM, México

The simple Post Keynesian Monetary Policy Model: An Open Economy Approach
Leonardo Vera, Universidad Central de Venezuela

Discussion among participants

<Copley>

<Friday, March 9 10:15-11:45 a.m.>

[B16] TOPICS IN BUSINESS ECONOMICS (JEL Code M)

Horizontal Ownership and Brand Affiliation in Service Industries: Evidence from Nursing Homes

Susan Lu, Simon School of Business

To Err is Human to Forgive Divine...Should the Credit Rating Agencies Be Held Responsible for the Chaos They Have Caused the United States Economy: A Study of Rate of Reliability

Constance Crawford, Ramapo College of New Jersey; **Corinne L. Crawford**, Borough of Manhattan Community College

The Feasibility of Martian Colonization: An Input-Output Analysis

Sean Piatek, Buffalo State College; **Victor Kasper**, Buffalo State College

Discussion amongst participants

<Holmes>

<Friday, March 9 10:15-11:45 a.m.>

[B17] BANKING MANAGEMENT II (JEL Code G)

Session Chair: **Heather Montgomery**, International Christian University

What Do Equity Markets Tell Us about the Drivers of Bank Default Risk? Evidence from Emerging Markets

Dominik Maltritz, TU Dresden; **Alexander Karmann**, TU Dresden; **Stefan Eichler**, TU Dresden; **Karol Sobanski**, TU Dresden

The Impact of Market Structures on Financial Institution Performance

Mine Aysen Doyran, Lehman College

Discussants: **Doruk Ilgaz**, University of Houston; **Scott Deacle**, Ursinus College

<Cabot>

<Friday, March 9 10:15-11:45 a.m.>

[B18] FINANCIAL ANALYSIS AND PERFORMANCE (JEL Code E)

Session Chair: **David Axelrod**, Falcon Management

Income, Return Risks and Portfolio Choice: An Example of Korea

Tsun-Feng Chiang, North Carolina State University

Asset Allocation and Risk Aversion

Suvayan De, West Virginia State University

High and Rising Chinese Saving: It's Still a Puzzle

Weifeng Wu, Johns Hopkins University

Discussants: **Burak Uras**, Tilburg University; **Paul Orzechowski**, Monmouth University; **Biru Paul**, SUNY Cortland

<Cambridge>

<Friday, March 9 10:15-11:45 a.m.>

[B19] PECULIAR FINANCIAL MARKETS

The Impact of Foreign Exchange Reserve Accumulation on China's Monetary Policy: Some Empirical Evidence

Christopher Tong, Westminster College; **Xin Wang**, Westminster College

Commodity derivatives and exchange rate dynamics in emerging markets: some relevant problems of macro stability

Aleksandr V. Gevorkyan, New York University and St. John's University; **Arkady Gevorkyan**, The New School

Options and Monetary Value

Timothy Kearney, Misericordia University

U.S.' Gross Capital flow and Financilization in the 2000's

Junji Tokunaga, University of Massachusetts Amherst

Discussion amongst participants

<Constitution>

<Friday, March 9 1:00-2:15 p.m.>

[C1] ISSUES IN ECONOMIC EDUCATION

Session Organizer & Chair: **Janice Yee**, Worcester State University

Assessment for Principles of Economics Classes: Face-to-Face vs. Online

Van Pham, Salem State University

Financial Literacy and the College Experience

Christina Foley, Clark University; **Jessica LaVoice**, Worcester State University

Student Perceptions of Market Fairness

Elizabeth Wark and Janice Yee, Worcester State University

Discussants: **Elizabeth Wark**, Worcester State University; **Arthur Schiller Casimir**, Western New England University; **Bonnie Orcutt**, Worcester State University

<Gloucester>

<Friday, March 9 1:00-2:15 p.m>

[C2] SOUTH-SOUTH ECONOMIC INTEGRATION AND DEVELOPMENT – SESSION 1

Session Organizers: **Omar S. Dahi**, Hampshire College; **Firat Demir**, University of Oklahoma

Session Chair: **Firat Demir**, University of Oklahoma

South-South Issues from a South-North Framework

Amitava K. Dutt, University of Notre Dame (adutt@nd.edu)

South-South Economic Relations: A Historical and Theoretical Approach

Omar S. Dahi, Hampshire College (odahi@hampshire.edu)

A Better Deal? A Comparative Analysis of Chinese Finance in Latin America

Kevin P. Gallagher, Boston University (kpg@bu.edu)

China and Latin America: A Model (with Some Empirical Evidence) of Trade between an Industrializing South and a Deindustrializing South

Jaime Ros, Universidad Nacional Autónoma de México (UNAM) (ros@nd.edu)

Discussants: **Jaime Ros**, Universidad Nacional Autónoma de México; **Firat Demir**, University of Oklahoma; **Amitava K. Dutt**, University of Notre Dame; **Arslan Razmi**, Umass-Amherst

<Winthrop>

<Friday, March 9 1:00-2:15 p.m>

[C3] SPORTS ECONOMICS I

The First of Three sessions sponsored by the North America Association for Sports Economics (NAASE)

Session Chair: **Sean E. Mulholland**, Stonehill College

Entry discrimination in the NHL: Evolution and the KHL effect

Tom Christie, University of Ottawa; **Marc Lavoie***, University of Ottawa

Match Competitive Balance in Tennis: Evidence from the Sony Ericsson Open

Darius J. Conger*, Ithaca College; **Ryan E. Cruz**, Ithaca College

Comparing Superstars Across the Years: Babe Ruth is Homerun King

Peter A. Groothuis, Appalachian State University; **Kurt W. Rotthoff***, Seton Hall University

Discussants: **Sean E. Mulholland**, Stonehill College; **Thomas H. Bruggink**, Lafayette College;

Victor Matheson, College of the Holy Cross

<Thoreau>

<Friday, March 9 1:00-2:15 p.m>

[C4] MODEL UNCERTAINTY AND HETEROGENEITY IN ECONOMIC GROWTH AND DEVELOPMENT

Session Chair and Organizer: **Chih Ming Tan**, Clark University

The Long-Term Effects of Childhood Malnutrition on Cognitive Development: The Case of Famine in Ghana

Samuel Kofi Ampaabeng, Clark University; **Chih Ming Tan**, Clark University

Chutes and Ladders: Understanding the Interplay Between Preferences for Redistribution and Intergenerational Mobility

Christa Hutchinson, Clark University; **Chih Ming Tan**, Clark University

Hits and Runs: Determinants of the Cross-Country Variation in the Severity of Impact from the 2008-9 Financial Crisis

Shane Dwyer, Clark University; **Chih Ming Tan**, Clark University

Discussants: **Chih Ming Tan**, Clark University; **Samuel Kofi Ampaabeng**, Clark University;

Shane Dwyer, Clark University; **Christa Hutchinson**, Clark University

<Stuart>

<Friday, March 9 1:00-2:15 p.m>

[C5] GROWTH, SUSTAINABILITY, AND SOCIAL CAPITAL

The Second of Four Sessions sponsored by the Association for Social Economics (ASE)

Session Organizer: **Mark D. White**, College of Staten Island

Session Chair: **Michael Murray**, Bemidji State University

Can Capitalist Mode of Production be Biophysically Sustainable?

Josefina Y. Li, University of Missouri Kansas City

Economic Growth and Social Capital: Happily Together Ever After?

Francesco Sarracino, CEPS/INSTEAD, Luxembourg

The Ethics of Gender Equality in Africa
Eman Selim, Tanta University

Discussion amongst participants

<Franklin>

<Friday, March 9 1:00-2:15 p.m>

[C6] SEARCH AND SELECTION

Session Chair: **Ruth Gilgenbach**, Southern Methodist University

High School Extracurricular Participation and College Retention: A Factor Analysis
Neal Olitsky, University of Massachusetts Dartmouth

Costly Screening, Self Selection and the Existence of a Pooling Equilibrium in Credit Markets
Pingkang Yu, The George Washington University

Can a Decline in Search Cost Increase Prices?
Ruth Gilgenbach, Southern Methodist University

The Geography of US Employment Cycloes
Robert Jones, Skidmore College

<White Hill>

<Friday, March 9 1:00-2:15 p.m>

[C7] Writing Good Referee Reports and Improving Your Chances of Getting Published

Session Organizer and Chair: **Steven Pressman**, Monmouth University

Presenters:

Edward Gamber, Lafayette College and Co-Editor of the Eastern Economic Journal

Omar Hamouda, York University, and Editor of the Journal of Income Distribution

Steven Pressman, Monmouth University, Co-editor of the Review of Political Economy, and Associate Editor of the Eastern Economic Journal

Following brief presentations, the Editors will respond to questions from the audience.

<Whittier>

<Friday, March 9 1:00-2:15 p.m>

[C8] EXPLORATIONS IN ECONOMICS THEORY

The Second of Eighteen Sessions Sponsored by the Union for Radical Political Economics (URPE)

Session Organizers: **Armagan Gezici and Scott Carter**

Session Chair: **Mike Beggs**, Political Economy, University of Sydney

Liquidity as a Social Relation

Mike Beggs, University of Sydney

A Contribution to the Critique of Finance

Julio Huato, St. Francis College

Liquids that Balance: Hume's Gold and Smith's Capital Stock Arguments for Laissez Faire

Marie Duggan, Keene State College; **Nathan Gray**, Keene State College

Harmful Economic Systems and Standard Economics

Lane Vanderslice, World Hunger Education Service

Discussants: **Ramaa Vasudevan** , Colorado State University; **Fletcher Baragar**, University of Manitoba; **Lopamudra Banerjee**, New School for Social Research

<Charles River>

<Friday, March 9 1:00-2:15 p.m.>

[C9] GLOBALIZATION AND SUSTAINABLE DEVELOPMENT

Session Organizer and Chair: **Nadia Doytch**, University of New Haven

Land Market Liberalization, Transfer of Agricultural Technology, and the Process of Economic Development

George Vachadze, The College of Staten Island/CUNY

Globalization and Cross-Cultural Business Communication: An Anthropological Perspective

Tian Guang, Wang Hong, and Dai Qingqing, Shantou University

Beijing consensus or Beijing collusion: how to view China's foreign trade accomplishment?

Ling Zhang, Shantou University

Vulnerability to Poverty: Who are the Poor of the Future? A Multinomial Logit Analysis of Vulnerability and its Determinants

Kenn Garry L. Chua, Laurence Anthony L. Go

<Emerson>

<Friday, March 9 1:00-2:15 p.m.>

[C10] CHARITY AND PUBLIC ECONOMICS

Session Chair: **Susan Lu**, Simon School of Business

Does Donation Encourage Doing Good? Evidence from Nonprofit Nursing Homes

Susan Lu, Simon School of Business

Competing Projects in a Sequential Game of Charitable Giving

Emina Cardamone, Ursinus College

Crowding Out of Private Donations to Public Universities

Benjamin Compton, The University of Tennessee

Discussants: **Chrystol Thomas**, Central Bank of Barbados; **James Feigenbaum**, Utah State University

<Saint James>

<Friday, March 9 1:00-2:15 p.m.>

[C11] SPORTS

Session Chair: **Jennifer VanGilder**, Ursinus College

Is the Sports Media Colorblind

Jennifer VanGilder, Ursinus College

Race and Quarterback Survival in the National Football League

Brian Volz, Assumption College

Tournament Structure, Peers, and Superstars: Athlete Performance in 100 Meter Races

Brian Hill, Salisbury University

Why Tennis is a Dying Sport in the U.S.

Rotua Lumbantobing, Westminster College

Discussion amongst participants

<Stanhope>

<Friday, March 9 1:00-2:15 p.m.>

[C14] THEORY OF INTERNATIONAL TRADE I (JEL Code F)

Session Chair: **Yao-Yu Chih**, Indiana University Bloomington

Farsighted free trade under asymmetry

Yao-Yu Chih, Indiana University Bloomington

Evaluating the Impact of Western Hemisphere Trade Agreements on Trade Flows: A Gravity Model Approach

Nathan Perry, Colorado Mesa University; **Carlos Schonewald**, Universidade Federal do Rio de Janeiro

Discussion amongst participants

<Longfellow>

<Friday, March 9 1:00-2:15 p.m.>

[C15] MACROECONOMIC POLICY SPACE (JEL Code E)

Session organizers: **Esteban Pérez Caldentey**, ECLAC, Chile; **Matías Vernengo**, University of Utah

Session Chair: **Matías Vernengo**, University of Utah

Brazil and Mexico 1980-2010: two contrasting economic development under neo-liberalism policies and beyond

Adalmir Marquetti, PUC-RS (Brazil); **Gabriel Mendoza**, UNAM (México)

Pitfalls of Inflation Targeting in Open Economies

Esteban Pérez Caldentey, ECLAC, Chile

Regional Pooling of International Reserves: The Latin American Reserve Fund in Perspective

Luis Rosero, University of Massachusetts, Amherst

Discussion among participants

<Copley>

<Friday, March 9 1:00-2:15 p.m.>

[C16] STUDENT LEARNING IN ECONOMICS (JEL CODE A)

Session Chair: **James Marshall**, Muhlenberg College

Developing critical thinking skills through the study of economics: students' perspective: a pilot study

Ora Freedman, Stevenson University

A Metacurriculum on Metacognition: Teaching Students about Learning Economics, Strategies and Performance

Fahima Aziz, Hamline University

What Do They Know? A Survey of the Use of the Major Field Test in Business to Evaluate “Assurance of Learning” in Undergraduate Schools of Business

Jeffrey Green, Ball State University; **Courtenay Stone**, Ball State University; **Abera Zegeye**, Ball State University

Discussion amongst participants

<Holmes>

<Friday, March 9 1:00-2:15 a.m.>

[C17] CAPITAL STRUCTURE AND INVESTMENT (JEL Code G)

Session Chair: **Scott Deacle**, Ursinus College

A Necessary Limitation for Models of Capital and Capital Markets

David Harris, West Virginia University

What Drives Capital Structure Decisions?

Doruk Ilgaz, University of Houston

SPACs of Third Generation

Milan Lakicevic, University of Montenegro; **Milivoje Radovic**, University of Montenegro;

Milos Vulcanovic, Western New England University

Discussants: **Heather Montgomery**, International Christian University; **Nikiforos T. Laopodis**, Fairfield University

<Cabot>

<Friday, March 9 1:00-2:15 p.m.>

[C18] IN HONOR OF GALBRAITH

Session Chair: **Keith Ericson**, Boston University

Tobacco and Alcohol: A Galbraithian Perspective on Marketing and the Public Welfare

Stacey J. Anderson, University of California, San Francisco; **Stephen P. Dunn**, National Health Service, UK

Economics, Galbraith, and Marketing
Annette Forti, SUNY-Old Westbury

Discussion among participants

<Cambridge>

<Friday, March 9 1:00-2:15 p.m.>

[C19] VICES (JEL Codes D and J)

Session Chair: **Bruce Elmslie**, University of New Hampshire

Business Cycles and Alcohol Consumption
Shilpi Bhardwaj, Binghamton University

The Impact of Retirement on Smoking
Padmaja Ayyagari, University of Iowa

Honey, If You Make Me Happier I Won't Cheat On You
Bruce Elmslie, University of New Hampshire

Discussion amongst participants

<Constitution>

<Friday, March 9 2:30-3:45 p.m>

[D1] GROWTH, INFLATION, AND NEGATIVE REAL INTEREST RATES: A PANEL DISCUSSION

Organizer and Chair: **Thomas W. Synnott**, Cooper Union

The Long Wave Revisited
Thomas W. Synnott, Cooper Union (w1wnr@aol.com)

Monetary Policy in an Era of Deleveraging
Robert T. McGee, US Trust/BofA (robert.T.McGee@ustrust.com)

What does the Future Hold for Growth and Inflation?
Leonard J. Santow, Managing Director of Griggs and Santow (griggs@nyct.net)

A Practioner's View
Thomas W. Vail, American Capital Management (twvail@amcapmgt.com)

<Gloucester>

<Friday, March 9 2:30-3:45 p.m>

[D2] THE BUDGET, THE FED, AND THE IMPLICATIONS FOR BUSINESS CYCLE CONDITIONS

Session Organizer and Chair: **Steven R. Cunningham**, AIER and The University of Connecticut

Business Cycles: An Empirical View

Polina Vlasenko, AIER (polina.vlasenko@aier.org)

The Fiscal Resolution and Its Impact

Steven R. Cunningham and Polina Vlasenko, AIER (steven.cunningham@aier.org)

The Fed: The Aftermath of the Recession Policies

Steven R. Cunningham, AIER (steven.cunningham@aier.org)

Taxes and Deficits: No Easy Answer

Zinnia Mukherjee (zinnia.mukherjee@aier.org) and **Julie Zhu** (julie.zhu@aier.org), AIER

Discussion amongst participants

<Winthrop>

<Friday, March 9 2:30-3:45 p.m>

[D3] SPORTS ECONOMICS II

The Second of Three sessions sponsored by the North America Association for Sports Economics (NAASE)

Session Chair: **Victor Matheson**, College of the Holy Cross

Are Sunk Costs Irrelevant? Evidence from Playing Time in the National Basketball Association

Daniel Leeds, University of Michigan; **Michael A. Leeds**, Temple University; **Akira Motomura***, Stonehill College

Superstar Salaries and Soccer Success: The Impact of Designated Players in Major League Soccer

R. Todd Jewell, University of North Texas

Performance Incentives in Major League Baseball Contracts: The Relationship between Appearance Incentive Clauses and Player Output

John Stewart, Lafayette College; **Thomas H. Bruggink***, Lafayette College

Discussants: Kurt W. Rotthoff, Seton Hall University; **Trevor C. Collier**, University of Dayton; **Andy Zimbalist**, Smith College

<Thoreau>

<Friday, March 9 2:30-3:45 p.m>

[D4] GLOBALIZATION AND SUSTAINABLE DEVELOPMENT

Session Organizer and Chair: **Nadia Doytch**, University of New Haven

Harnessing Regional Cooperation for Broad-Based Growth

Dr. David Gould, The World Bank

Do local firms benefit from foreign direct investment? Evidence from India

Bingjie Hu and Congyan Tan, The World Bank

Riding the Commodity Rollercoaster: Natural Resource Management in the Context of Increasing Commodity Price Volatility

Yanchun Zhang, Viridiana Garcia and Nina Thelen, United Nations of Development Programme

Hot or Cold- the behavior of Sectoral FDI over Periods of Growth Accelerations and Decelerations

Nadia Doytch, University of New Haven (ndoytch@newhaven.edu)

<Stuart>

<Friday, March 9 2:30-3:45 p.m>

[D5] FORAGING AND MARRIAGE, INSTITUTIONS AND CULTURALLY-BASED PRIOR BELIEFS IN ENTREPRENEURSHIP, AND HETEROGENEITY IN BOUNDED RATIONALITY

Session Organizer: **Bijou Yang Lester**, Drexel University

Session Chair: **Charlotte D. Phelps**, Temple University

Foraging in the Marriage Market?

Donald Hantula, Temple University; **Charlotte D. Phelps**, Temple University

Entrepreneurship: How Important Are Institutions and Culturally-Based Prior Beliefs?

Francesco Ferrante, University of Cassino; **Gabriele Ruiu**, University of Cassino

Heterogeneity in Boundedly Rational Traders? Results from Double Auction Experiments

Shu-Heng Chen, National Chengchi University; **Chung-Ching Ta**, Tunghai University; **Lee-Xiang Yang**, National Chengchi University

<Franklin>

<Friday, March 9 2:30-3:45 p.m>

[D6] CHILD HEALTH AND SUPPORT

Session Chair: **Erin Fletcher**, Gettysburg College

Do Social Safety Nets Promote Innovation?

Mohammad Ashraf, UNC-Pembroke

Expectations of Support: Health Investments and Promises of Financial Support for Children

Erin Fletcher, Gettysburg College

The impact of prenatal pollution exposure on infant and child health outcomes

Rhea Bhatta, Lehigh University; **Shin-Yi Chou**, Lehigh University

The Effects of Prenatal Care: New Evidence

Ji Yan, Appalachian State University

<White Hill>

<Friday, March 9 2:30-3:45 p.m>

[D7] PECULIAR LABOR MARKETS

Offshoring and Occupational Switch

Tommaso Tempesti, University of Massachusetts Lowell

Spillover effects of minimum wages: Theory and experimental evidence

Marcus Dittrich, Chemnitz University of Technology

The Contribution of Human Capital Variables to Changes in Wage Distribution Function

Pallab Kumar Ghosh, Syracuse University

<Whittier>

<Friday, March 9 2:30-3:45 p.m>

[D8] DYNAMICS OF GROWTH AND DISTRIBUTION

The Fourth of Eighteen Sessions Sponsored by the Union for Radical Political Economics (URPE)

Session Organizers: **Armagan Gezici** and **Scott Carter**

Session Chair: **Robert Chernomas**, University of Manitoba

Capitalists, Workers, and Managers: a Three-Class Goodwin Model

Daniele Tavani, Colorado State University; **Ramaa Vasudevan**, Colorado State University

Profit Without Accumulation

Fletcher Baragar, University of Manitoba; **Robert Chernomas**, University of Manitoba

‘Dark Matter’, ‘Black Holes’ and Old Fashioned Exploitation: Multinationals and U.S. Profitability, Growth and Employment
Mona Ali, SUNY New Paltz

Credit Constraints, Profitability, and Animal Spirits in a Stock-Flow Consistent Model of Investment and Growth
Daniele Tavani, Colorado State University

Discussants: **Carlos A. Ibarra**, Universidad de las Américas Puebla Cholula; **Julio Huato**, St. Francis College; **Codrina Rada**, University of Utah; **Nina Eichacker**, University of Massachusetts, Amherst

<Charles River>

<Friday, March 9 2:30- 3:45 p.m.>

[D9] TRAINING AND INTERNAL LABOR MARKETS (JEL Code J)

Session Chair: **Michael Smith**, McGill University

Native Educational Responses to Local Immigrant Inflows: Evidence from Matched Individual Public and Private School Data in Florida
Thomas Murray, Fairfield University

The effects of a training levy on training outcomes: The case of Quebec
Michael Smith, McGill University

Schooling, work experience, and internal labor market: Wage earning from education, experience, and tenure in the Japanese steel industry, 1930-1960s
Masaki Nakabayashi, The University of Tokyo

Discussion amongst participants

<Emerson>

<Friday, March 9 2:30-3:45 p.m.>

[D10] THE ROLE OF HEALTH AND EDUCATION: EVIDENCE FROM SUB-SAHARAN AFRICA

The Second of Three Sessions sponsored by the African Finance and Economics Association (AFEA)

Session Organizer: **Mina Balamoune-Lutz**, University of North Florida

Session Chair: **Léonce Ndikumana**, University of Massachusetts at Amherst

The Impact of HIV/AIDS on Foreign Direct Investment: Evidence from Sub-Saharan Africa
Elizabeth Asiedu, The University of Kansas; **Yi Jin**, Monash University; **Isaac Kalonda-Kanyama**, The University of Kansas

The impact of HIV on Women Marriage Outcomes in Sub-Saharan Africa:
An Observation on Human Capital Investment
Kpoti Kitissou, Eastern Connecticut State University

Cash Transfers Given to Mothers and to Fathers: Impact on Education and Health of a
Randomized Control Trial in Rural Burkina Faso
Harounan Kazianga, Oklahoma State University; **Richard Akresh**, University of Illinois at
Urbana-Champaign; **Damien de Walque**, The World Bank

The Effects of HIV/AIDS on Economic Growth of Southern African Countries
Mahlet Gezahegn, Eastern Illinois University; **Mukti Upadhyay**, Eastern Illinois University

<Saint James>

<Friday, March 9 2:30-3:45 p.m.>

[D11] MILITARY, POLITICS, AND PUBLIC GOODS

Session Chair: **Adam Bee**, US Census Bureau

Effects of Mentorship Quality on Mentee Retention: Evidence from the United States Army
Dean Dudley, United States Military Academy

Political Budget Cycles in US Municipalities
Adam Bee, US Census Bureau; **Shawn Moulton**, Abt Associates

Does Group Payoff Information Impact Behavior in Symmetric Quadratic Common Pool
Resource and Public Goods Games?
David Kingsley, UML

The Impact of the Massachusetts Health Care Reform on Hospital Uncompensated Care
Fabienne Miller, Worcester Polytechnic Institute; **Justin Wang**, Worcester Polytechnic
Institute; **Yuhan Hua**, Worcester Polytechnic Institute

Discussion amongst participants

<Stanhope>

<Friday, March 9 2:30-3:45 p.m.>

[D14] INTERNATIONAL FINANCIAL ISSUES I (JEL Code F)

Session Chair: **Galin Todorov**, Florida International University

Time-Varying Risk and Risk Premiums in Frontier Markets

Galin Todorov, Florida International University; **Prasad Bidarkota**, Florida International University

IMF Programs, Financial and Real Sector Performance, and the Asian Crisis

Ali Kutan, Southern Illinois University Edwardsville; **Gulnur Muradoglu**, Cass Business School; **Brasukra Sudjana**, British Embassy, Indonesia

Wealth, Labour Income, Stock Returns, Government Bond Yields, and Systemic Risk

Ricardo Sousa, London School of Economics, FMG, University of Minho, and NIPE

Discussion amongst participants

<Longfellow>

<Friday, March 9 2:30-3:45 p.m.>

[D15] ECONOMIC RENT AND INEQUALITY

Session Organizer and Chair: **Mary M Cleveland**, Columbia SIPA

Sovereign Debt and Financial Repression: A Philosophy of Economic History

Francis K Peddle, Dominican University College

Inequality and Bubbles

Mary M Cleveland, Columbia SIPA

How sales taxation kills jobs and worsens inequality

Mason Gaffney, University of California, Riverside

Discussion amongst participants

<Copley>

<Friday, March 9 2:30-3:45 p.m.>

[D16] TECHNOLOGY AND INNOVATION (JEL Code L)

Innovation Frequency of Durable Complementary Goods

Yijuan Chen, Australian National University

Analyzing the Welfare Effects of Diffusing Technology that induces Product Differentiation

Phoebe Chan, Wheaton College

Innovation and External Knowledge: A Human Capital Approach

Amaia Altuzarra, University of Basque Country; **Felipe Serrano**, University of Basque Country

Discussion amongst participants

<Holmes>

<Friday, March 9 2:30-3:45 p.m.>

[D17] EQUITY MARKET (JEL Code G)

Session Chair: **David E Harris**, West Virginia University;

Dynamic Linkages Between Industries and the Stock Market
Nikiforos T. Laopodis, Fairfield University

The effect of bank holding company real estate investment on risk and return: A GARCH approach
Scott Deacle, Ursinus College; **Elyas Elyasiani**, Temple University

Commonalities in CDS and stock markets
Caitlin Greatrex, Iona College; **Erick Rengifo**, Fordham University

Discussants: **David E Harris**, West Virginia University; **Dominik Maltritz**, TU Dresden;
Dainn Wie, National Graduate Institute for Policy Studies

<Cabot>

<Friday, March 9 2:30-3:45 p.m.>

[D18] BANK LENDING AND THE FEDERAL RESERVE (JEL Code E)

Session Chair: **Greg Hannsgen**, Levy Economics Institute

Do Nonbank Financial Institutions Behave in the Similar Way As Banks Do in Response to a Monetary Policy Shock?
Sung-Eun Yu, University of Utah

Bank Capital, Bank Profits, and Loan Activity
Paul Orzechowski, Monmouth University

Leverage, Liquidity, and Crisis: A Simulation Study
Stephen Kinsella, University of Limerick

The Contribution of the U.S. Federal Reserve's Systematic Use of Contractionary Monetary Policy to Suppress Inflation to the Fall of the Real Male Wage and the Upward Redistribution of National Income, 1978-1996

Sara Dustin, Independent Scholar

Discussants: **Victor Kasper**, Buffalo State College; **Greg Hannsgen**, Levy Economics Institute; **James Stodder**, Rensselaer Polytechnic Institute; **Laura Moretti**, House of Finance

<Cambridge>

<Friday, March 9 2:30-3:45 p.m.>

[D19] CORRUPTION AND SHIRKING (JEL Code D)

Session Chair: **Zhou Lu**, The City College of New York

Click Petty Corruption Away

Kanybek Nur-tegin, Florida Atlantic University

Anti-Corruption Mechanism and Screening Contracts

Zhou Lu, The City College of New York

Rewarding Idleness

Andrea Canidio, Central European University; **Thomas Gall**, University of Bonn

Discussion amongst participants

<Constitution>

<Friday, March 9 4:00-5:15 p.m.>

[E1] TEACHING THE ART OF ECONOMIC RESEARCH TO UNDERGRADUATES: A DISCUSSION

Session Organizer and Chair: **Jessica Reyes**, Amherst College

Session participants: **Jessica Reyes**, Amherst College; **Steven Greenlaw**, University of Mary Washington; **Wayne Gray**, Clark University

<Gloucester>

<Friday, March 9 4:00-5:15 p.m.>

[E2] THE MACROECONOMICS OF THE ECONOMIC CRISIS: THEORY, EVIDENCE, AND POLICY ANALYSIS

Session Organizer: **Olivier Giovannoni**, Bard College

Session Chair: **Mario Seccareccia**, University of Ottawa

Modern Austerity Policy: An Analysis

Alain Parguez, University of Franche-Comté (alain.parguez@neties.com)

Financial Reform: Why Did Roosevelt Succeed and Obama Fail?

Thomas Ferguson, University of Massachusetts at Boston (thomas.ferguson@umb.edu)

The Pattern of Recessions, the 80s Turnaround and the Effectiveness of Government Spending

Olivier Giovannoni, Bard College (ogiovann@bard.edu)

Household Spending and Debt: A Meso Analysis Using US Data

Orsola Costantini, University of Pavia (orsola.costantini@eco.unipv.it)

<Winthrop>

<Friday, March 9 4:00-5:15 p.m.>

[E3] SPORTS ECONOMICS III

The Third of Three sessions sponsored by the North America Association for Sports Economics (NAASE)

Session Chair: **Kurt Rotthoff**, Seton Hall University

If you host it, will they come? Mega-Events and Tourism in South Africa

Victor Matheson, College of the Holy Cross; **Stefan Syzmanski**, University of Michigan

Do Bi-Lateral Trade Agreements Extend Beyond Trade? A Measure of Cultural Bias in World Gymnastics

Kurt W. Rotthoff, Seton Hall University; **Brian P. Callahan**, Seton Hall University; **Sean E. Mulholland**, Stonehill College

Relegation in the English Premier League: Are all incentives created equal?

Trevor C. Collier, University of Dayton

Discussants: **Akira Motomura**, Stonehill College; **R. Todd Jewell**, University of North Texas;

Darius J. Conger, Ithaca College

<Thoreau>

<Friday, March 9 4:00-5:15 p.m.>

[E4] GLOBALIZATION: FINANCIAL CRISIS, DISLOCATION, AND GREAT SLOWDOWN

Session Organizer and Chair: **Surendra K. Kaushik**, Pace University

Expanding the Horizons of Financial Literacy Globally

Roy Girasa, Pace University

Is solar power really here in the United States and India?

Devaki Chandra, Berkeley

Principal Reduction Mortgage Refinancing as a Key Solution to the Global Financial Crisis

Surendra K. Kaushik, Pace University

Discussants: **Surendra K. Kaushik**, Pace University; **Devaki Chandra**, Berkeley; **Roy Girasa**, Pace University

<Stuart>

<Friday, March 9 4:00-5:15 p.m.>

[E5] HOLD FOR EBERT CHANGE

<Franklin>

<Friday, March 9 4:00-5:15 p.m.>

[E6] EDUCATION OF CHILDREN

Session Chair: **Seth Gershenson**, American University

Does Happiness Matter? The Effect of Teacher Job Satisfaction on Productivity

Lauren Calimeris, Metropolitan State College of Denver

Peer Effects in Free School Meals: Information or Stigma?

Jonathan James, European University Institute

Is there a summer time-use gap?

Seth Gershenson, American University

Can Mortality Risks Differences Explain Youth Educational Attainment Gaps?

Man Jia, Northeastern University

<White Hill>

<Friday, March 9 4:00-5:15 p.m.>

[E7] DEVELOPMENT, DISTRIBUTION AND GROWTH

The Fifteenth of Eighteen Sessions sponsored by the Union for Radical Political Economics (URPE)

Session Organizer and Chair: **Cem Oyvatt**, University of Massachusetts Amherst

Relative mortality improvements as a marker of socio-economic inequality across the developing world, 1990-2009

Deepankar Basu, University of Massachusetts Amherst

Is there Anything Better than the GDP per capita to Measure Earnings and Development?

Jose Caraballo Cueto, New School for Social Research

Is Devaluation Always Contractionary (Expansive)? If so on What Basis?

Francisco Martinez Hernandez, New School for Social Research

Beating inflation: China's defense and dilemma

Doris Yuanyuan Zhang, New School for Social Research

Discussion amongst participants

<Whittier>

<Friday, March 9 4:00-5:15 p.m.>

[E8] FISCAL POLICY, GROWTH, AND FULL EMPLOYMENT

The Fifth of Eighteen Sessions Sponsored by the Union for Radical Political Economics (URPE)

Session Organizer: **Thomas Michl**, Colgate University

Session Chair: **Steven Fazzari**, Washington University

Fiscal Policy During and After the Great Recession

L. Josh Bivens, Economic Policy Institute

A Model of the Limits of Fiscal Policy

Thomas Michl, Colgate University

Fiscal Policy in an Economy with an Aging Population: A Structuralist Approach

Codrina Rada, University of Utah

Public Debt and Full Employment in a Stock-flow Consistent Model of a Corporate Economy

Soon Ryoo, Adelphi University; **Peter Skott**, University of Massachusetts at Amherst

Discussants: **Marc Lavoie**, University of Ottawa; **Josh W. Mason**, University of Massachusetts at Amherst; **Steven Fazzari**, Washington University

<Charles River>

<Friday, March 9 4:00-5:15 p.m.>

[E9] TRANSPORTATION: TRADE AND SAFETY (JEL Code R)

Session Chair: **Adam Storeygard**, Brown University

Analysis of the Transnational Road Freight Transport in the Southwestern European Border

Fernando Barreiro-Pereira, UNED-Facultad de Economicas

[https://editorialexpress.com/cgi-](https://editorialexpress.com/cgi-bin/conference/conference.cgi?action=paper&subaction=info&info3=85)

[bin/conference/conference.cgi?action=paper&subaction=info&info3=85](https://editorialexpress.com/cgi-bin/conference/conference.cgi?action=paper&subaction=info&info3=85) Farther on down the road:
transport costs, trade and urban growth in sub-Saharan Africa

Adam Storeygard, Brown University

The Impact of Liability Insurance and Claims Paid on Fatal Trucking Accidents—A Panel Study
Mark Kazarosian, Stonehill College

Discussants: **Adam Storeygard**, Brown University; **Fernando Barreiro-Pereira**, UNED-Facultad de Economicas; **Richard Vogel**, Farmingdale State College

<Emerson>

<Friday, March 9 4:00 p.m.>

[E10] ISSUES IN ENERGY ECONOMICS

Truth and True Gret for True Green
Joan Hoffman; John Jay College of Criminal Justice

The Cyclicity of the Demand for Crude Oil: Evidence from the OECD
George Tawadros, School of Economics, Finance and Marketing

The Power of the Sun - Power to the People
Morris Speter, Mercy College

<Saint James>

<Friday, March 9 4:00-5:15 p.m.>

[E11] INTERNATIONAL LABOR

Session Chair: **Sanae Tashiro**, Rhode Island College

What shapes variations in rural Indian women's work? Agrarian Change versus the U-Hypothesis
Avanti Mukherjee, University of Massachusetts, Amherst

The impact of HIV on Women Marriage Outcomes in Sub-Saharan Africa
Kpoti Kitissou

Temporary Workers in Japan's Lost Decades: Evidence from the Japanese Panel Survey of Consumers
Sanae Tashiro, Rhode Island College

Employment of Older Workers in International Perspective
Marietta Constantinides, DeSales University

Discussion amongst participants

<Stanhope>

<Friday, March 9 4:00-5:15 p.m.>

[E14] EMERGING MARKETS (JEL Code F)

Session Chair: **Jacek Rothert**, University of Texas, Austin

Productivity, Interest Rate Shocks and International Prices
Jacek Rothert, University of Texas, Austin

International Banks and the Cross-Border Transmission of Business Cycles
Ricardo Correa, Board of Governors of the Federal Reserve; **Horacio Sapriza**, Rutgers University and Board of Governors; **Andrei Zlate**, Board of Governors of the Federal Reserve System

Impact of remittances on GDP growth in Montenegro
Milan Lakicevic, University of Montenegro; **Milivoje Radovic**, University of Montenegro; **Milos Vulcanovic**, Western New England University

Discussion amongst participants

<Longfellow>

<Friday, March 9 4:00-5:15 p.m.>

[E15] FORTI PRESENTATION: UNSURE OF WHAT TO PUT HERE

<Copley>

<Friday, March 9 4:00-5:15 p.m.>

[E16] IMPACTS ON R&D (JEL Code L)

Less Protection, More Innovation
Murat Mungan, College of Law

Delegation in a spatial game with endogenous spillovers
Zhao Kai, University of Maine

Discussion amongst participants

<Holmes>

<Friday, March 9 4:00-5:15 p.m.>

[E17] EQUITY TRADING (JEL Code G)

Session Chair: **Dominik Maltritz**, TU Dresden

The Five Day Workweek System and Investor Inattention on Friday Earnings Announcements:
Evidence from Korea's Stock Market

Dainn Wie, National Graduate Institute for Policy Studies

Overreaction of Country ETFs to US Market Returns: Intraday vs. Daily Horizons & the Role of
Synchronized Trading

Ariel Levy, Israel Institute of Technology

Cause of Return Reversal: Information Monopoly Hypothesis

Viktoria Dalko, Harvard University & Holt IBS

Discussants: **Caitlin Greatrex**, Iona College; **Diego Restrepo-Tobon**, Binghamton University;

Eric Doviak, Brooklyn College

<Cabot>

<Friday, March 9 4:00-5:15 p.m.>

[E18] MONETARY POLICY (JEL Code E)

Session Chair: **Sara Dustin**

Proportionality, the Two-Price Theory, and Monetary Circulation

Mark Lautzenheiser, Earlham College; **Yavuz Yasar**, University of Denver

Monetary Policy Transmission in the Eurozone

Ayla Ogus Binatli, Izmir University of Economics; **Niloufer Sohrabji**, Simmons College

Inflation Targeting and Product Market Deregulation

Laura Moretti, House of Finance, Germany

Discussants: **Parag Waknis**, UMASS Dartmouth; **Daniele Tavani**, Colorado State University;

Lee Spector, Ball State University

<Cambridge>

<Friday, March 9 4:00-5:15 p.m.>

[E19] TOPICS IN FORENSIC ECONOMICS I

The First of Four Sessions Sponsored by the National Association of Forensic Economics

<Constitution>

<Saturday, March 10 8:15-9:30 a.m.>

[F1] CONTEMPORARY ECONOMIC ISSUES

Session Organizer and Chair: **Chong-Uk Kim**, Sonoma State University

An Analysis of the Chonse and Purchase Prices in the Korean Housing Market

Gieyoung Lim, Hankuk University of Foreign Studies; **Jan R. Kim**, Hankuk University of Foreign Studies

Examining the Effects of Economic Recessions in the U.S. Restaurant Industry

Inhyuck "Steve" Ha, Western Carolina University; **Kyuhoo Lee**, Sonoma State University

Separation between Tax Management and Government Expenditure: Public Choice Approach

Sangwon Park, Hankuk University of Foreign Studies

Social Returns to College Education: Evidence from OECD Countries

Chong-Uk Kim, Sonoma State University; **Gieyoung Lim**, Hankuk University of Foreign Studies

Discussants: **Florence Bouvet**, Sonoma State University; **Christina Steiger**, Northeastern

University; **Chong-Uk Kim**, Sonoma State University; **Gieyoung Lim**, Hankuk University of Foreign Studies

<Gloucester>

<Saturday, March 10 8:15-9:30 a.m.>

[F2] ALTERNATIVE PERSPECTIVES ON BANKING AND FINANCE

Session Organizer: **John Smithin**, York University

Session Chair: **Louis Phillipe-Rochon**, Laurentian University

Patterns of Debt in Developing Economies: Higher Commerce of Financial Instruments Without Financial Instability

Noemi Levy-Orlik, National Autonomous University of Mexico (noemi.levy@gmail.com)

Theory of Banking and the Relationship between the Central Bank and Commercial Banks

Eric Kam, Ryerson University (erickam@economics.ryerson.ca)

How Australia was Able to Withstand the GFC: A Free Banking Perspective
Trevor Coombes, Victoria University (Trevor.Coombes@vu.edu.au)

Liquidity Preference, Interest Rates, Banking, and Endogenous Money
John Smithin, York University (jsmithin@yorku.ca)

Discussion amongst participants

<Winthrop>

<Saturday, March 10 8:15-9:30 a.m.>

[F3] TOPICS IN MACROECONOMICS

Session Chair: **Esin Cakan**, University of New Haven

Remittances , Inflation and Exchange Rates in South Asia
Kamal Upadhyaya, University of New Haven

Governance Indicators: What did We Learn from the Kurtz-Kaufman Debate?
Armando Rodriguez, University of New Haven

Business and Real Estate Cycles in the U.S.: Evidence from a Markov-Switching Regression Exercise
Mona Kyoko, Manhattanville College; **Aram Balagyozyan**, University of Scranton; **Christos Giannikos**, Baruch College

Impact of Military Expenses on the US Economic Growth: A Cointegration Analysis by ARDL Bound Test
Mona Kyoko, Manhattanville College; **Esin Cakan**, University of New Haven

Discussion amongst participants

<Thoreau>

<Saturday, March 10 8:15-9:30 a.m.>

[F4] HEALTH

The First of Five sessions sponsored by the Committee on the Status of Women in the Economics Profession (CSWEP)

Session Chair: **Yang Wang**, Lafayette College

The Welfare Impact of Hospital Entry: Evidence from the Pennsylvania Cardiac Surgery Market
Suhui Li, Lehigh University

The Impact of Diabetes Mandates on Infant Health
Anca Cotet, Seaton Hall University; **Lee Spector**, Ball State University

The Price of Decision Making Control in Insurance Choice

Jennifer Kohn, Drew University

Sunshine & Infant Health

Karen Conway and Jenn Trudeau, University of New Hampshire

Discussants: **Resul Cesur**, University of Connecticut; **Reagan Baughman**, University of New Hampshire; **Donka Mirtcheva**, TCNJ; **Dhaval Dave**, Bentley University

<Stuart>

<Saturday, March 10 8:15-9:30 a.m.>

[F5] GLOBAL REAL AND FINANCIAL LINKAGES: CURRENT OR CAPITAL ACCOUNT, OR BOTH?

Session organizer and chair: **Rudiger von Arnim**, University of Utah

Balance of payments dominance: Its implications for macroeconomic policy

Jose-Antonio Ocampo, Columbia University

Measuring sustainable output gaps in a GVAR framework

Matthew Greenwood-Nimmo, University of Leeds; **James Mitchell**, University of Leicester & NIESR; **Yongcheol Shin**, University of York

Core labor standards, wage productivity linkages and growth in a multi-country model

Raymond Torres, Institute for International Labour Studies; **Rudiger von Arnim**, University of Utah

Current account imbalances and economic growth: a two-country model with real-financial linkages

Laura Carvalho, New School for Social Research

Discussants: **Korkut Erturk**, U. of Utah; **Laura Carvalho**, New School for Social Research; **Daniele Tavani**, Colorado State University; **Ramaa Vasudevan**, Colorado State University

<Franklin>

<Saturday, March 10 8:15-9:30 a.m.>

[F6] AGENT-BASED COMPUTATIONAL ECONOMICS: SOCIAL NETWORKS **The First of Four Sessions sponsored by The NYC Computational Economics & Complexity Workshop**

Session Organizer: **Jason Barr**, Rutgers University, Newark

Session Chair: **Andre R. Neveu**, James Madison University

Time Fluctuations in Agent's Performance: Correlation vs. Causality, Lessons from the 'Hot Hand' Phenomenon in Sports

Gur Yaari, Yale School of Medicine

Endogenous Movement and Equilibrium Selection in Spatial Coordination Games

David Hagmann, Fordham University; **Tassier**, Fordham University; **Jason Barr**, Rutgers University Newark

Concurrency and the Spread of HIV: The Role of Gender Asymmetry

Alan Isaac, American University; **Larry Sawers**, American University; **Eileen Stillwaggon**, Gettysburg College

Identity Networks and Educational Effort

Jason Barr, Rutgers University Newark; **Christopher Ruebeck**, Lafayette College

Discussants: **Christopher Ruebeck**, Lafayette College; **Andreas Duus Pape**, Binghamton University; **Gur Yaari**, Yale School of Medicine; **Myong-Hun Chang**, Cleveland State University

<White Hill>

<Saturday, March 10 8:15-9:30 a.m.>

[F7] FINANCIAL INSTABILITY IN THE U.S AND THE EUROZONE

Session Organizer: **Yeva Nersisyan**, Franklin and Marshall College

A Greek Endgame for the Euro?

Dimitri Papadimitriou, Levy Economics Institute

Is there any way to Stop the Headlong Race to a Minsky/Fisher Debt Deflation?

L. Randall Wray, Levy Economics Institute

What Should Central Banks Do to Contain the Crisis?

Thorvald Moe, Central Bank of Norway

Financial Instability in the Eurozone

Yeva Nersisyan, Franklin and Marshall College

<Whittier>

<Saturday, March 10 8:15-9:30 a.m.>

[F8] ROUNDTABLE ON ECONOMIC WELL BEING OF HOUSEHOLDS

The Sixth of Eighteen Sessions Sponsored by the Union for Radical Political Economics (URPE)

Session Organizer: **Thomas Masterson**, Levy Economics Institute of Bard College

Session Chair: **Lynda Pickbourn**, Keene State College

Joie de Vivre? Comparison of US and French LIMEW for 1989 and 2000

Thomas Masterson, Levy Economics Institute of Bard College; **Selcuk Eren**, Levy Economics Institute of Bard College; **Edward Wolff**, Levy Economics Institute of Bard College; **Ajit Zacharias**, Levy Economics Institute of Bard College

Comparison of US and UK LIMEW for 1995 and 2005

Selcuk Eren, Levy Economics Institute of Bard College; **Thomas Masterson**, Levy Economics Institute of Bard College; **Edward Wolff**, Levy Economics Institute of Bard College; **Ajit Zacharias**, Levy Economics Institute of Bard College

Living Standards in The United States in a Historical and Comparative Perspective: Some Results from the LIMEW Project

Ajit Zacharias, Levy Economics Institute of Bard College; **Selcuk Eren**, Levy Economics Institute of Bard College; **Thomas Masterson**, Levy Economics Institute of Bard College; **Edward Wolff**, Levy Economics Institute of Bard College

Discussion amongst participants

<Charles River>

<Saturday, March 10 8:15-9:30 a.m.>

[F9] PLEASE ASK WHAT YOUR COUNTRY CAN DO FOR YOU: THE BUREAU OF LABOR STATISTICS AT YOUR SERVICE (JEL Code J)

Session Chairs: **Timothy Consedine**, Bureau of Labor Statistics; **Geoffrey Paulin**, Bureau of Labor Statistics

An Overview of the Bureau of Labor Statistics: Finding the Data You Need from Your Local EA&I Staff

Tim Consedine, Bureau of Labor Statistics

High Tech Industries in Massachusetts: Employment and Wage Trends During the 2001-2009 Period

Cynthia Gillham, Bureau of Labor Statistics

BLS Green Jobs Initiative: BLS Collection Methodology

Mark Maggi, Bureau of Labor Statistics

Two roads diverged in a yellow wood ... I took the one that was toll-free: Introduction to the Consumer Expenditure Survey, with Examples using Travel Data

Geoffrey Paulin, Bureau of Labor Statistics

Discussion amongst participants

<Emerson>

<Saturday, March 10 8:15-9:30 a.m.>

[F10] ENERGY GENERATION IMPACTS

Session Chair: **Raluca Iorgulescu**, National Institute of Economic Research

Renaissance or Requiem: Is Nuclear Energy Cost-Effective in a Post Fukushima World?

Peter Schwarz, UNC Charlotte; **Joseph Cochrane**, UNC Charlotte

The Economic Development, Environment, and Public Health Link: An Ecological Economic Study of the Yali Falls Dam

John Polimeni, Albany College of Pharmacy; **Raluca Iorgulescu**, National Institute of Economic Research; **Ray Chandrasekara**, Albany College of Pharmacy

Discussants: **Raluca Iorgulescu**, National Institute of Economic Research; **Sara Hsu**, SUNY New Paltz

<Saint James>

<Saturday, March 10 8:15-9:30 a.m.>

[F11] FREEDOM AND ENTREPRENEURSHIP

Session Chair: **Jeffrey Yankow**, Furman University

A Longitudinal Analysis of the Impact of State Economic Freedom on Individual Wages

Jeffrey Yankow, Furman University

Labor Market Reforms and the Changing Nature of Self-Employment in Georgia

Tamar Khitarishvili, Bard College

Speed of Entrepreneurial Learning and Firm Growth

Indu Khurana, Florida International University

Discussion amongst participants

<Stanhope>

<Saturday, March 10 8:15-9:30 a.m.>

[F14] EXCHANGE RATE AND ITS IMPACT II (JEL Code F)

Session Chair: **Chang Hong**, Clark University

China's Trade Response to Exchange Rate

Chang Hong, Clark University

Asymmetric Effect of Exchange Rates

Zulal Denaux, Valdosta State University

Currency Risk: Long Swings and Volatility

Josh Stillwagon, University of New Hampshire

Is there an S-curve relationship between US trade balance and terms of trade? An analysis across industries and countries

Amit Ghosh, Illinois Wesleyan University

Discussion amongst participants

<Longfellow>

<Saturday, March 10 8:15-9:30 a.m.>

[F15] ENVIRONMENTAL RISK AND NON-MARKET VALUATION

Session Organizer and Chair: **Pallab Mozumder**, Florida International University

Application of Non-market Valuation to California's Coastal Policy Decisions

Nejem Raheem (email: nejemraheem@gmail.com), Emerson College

Management of Water Services: An Economic Valuation from Urban Guatemala

William F. Vasquez Mazariegos (email: wvasquez@fairfield.edu), Fairfield University; **Pallab Mozumder**, Florida International University

Hurricane Wilma, Utility Disruption and Household Wellbeing

Chiradip Chatterjee (email: cchat003@fiu.edu), Florida International University

Risk Perceptions and Adaptation to Climate Change: Survey Evidence from Maple Syrup Farmers

Pallab Mozumder (email: mozumder@fiu.edu), Florida International University

Discussion amongst participants

<Copley>

<Saturday, March 10 8:15-9:30 a.m.>

[F16] ECONOMETRIC MODELING AND ESTIMATION (JEL Code C)

Session chair: **Jakob Grazzini**, University of Torino

Indirect estimation of agent-based models. An application to a simple diffusion model

Jakob Grazzini, University of Torino; **Matteo Richiardi**, University of Torino; **Lisa Sella**, Ceris CNR

Learning Rules of Unobserved Heterogeneity in Structural Auction Models: Nonparametric Identification and Applications

Yonghong An, University of Connecticut; **Yingyao Hu**, Johns Hopkins University

Estimation of Nonlinear Models in a Quasi-Maximum Likelihood and Generalized Estimating Equations Approach with Spatially Correlated Cross Section Data

Cuicui Lu, Michigan State University

<Holmes>

<Saturday, March 10 8:15-9:30 a.m.>

[F17] HOME MORTGAGE (JEL Code G)

Session Chair: **Barkley Rosser**, James Madison University

Who Defaults on their Home Mortgage? Who Enters the Foreclosure Process? (two papers)

Eric Doviak, Brooklyn College; **Sean MacDonald**, New York City College of Technology, CUNY

Screening Cost, Credit Risk, and the Optimal Structure of Mortgage Lending

Pingkang Yu, The George Washington University

Minorities and Racial Disparities: Reasons for Mortgage Credit Denial

Sourav Batabyal, State University of New York at Fredonia

Discussants: **Ariel Levy**, Israel Institute of Technology; **Jane Yoo**, George Washington University; **Muhammad Omer**, University of Groningen

<Cabot>

<Saturday, March 10 8:15-9:30 a.m.>

[F18] INTERNATIONAL TRADE AND PERFORMANCE (JEL Code E)

The Macro-Stability of Swiss WIR-Bank Spending: Balance and Leverage Effects
James Stodder, Rensselaer Polytechnic Institute

Responding to Recession: The Thai Case
Jonathan Haughton, Suffolk University; **Shahidur Khandker**, World Bank

Discussion amongst participants

<Cambridge>

<Saturday, March 10 8:15-9:30 a.m.>

[F19] TOPICS IN FORENSIC ECONOMICS II

The Second of Four Sessions Sponsored by the National Association of Forensic Economics

<Constitution>

<Saturday, March 10 9:45-11:00 a.m.>

[G1] EMPIRICAL ANALYSIS OF ENVIRONMENTAL REGULATION

Session Organizer and Chair: **Wayne B. Gray**, Clark University

Corporate Restructuring and Environmental Compliance at Paper Mills
Wayne B. Gray, Clark University

Changes in Effectiveness of Environmental Regulation over Time
Wang Jin, Clark University

Environmental Regulation, Pollution Abatement, and Productivity: A Frontier Analysis
Shital Sharma, Clark University

Discussants: **Wayne B. Gray**, Clark University; **Wang Jin**, Clark University; **Shital Sharma**, Clark University

<Gloucester>

<Saturday, March 10 9:45-11:00 a.m.>

[G2] INTERNATIONAL FINANCIAL ISSUES III (JEL Codes F, G)

Session Organizer & Chair: **Theologos Homer Bonitsis**, New Jersey Institute of Technology
(bonitsis@adm.njit.edu)

The Dynamics of Key Worldwide Money Market Interest Rates and the Federal Funds Rate
Krishna M. Kasibhatla, North Carolina A&T State University (kmkasibh@ncat.edu); **John Malindretos**, William Patterson University (malindetrosj@wpunj.edu)

Observing Evidence of Inside Trading in the Athens Stock Exchange\

Dimitrios Maditinis, Kavala Institute of Technology (dmadi@teikav.edu.gr); **Eleftherios Thalassinis**, University of Piraeus (thalassi@unipi.gr); **Athanasios Paschalidis**, Kavala Institute of Technology

What has Caused the Depreciation of the U.S. Dollar?

John N. Kallianiotis, University of Scranton (jnk353@scranton.edu)

Discussant: **Viktoria Dalko**, Harvard University & Holt IBS

<Winthrop>

<Saturday, March 10 9:45-11:00 a.m>

[G3] MODELS OF GROWTH AND DISTRIBUTION

Session Chair: **Codrina Rada**, University of Utah

Demand and distribution in a two country model

Rudi Von Arnim, University of Utah; **Daniele Tavani**, Colorado State University; **Laura de Carvalho**, New School for Social Research

Goodwin Cycles in OECD countries

Nelson Barbosa, Federal University of Rio de Janeiro and Ministry of Finance of Brazil;
Armon Rezai, Vienna University of Economics and Business

Debt-equity and Goodwin dynamics

Codrina Rada, University of Utah

Growth and Distribution: the role of managers

Michalis Nikiforos, New School for Social Research

Discussants: **Nelson Barbosa**, Federal University of Rio de Janeiro and Ministry of Finance of Brazil; **Michalis Nikiforos**, New School for Social Research; **Armon Rezai**, Vienna University of Economics and Business; **Rudi Von Amin**, University of Utah

<Thoreau>

<Saturday, March 10 9:45-11:00 a.m>

[G4] THE EFFECT OF SMOKING, COMBAT AND FOOD STAMPS ON HEALTH

The Second of Five sessions sponsored by the Committee on the Status of Women in the Economics Profession (CSWEP)

Session Chair: **Karen Conway**, University of New Hampshire

The Demand for Smokeless Tobacco: Role of Advertising and Targeting

Dhaval Dave, Bentley University; **Henry Saffer**, CUNY

The Effect of Combat Exposure on Migraine Headache

Resul Cesur, University of Connecticut ; **Joseph J. Sabia**, San Diego State University; **Erdal Tekin**, Georgia State University

Did the 2008 food stamp program change reduce obesity among SNAP beneficiaries?

Donka Mirtcheva , The College of New Jersey; **Susan L. Averett**, Lafayette College

Health Behaviors, Disability & Early Retirement: The Effects of Smoking and Obesity

Reagan Baughman, University of New Hampshire

Discussants: **Suhui Li**, Lehigh University; **Jennifer Kohn**, Drew University; **Anca Cotet**, Seaton Hall University; **Resul Cesur**, University of Connecticut

<Stuart>

<Saturday, March 10 9:45 a.m>

[G5] PREFERENCES, VALUES, AND CHOICE

The Third of Four Sessions sponsored by the Association for Social Economics (ASE)

Session Organizer and Chair: **Mark D. White**, College of Staten Island

Closing the Eyes on a Gloomy Future: Psychological Causes and Economic Consequences

Rachid Laajaj, University of Wisconsin Madison

The Problem with Preferences.

Mark D. White, The College of Staten Island

Preferences and Values as Implicit Premises of Economic Models

Silvia Zorzetto, Milan University

Discussion amongst participants

<Franklin>

<Saturday, March 10 9:45-11:00 a.m>

[G6] AGENT-BASED COMPUTATIONAL ECONOMICS: FINANCE

The Second of Four Sessions sponsored by The NYC Computational Economics & Complexity Workshop

Session Organizer and Chair: **Germán Creamer**, Stevens Institute of Technology

A Real Minsky Moment in an Artificial Stock Market

Blake LeBaron, Brandeis University

Predicting the Prediction Market: Would Smart Agents Help?

Shu-Heng Chen, **Chen-Yuan Tung**, **Chung-Ching Tai**, **Bin-Tzong Chie** and **Tzu-Chuan Chou**, National Chengchi University

Studying The Dynamics of a Continuous Double-auction Market with Artificially Intelligent Agent Based Models

George Panterov, American University; **Leanne Ussher**, Queens College, CUNY

Simulating Investors' Views in the Black Litterman Portfolio Optimization Model

Germán Creamer, Stevens Institute of Technology

Discussants: **Shu-Heng Chen**, National Chengchi University; **Mark Setterfield**, Trinity

College; **Germán Creamer**, Stevens Institute of Technology; **Andre R. Neveu**, James Madison University

<White Hill>

<Saturday, March 10 9:45 a.m.>

[G7] TOPIC IN HETERODOX POLITICAL ECONOMY

The Sixteenth of Eighteen Sessions sponsored by the Union for Radical Political Economics (URPE)

Session Organizers: **Armagan Gezici** and **Scott Carter**

Session Chair: **Scott Carter**, The University of Tulsa, scott-carter@utulsa.edu

Are we working at the same place? Perceptions of Workplace Practices and Labor Retention in Early Care and Education

Lynn A. Hatch, U.S. Coast Guard Academy

Reconceptualizing Internal Migration in India

Smriti Rao, Assumption College; **Kade Finnoff**, University of Massachusetts Boston

Gender and Public Good Provisioning in Health Care in Countries After War.

Kade Finnoff, University of Massachusetts Boston

Discussion amongst participants

<Whittier>

<Saturday, March 10 9:45-11:00 a.m.>

[G8] ROUNDTABLE ON IMPROVING GOVERNANCE OF THE GOVERNMENT SAFETY NET IN FINANCIAL CRISES

The Seventh of Eighteen Sessions Sponsored by the Union for Radical Political Economics (URPE)

Session Organizer: **Nicola Matthews**, University of Missouri

Session Chair: **L. Randall Wray**, University of Missouri

Participants: **Walker Todd**, American Institute for Economic Research; **Dr. Thomas Ferguson**; **James A. Felkerson**; **Nicola Matthews**, University of Missouri

Discussion amongst participants

<Charles River>

<Saturday, March 10 9:45-11:00 a.m.>

[G9] IMPROVING INCOME TAX DATA IN THE CONSUMER EXPENDITURE SURVEY: THE CURRENT PROBLEM, THE PROPOSED SOLUTION, AND CALL FOR COMMENTS (JEL Code J)

Session Chair: **Geoffrey Paulin**, Bureau of Labor Statistics

Overview of Income, Tax, and Expenditure Data in the Consumer Expenditure Survey: Mechanisms in Place and Proposed for Addressing Measurement Error

Geoffrey Paulin, Bureau of Labor Statistics

Use of TAXSIM to Impute Federal and State Tax Data

Laura Paszkiewicz, Bureau of Labor Statistics

Evaluation of Methods, Part I: Effects on Estimates of After-Tax Income, Savings Rates, and Related Measures

Geoffrey Paulin, Bureau of Labor Statistics

Evaluation of Methods, Part II: Effects on Microdata Research—Evidence from Charitable Contributions Before, During, and After the Recent Recession

Laura Paszkiewicz, Bureau of Labor Statistics

How You Can Help: Call for Review and Comment of Proposed Methods

Geoffrey Paulin, Bureau of Labor Statistics

Discussion led by **Daniel Feenberg**, National Bureau of Economic Research

<Emerson>

<Saturday, March 10 9:45-11:00 a.m.>

[G10] GROWTH, EMPLOYMENT, AND CAPITAL FLOWS: LESSONS FROM AFRICA

The Third of Three Sessions sponsored by the African Finance and Economics Association (AFEA)

Session Organizer: **Mina Balamoune-Lutz**, University of North Florida

Session Chair: **Mwangi wa Githinji**, University of Massachusetts-Amherst

Jobless Economic Growth: Lessons from Africa

Frannie A. Léautier and Kobena Hanson, The African Capacity Building Foundation

Impact of FDI vs. Foreign Aid on Economic Growth: A Comparative Study of Four Developing Regions
Evelyn Wamboye, Pennsylvania State University; **Rajarshi Mitra**, Kyushu University

Erasing Class/(re)Creating Ethnicity: Politics, Jobs and Identity in Kenya
Mwangi wa Githinji, University of Massachusetts Amherst

<Saint James>

<Saturday, March 10 9:45-11:00 a.m.>

[G11] COMPENSATION, DISABILITY, AND PENSION

Session Chair: **James Peoples**, University of Wisconsin-Milwaukee

Army Personnel Issues
Dean Dudley, United States Military Academy

Privatization's Influence on Non-Wage Compensation
James Peoples, University of Wisconsin-Milwaukee; **Bin Wang**, St. Edward's University

Discussion amongst participants

<Stanhope>

<Saturday, March 10 9:45-11:00 a.m.>

[G14] FDI, PRODUCTIVITY AND GROWTH (JEL Code F)

Session Chair: **Hong Zhuang**, Indiana University South Bend

Modes of Foreign Entry and Regional Economic Growth: Evidence from US States
Hong Zhuang, Indiana University South Bend

The (Non-) Resiliency of Foreign Direct Investment in the United States during the 2007-2009 Financial Crisis
Pierangelo De Pace, Pomona College

Credit vs. demand-constrained investment: the determinants of US fixed investment over the business cycles from 1977 to 2011
Christian Schoder, The New School for Social Research

Discussion amongst participants

<Longfellow>

<Saturday, March 10 9:45-11:00 a.m.>

[G15] FACTORY PRODUCTIVITY, FDI, AND THE DEVELOPING NATIONS (JEL Code O)

Foreign Direct Investment, Entry Barriers and Total Factor Productivity in Developing Countries
Firat Demir, University of Oklahoma; **Li Su**, University of Oklahoma

Iraq as Number One?: Constraints on Economic Growth and Political Stability in a Post-conflict Petroleum State
Frank Gunter, Lehigh University

Raw Material Endowments, Labor-Force Quality and FDI Flows in Sub-Saharan Africa
Kelfala Kallon, University of Northern Colorado

How should MDG success and failure be judged: faster progress or achieving the targets?
Joshua Greenstein, The New School for Social Research; **Sakiko Fukuda-Parr**, The New School for Social Research

Discussion amongst participants

<Copley>

<Saturday, March 10 9:45-11:00 a.m.>

[G16] TEACHING ECONOMICS: EFFECTIVE LEARNING AND OUTCOMES (JEL Code A)

Session Organizer and Chair: **Mary H. Lesser**, Lenoir-Rhyne University and Emeritus, Iona College

The International Experience
Natalia Smirnova, Mount Saint Vincent [natalia.smirnova@mountsaintvincent.edu]

Experiments Outside the Classroom
Mary H. Lesser, Lenoir-Rhyne University and Emeritus, Iona College [mary.lesser@lr.edu]

Use of Media in Teaching Economics
Caitlin Greatrex, Iona College [cgreatrex@iona.edu]

Discussion among presenters and with audience

<Holmes>

<Saturday, March 10 9:45-11:00 a.m.>

[G17] CONSUMER CREDIT (JEL Code G)

Session Chair: **James Murtagh**, Siena College

An Empirical Consumer Delinquency Model

Jane Yoo, George Washington University

The Jungle of the Studies on Credit Cards: A Survey in Economics Literature

Haitao Liang, CUNY

Discussants: **Pingkang Yu**, George Washington University; **Patrick Stephan**, University of Muenster

<Cabot>

<Saturday, March 10 9:45-11:00 a.m.>

[G18] HEALTH AND TAXES (JEL Code E)

Voting for Health: the Effect of Changing Demographics on the Choice of Capital and Labour Taxes

Katerina Koka, Brock University

Effect of Income Elasticity on MDG Health Indicators: The Case of MENA Countries

Noha Emara, Barnard College, Columbia University; **Rebecca Moore**, Barnard College, Columbia University

Market Design when Firms Interact with Inertial Consumers: Evidence from Medicare Part D

Keith Ericson, Boston University

Discussion amongst participants

<Cambridge>

<Saturday, March 10 9:45-11:00 a.m.>

[G19] TOPICS IN FORENSIC ECONOMICS III

The Third of Four Sessions Sponsored by the National Association of Forensic Economics

<Constitution>

<Saturday, March 10 1:00-2:15 p.m.>

[H1] FISCAL POLICY AT THE CROSSROADS: INTERNATIONAL RESPONSES DURING AND FOLLOWING THE FINANCIAL CRISIS

Session Organizer: **Mario Seccareccia**, University of Ottawa

Session Chair: **Thomas Ferguson**, University of Massachusetts at Boston

Reorienting Fiscal Policy: Lessons from Stabilization Efforts in the US during the Great Recession

Pavlina Tcherneva, Franklin and Marshall College

UK Fiscal Policy in the "Great Recession": How the Promising Start Went Badly Wrong

Giuseppe Fontana and **Malcolm Sawyer**, Leeds University

Public Expenditure and the Financial Crisis in Latin American Countries

Eugenia Correa, Universidad Nacional Autónoma de México

Did Chronic Fiscal Surpluses Save Canada from More Severe Consequences of the Financial Crisis? An Analysis of Canadian Fiscal Policy before and during the Great Recession

Mario Seccareccia, University of Ottawa

Discussion amongst participants

<Gloucester>

<Saturday, March 10 1:00-2:15 p.m.>

[H2] HOW TO BRING JOY INTO ECONOMICS- REVISITING TIBOR SCITOVSKY: PART 1

Session Organizer: **Maurizio Pugno**, University of Cassino

Session Chair: **Marina Bianchi**, University of Cassino

Education and happiness

Francesco Ferrante, University of Cassino (f.ferrante@caspur.it)

A Scitovskyian theory of well-being: from comfort to creativity

Maurizio Pugno, University of Cassino (m.pugno@unicas.it)

Income inequality in a Joyless economy

Maurizio Franzini, University of Rome (maurizio.franzini@uniroma1.it)

<Winthrop>

<Saturday, March 10 1:00-2:15 p.m.>

[H3] MACROECONOMIC POLICY SPACE III

Session organizers: **Esteban Pérez-Caldentey** and **Matías Vernengo**

Session Chair: **Esteban Pérez Caldentey**

Income Distribution, Financialization and Growth in Mexico,
Blanca Lilia Avendaño Vargas, BUAP (Mexico), **Juan Alberto Vázquez Muñoz**, BUAP (Mexico),
Ignacio Perrotini Hernández, UNAM (Mexico)

No day of reckoning? Adjustment and current account imbalances in dollarized countries of Latin America
Eloy Fisher, The New School

The Great Moderation and the Burdens of Adjustment
Nathan Perry, Mesa State University; **Nathaniel Cline**, University of Utah

Discussion among participants

<Thoreau>

<Saturday, March 10 1:00-2:15 p.m.>

[H4] LABOR MARKETS, MIGRATION, AND HEALTH

The Third of Five sessions sponsored by the Committee on the Status of Women in the Economics Profession (CSWEP)

Session Chair: **Angela Dills**, Providence College

The Effect of Sexual Violence on Earnings
Jeff DeSimone, University of Texas-Arlington; **Joseph J. Sabia**, San Diego State University

Is the Significance of Gender Really Declining in the U.S.?- a PSID Gender Pay Gap evidence over 1984 – 2005

Kusum Mundra, Rutgers University-Newark

Sexual Orientation and Young Adult Earnings: New Evidence from Add Health
Joseph J. Sabia, San Diego State University

Drinking and Wages Revisited
Resul Cesur, University of Connecticut

Discussants: **Muzhe Yang**, Lehigh University; **Sabrina Terrizzi**, Lehigh University; **Hope Corman**, Rider University; **Kusum Mundra**, Rutgers University-Newark

<Stuart>

<Saturday, March 10 1:00-2:15 p.m.>

[H5] ETHICS AND ECONOMICS

The Fourth of Four sessions sponsored by the Association for Social Economics (ASE)

Session Organizer and Chair: **Mark D. White**, College of Staten Island

Virtues and Moral Duties Realized: Volunteering and Corporate Social Responsibility

Yevgeniya Ovsienko, Sabanci University

The Human Body as Collateral: Are the Poor More Susceptible to Bio-Exploitation?

Cristina Richie, Boston College

Can Price Affect Principled Moral Behavior?

Mark D. White, College of Staten Island

Discussion amongst participants

<Franklin>

<Saturday, March 10 1:00-2:15 p.m.>

[H6] CAPITAL AND OPEN ECONOMIES

Session Organizer and Chair: **Giandomenico Sarolli**, Drew University

Financial Transaction Taxes and Trading Volume

Giandomenico Sarolli, Drew University

Monetary Rules and Sectoral Unemployment in Open Economies

William Craighead, Wesleyan University

Determinants of capital flows

Ergys Islamaj and Trung Bui, Vassar College

Discussants: **Giandomenico Sarolli**, Drew University; **William Craighead**, Wesleyan

University; **Ergys Islamaj**, Vassar College

<White Hill>

<Saturday, March 10 1:00-2:15 p.m.>

[H7] CREDIT MARKETS AND INEQUALITY (JEL Code E)

Session Chair: **Robert Scott**, Monmouth University

Credit Market Imperfection, Income Inequality, and Individual Happiness

George Vachadze, College of Staten Island

Income Distribution and Consumer Debt: Macroeconomics of Keeping-Up with Jones

Yun Kim, Trinity College

Debt-Poor Kids

Robert Scott, Monmouth University

Discussion amongst participants

<Whittier>

<Saturday, March 10 1:00-2:15 p.m.>

[H8] CIRCUIT OF CAPITAL MODEL

The Eighth of Eighteen Sessions Sponsored by the Union for Radical Political Economics (URPE)

Session Organizers: **Xiao Jiang**, The New School for Social Research; **Iren Levina**, University of Massachusetts Amherst

Session Chair: **Iren Levina**, University of Massachusetts Amherst

Comparative Growth Dynamics in a Discrete-time Marxian Circuit of Capital Model

Deepankar Basu, University of Massachusetts Amherst

Credit, Profitability and Instability: A Dynamic, Structural Approach

Paulo L dos Santos, School of Oriental and Africa Studies

Scheme of Expanded Reproduction with Centralized Banking System: An Agent Based Simulation

Xiao Jiang, The New School for Social Research

Discussion amongst participants

<Charles River>

<Saturday, March 10 1:00-2:15 p.m.>

[H9] WAGE INEQUALITY AND SKILL DIVERSIFICATION (JEL Code J)

Session Chair: **Kameshwari Shankar**, City College of New York

Skill- Obsolescence and Flat Hierarchies: Creating Incentives for Skill-Diversification

Kameshwari Shankar, City College of New York

[https://editorialexpress.com/cgi-](https://editorialexpress.com/cgi-bin/conference/conference.cgi?action=paper&subaction=info&info3=234)

[bin/conference/conference.cgi?action=paper&subaction=info&info3=234](https://editorialexpress.com/cgi-bin/conference/conference.cgi?action=paper&subaction=info&info3=234) Extending the inequality decomposition method proposed by Mookherjee and Shorrocks (1982): Wage Inequality in Japan, 1992-2002

Masao Yamaguchi, Osaka University of Economics

Discussion amongst participants

<Emerson>

<Saturday, March 10 1:00-2:15 p.m.>

[H10] “WAR ON DRUGS” IN MEXICO AND SMOKING ADDICTION IN THE U.S.: SOCIAL CASUES AND FISCAL EFFECTS

Session Chair: **Eduardo Oreggia**, ITESM CEM

Is Smoking a Fiscal Good?

Shantanu Bagchi, Georgia Southern University; **James Feigenbaum**, Utah State University

Structural factors and the “War on Drugs” effects on the upsurge in homicides in Mexico

Eduardo Oreggia, ITESM CEM

Discussants: **Justin Svec**, College of the Holy Cross

<Saint James>

<Saturday, March 10 1:00-2:15 p.m.>

[H11] LABOR FORCE PARTICIPATION

Session Chair: **Yanan Chen**, Rollins College

Labor Supply and Pyramid Schemes - Evidence from a Class Action Settlement

Stacie Bosley, Hamline University

Expected Lifetime Labor Force Participation: Explaining the Differential in Male-Female College Attendance Rates

Yanan Chen, Rollins College; **Solomon Polachek**; **Vikesh Amin**, Binghamton University

Has the Beveridge Curve Shifted? Evidence from Japan

Scott Fuess, Jr., University of Nebraska

Empowering Women with Micro Credit: Is it a Myth or a Reality?

Alema Karim, Rhode Island College

Discussion amongst participants

<Stanhope>

<Saturday, March 10 1:00-2:15 p.m.>

[H14] THEORY OF INTERNATIONAL TRADE II (JEL Code F)

Session Chair: **Young-Ham Kim**, Sungkyunkwan University

Trade War out of Fear

Young-Han Kim, Sungkyunkwan University

Peace Dividends in a Trade-theoretic Model of Conflict

Valerica Vlad, Penn State Erie

A critical revision of the empirical literature on Chinese outward investment: a more straightforward proposal

Ricardo Bustillo, University of the Basque Country; Carlos Rodriguez, University of the Basque Country

Discussion amongst participants

<Longfellow>

<Saturday, March 10 1:00-2:15 p.m.>

[H15] AGENT-BASED MODELS OF INNOVATION AND ECONOMIC GROWTH (JEL Code O)

An Agent-Based Model of Schumpeterian Competition

Alessandro Caiani, University of Pavia

Just deserts: merit and fortune in the Sugarscape

Karl Seeley, Hartwick College

Discussion amongst Participants

<Copley>

<Saturday, March 10 1:00-2:15 p.m.>

[H16] HISTORY OF ECONOMIC THOUGHT (JEL Code B)

Session Chair: **Guy Numa**, State University of New York at Stony Brook

The Chicago Counter-revolution and the Loss of the Classical Liberal Tradition

Craig Freedman, Middlebury College

How Adam Smith Became a Caricature: An Opening Exploration

Don Mathews, College of Coastal Georgia

Method, Structure, and Policy, the Pillars of Adolph Lowe's Political Economics: A Contribution to the Current Debate

Michael J. Murray, Bemidji State University

Discussion amongst participants

<Holmes>

<Saturday, March 10 1:00-2:15 p.m.>

[H17] INTERNATIONAL FINANCIAL MARKET (JEL Code G)

Session Chair: **Patrick Stephan**, University of Muenster

How far do shocks move across borders? Examining volatility transmission in major agricultural futures markets

Manuel Hernandez, IFPRI; **Raul Ibarra**, Banco de Mexico; **Danilo Trupkin**, Universidad de Montevideo

Testing Uncovered Interest Rate Parity using LIBOR

Muhammad Omer, University of Groningen

Microfinance Institutions in Central Asia: The Case of Tajikistan and Uzbekistan

Manijeh Sabi, The Sage Colleges

Discussants: **Sourav Batabyal**, SUNY Fredonia; **Yun Wang**, University of Pittsburgh; **James Murtagh**, Siena College

<Cabot>

<Saturday, March 10 1:00-2:15 p.m.>

[H18] MONETARY POLICY (JEL Code E)

Session Chair: **Yavuz Yasar**, University of Denver

Unlikely Estimates of the Ex Ante Real Interest Rate: Another Dismal Performance from the Dismal Science

Lee Spector, Ball State University; **Courtenay Stone**, Ball State University

Monetary Policy under Leviathan Currency Competition

Parag Waknis, University of Massachusetts Dartmouth

Mismatch and Monetary Policy

Timothy Bian, Georgetown University; **Pedro Gete**, Georgetown University

Discussants: **Marzi Bolhassani**, Penn State Hazleton; **John Heim**, Rensselaer Polytechnic Institute; **Ayla Ogus Binatli**, Izmir University of Economics

<Cambridge>

<Saturday, March 10 1:00-2:15 p.m.>

[H19] TOPICS IN FORENSIC ECONOMICS IV

The Third of Four Sessions Sponsored by the National Association of Forensic Economics

<Constitution>

<Saturday, March 10 2:30-3:45 p.m.>

[I1] MACROECONOMIC IMPLICATIONS OF TECHNOLOGICAL CHANGE AND SKILL FORMATION

Session Organizer and Chair: **Constantine Alexandrakis**, Hofstra University

Diffusion of General Purpose Technologies: Trade and Growth Implications

Iordanis Petsas, University of Scranton (petsasi2@scranton.edu)

The IT Revolution and Matching Efficiency in the U.S. Labor Market

Constantine Alexandrakis, Hofstra University (Constantine.alexandrakis@hofstra.edu)

Endogenous Economic Institutions, Wage Inequality, and Economic Growth

Christos Pargianas, University of Scranton (pargianasc2@scranton.edu)

Discussants: **Constantine Alexandrakis**, Hofstra University; **Christos Pargianas**, University of Scranton; **Iordanis Petsas**, University of Scranton

<Gloucester>

<Saturday, March 10 2:30-3:45 p.m.>

[I2] HOW TO BRING JOY INTO ECONOMICS- REVISITING TIBOR SCITOVSKY: PART 2

Session Organizer: **Maurizio Pugno**, University of Cassino

Session Chair: **Maurizio Franzini**, University of Rome

Multiple job, work pleasantness, and economic growth

Alessio Emanuele Biondo, **Maurizio Caserta**, and **Andrea Consoli**, University of Catania (caserta@unict.it)

Curiosity

Marina Bianchi, University of Cassino (marina.bianchi@caspur.it)

<Winthrop>

<Saturday, March 10 2:30-3:45 p.m.>

[I3] STRUCTURALIST VIEWS ON MACROECONOMIC POLICY

Session Chair: **Lance Taylor**, New School for Social Research

Fiscal Deficits, Economic Growth and Government Debt in the USA

Lance Taylor, New School for Social Research; **Christian Proaño**, New School for Social Research; **Laura de Carvalho**, New School for Social Research; **Nelson Barbosa**, Federal University of Rio de Janeiro and Ministry of Finance of Brazil

To devalue or not to devalue: a heterodox question

Nelson Barbosa, Federal University of Rio de Janeiro and Ministry of Finance of Brazil

Macroeconomics of redistribution in the USA

Lance Taylor, New School for Social Research; **Armon Rezai**, New School for Social Research; **Laura de Carvalho**, New School for Social Research

Sustaining wages vs. sustaining growth? Avoiding another open economy dilemma.

Massimiliano La Marca, International Labor Organization

Discussants: **Massimiliano La Marca**, University of Utah; **Laura de Carvalho**, New School for Social Research; **Nelson Barbosa**, Federal University of Rio de Janeiro and Ministry of Finance of Brazil; **Armon Rezai**, Vienna University of Economics and Business

<Thoreau>

<Saturday, March 10 2:30-3:45 p.m.>

[I4] EDUCATION AND HEALTH

The Fourth of Five sessions sponsored by the Committee on the Status of Women in the Economics Profession (CSWEP)

Session Chair: **Donka Mirtcheva**, The College of New Jersey

Life Expectancy and Education

Resul Cesar, University of Connecticut; **Erdal Tekin**, Georgia State University

Charter Schools and Parental Time Use

Angela Dills, Providence College

The Effect of Anti-Smoking Policy on Birth Outcomes: The Relative Effects of Cigarette Taxes and Smoking Bans

Jia Gao and Reagan Baughman, University of New Hampshire

The Effect of Educational Attainment on Intranational Migration in the Context of Development: The Case of Vietnam

Anita Alves Pena, Colorado State University; **Robert Kling**; **Le Thanh Thuy**

Discussants: **Shin Yi Chou**, Lehigh University; **Laura Argys**, University of Colorado-Denver; **Tianyan Hu**, Lehigh University; **Angela Dills**, Providence College

<Stuart>

<Saturday, March 10 2:30-3:45 p.m.>

[I5] MONETARY POLICY AND INFLATION

Session Organizer and Chair: **Julie Smith**, Lafayette College

Inflation Persistence

Ed Gamber, Lafayette College; **Jeffery Liebner**, Lafayette College; **Julie Smith**, Lafayette College

Do FOMC Minutes Matter to Markets? An Intraday Analysis of FOMC Minutes Releases on Individual Equity Volatility

Marc Tomljanovich, Drew University

The Changing Transmission Mechanism of US Monetary Policy

Norhana Endut, Central Bank of Malaysia; **James Morely**, University of South Wales; **Pao-Lin Tien**, Wesleyan University

Changes in the Cross-Sectoral Synchronization of Shocks and the Great Moderation

Edward N. Gamber, Lafayette College; **Michael Kelly**, Lafayette College

Discussants: **Cynthia Bansak**, St. Lawrence University; **Fabia Gumau-Brisa**, Federal Reserve Bank of Boston; **Ed Gamber**, Lafayette College; **Julie Smith**, Lafayette College

<Franklin>

<Saturday, March 10 2:30-3:45 p.m.>

[I6] AGENT-BASED COMPUTATIONAL ECONOMICS: DECISION-MAKING, FIRMS, AND NETWORKS

The Third of Four sessions sponsored by the NYC Computational Economics & Complexity Workshop

Session Organizer and Chair: **Christopher S. Ruebeck**, Lafayette College

Muddling through the Gales of Creative Destruction: A Non-Equilibrium Computational Model of Schumpeterian Competition

Myong-Hun Chang, Cleveland State University

Evaluating Case-based Decision Theory: Predicting Patterns of Human Classification Learning
Andreas Duus Pape, Binghamton University; **Kenneth Kurtz**, Binghamton University

An Agent-Based Model of Network Oligopolies

David Dixon, University of New Mexico

Consumer Search and Oligopoly Outcomes
Christopher S. Ruebeck, Lafayette College

Discussants: **Jason Barr**, Rutgers University; **Alan Isaac**, American University; **Heath Henderson**, American University; **Shu-Heng Chen**, National Chengchi University

<White Hill>

<Saturday, March 10 2:30-3:45 p.m.>

[17]

<Whittier>

<Saturday, March 10 2:30-3:45 p.m.>

[18] TOPICS IN THEORETICAL POLITICAL ECONOMY

The Ninth of Eighteen Sessions Sponsored by the Union for Radical Political Economics (URPE)

Session Organizers: **Iren Levina**, University of Massachusetts Amherst; **Xiao Jiang**, The New School for Social Research

Session Chair: **Xiao Jiang**, The New School for Social Research

An Agent-Based Approach to Classical-Marxian Value Theory and Labor Mobility
Jonathan Cogliano, The New School for Social Research

Transactions Flow Matrices of Monetary Circuit Model
Hyun Woong Park, University of Massachusetts Amherst

Mark-up Pricing and the Origins of Profit: A Critique of Kaleckian Pricing Theory
Fernando Rugitsky, The New School for Social Research

Political Economy of Capital Gains: Through the Lens of Two Sets of Prices of Capital Goods
Iren Levina, University of Massachusetts Amherst

Discussion amongst participants

<Charles River>

< Saturday, March 10 2:30-3:45 p.m.>

[19] INTERNATIONAL FINANCIAL ISSUES IV (JEL Codes F, G)

Session Organizer and Chair: **Theologos Homer Bonitsis**, New Jersey Institute of Technology (bonitsis@adm.njit.edu)

Short-run Dynamics and Long-run Equilibrium Relationship Between the U.S. Dollar Index, S&P 500 Stock Index, U.S. Corporate Bond Yields, and Crude Oil Prices.

Krishna M. Kasibhatla, North Carolina A&T State University (kmkasibh@ncat.edu)

The New Chinese Economy: Global Implications

Elias C. Grivoyannis, Yeshiva University (grivoyan@yu.edu)

Valuation Model for a Second Hand Tanker Vessel: An Econometric Approach

Eleftherios Thalassinos, University of Piraeus (thalassi@unipi.gr); **Evangelos Politis**,
University of Piraeus (evpoliti@uth.gr)

<Emerson>

<Saturday, March 10 2:30 p.m.>

[I10] HOUSEHOLDS AND ASSET ALLOCATION

Session chair: **Marya Hillesland**, American University; **Marit Widman**, Swedish University of Agricultural Sciences, Sweden

Papers:

Gender-based differences in risk behavior and asset allocation decisions in Ghana Author:
Marya Hillesland , American University (mh6533a@student.american.edu)

How well have social protection schemes in Chile reduced household vulnerability?

Javier Bronfman, American University and Universidad Adolfo Ibanez, Chile
(bronzman@netline.cl); **Maria Floro**, American University (mfloro@american.edu)

How joint property rights to land empowers women in Peruvian peasant communities

Henrik Wiig (henrik.wiig@nibr.no) & **Daniela Orge-Fuentes** (daniela.fuentes@nibr.no),
Department of International Studies Norwegian Institute of Urban and Regional Research,
Norway

Intrahousehold bargaining over land rights in Madagascar

Marit Widman, Swedish University of Agricultural Sciences, Sweden

Discussants: **Marya Hillesland**, American University; **Marit Widman**, Swedish University of Agricultural Sciences, Sweden; **Javier Bronfman**, American University and Universidad Adolfo Ibanez, Chile; **Maria Floro**, American University; **Henric Wiig**, Department of International Studies Norwegian Institute of Urban and Regional Research, Norway; **Daniela Oerge-Fuentes**, Department of International Studies Norwegian Institute of Urban and Regional Research, Norway

<Saint James>

<Saturday, March 10 2:30-3:45 p.m.>

[I11] LABOR AND CAPITAL

Session Chair: **Andrew Anderson**, University of Wisconsin-Madison

Specialization, Learning Ability and Labor Market Outcomes: Training versus Academics
Andrew Anderson, University of Wisconsin-Madison

The Changes in Work-Related Training Patterns of Foreign- versus US-Born Workers since 1990

Youngok Lim, Drew University

In-House R&D and Production Outsourcing: When Good is Not Enough
Aaron Finkle, California State University San Marcos

Capital Adjustments Patterns: An Empirical Investigation at Plant Level
Pinar Celikkol Geylani, Duquesne University

Discussion amongst participants

<Stanhope>

<Saturday, March 10 2:30-3:45 p.m.>

[I14] EXCHANGE RATE FORECASTING (JEL Code F)

Session Chair: **Andre Neveu**, James Madison University

Survey-Based Forecasts as Predictors of Future Spot Exchange Rates
Nevin Cavusoglu, James Madison University; **Andre Neveu**, James Madison University

Is It An Exchange Rate Risk Premium?: Allowing for Piece-Wise Linearity
Olesia Kozlova, University of New Hampshire

Discussion amongst participants

<Longfellow>

<Saturday, March 10 2:30-3:45 p.m.>

[I15] RESEARCH AND DEVELOPMENT AND GROWTH (JEL Code O)

Cooperative R&D, Distance to Frontier, and Growth Convergence
Yibai Yang, University of Sydney

Does Licensing Induce Technological Spillovers to Domestic Firms?

Luis Castro Penarrieta, University of Colorado

Discussion amongst Participants

<Copley>

<Saturday, March 10 2:30-3:45 p.m.>

[I16] ECONOMETRIC FORECASTING (JEL Code B)

Session Chair: **Fong-Ling Chu**, National Taiwan University

An Application of Two-Stage Model to Monthly Tourism Demand Forecasting

Fong-Lin Chu, National Taiwan University; **Wen-Hsiu Huang**, Ling Tung University

Monthly Indicator of Gross Fixed Capital Formation for South Africa: A State Space Model Approach

Nazeem Mustapha, Human Sciences Research Council

Discussion amongst participants

<Holmes>

<Saturday, March 10 2:30-3:45 p.m.>

[I17] INTERNATIONAL EQUITY MARKET (JEL Code G)

Session Chair: **Hong V. Nguyen**, University of Scranton

Does Institutional Ownership Matter for International Stock Return Comovement?

Jose Faias, Catolica Lisbon - School of Business and Economics; **Miguel Ferreira**, NOVA School of Business and Economics; **Pedro Matos**, University of Virginia; **Pedro Santa-Clara**, NOVA School of Business and Economics

Tail Dependence between Stock Index Returns and Foreign Exchange Rate Returns– a Copula Approach

Fangxia Lin, New York City College of Technology

Discussants: **Haito Liang**, CUNY; **Barkley Rosser**, James Madison University

<Cabot>

<Saturday, March 10 2:30-3:45 p.m.>

[I18] FINANCIAL CRISIS AND PERFORMANCE (JEL Code E)

Are all financial crisis created equal? An examination of the money market dependence during the Global Financial Crisis and Asian Financial Crisis

David Vera, California State University, Fresno; **Kazuki Onji**, Australian National University

Output relationships of China and India with the U.S.: How do the Asian giants respond to America?

Biru Paul, State University of New York at Cortland

Some Nonlinear Dynamics of Output, Fiscal Policy, and Distribution

Greg Hannsgen, Levy Economics Institute of Bard College

Discussants: **Sung-Eun Yu**, University of Utah; **Joshua Wilde**, University of South Florida; **Yavuz Yasar**, University of Denver

<Cambridge>

<Saturday, March 10 2:30-3:45 p.m.>

[I19] UNIONS (JEL Code J)

Session Chair: **Steven Shulman**, Colorado State University

The Relationship Between Faculty Union Membership, Worker Behavior and Job Satisfaction

Mark Gius, Quinnipiac University

Inter-State Industry Variations in Private Sector Union Density in the U.S.

Behroz Baraghoshi, University of Utah; **Cihan Bilginsoy**, University of Utah

Union Density and Cultural Cognition: A Cross-Sectional Analysis of States

Steven Shulman, Colorado State University; **Ian Breunig**, Colorado State University

Discussion amongst participants

<Constitution>

<Saturday, March 10 4:00-5:15 p.m.>

[J1] SOUTH-SOUTH ECONOMIC INTEGRATION AND DEVELOPMENT- SESSION 2

Session Organizers: **Omar Dahi**, Hampshire College (odahi@hampshire.edu); **Firat Demir**, University of Oklahoma (fdemir@ou.edu).

Session Chair: **Omar S. Dahi**, Hampshire College, (odahi@hampshire.edu).

Can Asia Sustain an Export-Led Growth Strategy in the Aftermath of the Global Crisis? An Empirical Exploration

Arslan Razmi, University of Massachusetts-Amherst (arazmi@econs.umass.edu); **Gonzalo Hernandez**, University of Massachusetts-Amherst (gonzalo@econs.umass.edu)

South-South Trade and Industrialization: The Case of African trade

Mwangi wa Githinji, University of Massachusetts-Amherst (mwangi@econs.umass.edu)

Preferential Trade Agreements and Manufactured Goods Exports: Does It Matter Whom You PTA With?

Firat Demir, University of Oklahoma (fdemir@ou.edu)

Discussants: **Mwangi wa Githinji**, Umass-Amherst (mwangi@econs.umass.edu); **Omar S. Dahi**, Hampshire College (odahi@hampshire.edu); **Kevin P. Gallagher**, Boston University (kpg@bu.edu)

<Gloucester>

<Saturday, March 10 4:00-5:15 p.m.>

[J2] THE EURO AND THE CURRENT ECONOMIC CRISIS (JEL Codes F, G)

Session Organizer and Chair: **Theologos Homer Bonitsis**, New Jersey Institute of Technology (bonitsis@adm.njit.edu)

The Future of the Euro

Luis Eduardo Rivera-Solis, Dowling College (rivalal@dowling.edu)

The Euro and the Sovereign Debt Crisis: An International Political Economy Approach

George Dafnos, University of Piraeus (gdfns@windoslive.com); **Eleftherios Thalassinis**, University of Piraeus (thalassi@unipi.gr)

The Euro and International Competitiveness: The Greek Experience

Theologos Homer Bonitsis, New Jersey Institute of Technology (bonitsis@adm.njit.edu)

<Winthrop>

<Saturday, March 10 4:00-5:15 p.m.>

[J3]

<Thoreau>

<Saturday, March 10 4:00-5:15 p.m.>

[J4] HEALTH OUTCOMES

The Fifth of Five sessions sponsored by the Committee on the Status of Women in the Economics Profession (CSWEP)

Session Chair: **Shin-Yi Chou**, Lehigh University

Breastfeeding and Adult Outcomes: Evidence from AddHealth

Resul Cesur, University of Connecticut; **Muzhe Yang**, Lehigh University; **Inas Rashad Kelly**, CUNY; **Joseph Sabia**, San Diego State University

They May Not Choose Abstinence: Do Parental Involvement Laws have Unforeseen Effects on Teen Sexual Behavior?

Susan Averett, Lafayette College; **Bisakha Sen**, University of Alabama, Birmingham

Medicare Part D and physician drug prescribing

Tianyan Hu, Lehigh University; **Shin-Yi Chou**, Lehigh University; **Sandra Decker**, CDC

Who is up-to-date? A national assessment of child immunization coverage, 1999-2009

Donka Mirtcheva, TCNJ

Do Mandatory Drug Substitution Laws Matter?

Chad Meyerhoefer; **Sabrina Terrizzi**, Lehigh University

Discussants: **Lucie Schmidt**, Williams College; **Joseph J. Sabia**, San Diego State University;

Karen Conway, University of New Hampshire; **Yang Wang**, Lafayette College; **Laura Argys**, University of Colorado-Denver

<Stuart>

<Saturday, March 10 4:00-5:15 p.m.>

[J5] BUSINESS CYCLES

Session Chair: **Stephen Kinsella**, University of Limerick

Determining Regional Economic Clusters: Moving Beyond Geographic Proximity

Logan Kelly, University of Wisconsin - River Falls; **Edinaldo Tebaldi**, Bryant University

Business Cycles Forecasting: A Market Oriented Approach

I-Ming Chiu, Rutgers University-Camden; **Bin Wang**, St. Edward's University

Labor Market Cycles and Business Cycles

Peter Summers, High Point University

Discussants: **Devaki Chandra**, Helen Kaushik Education Foundation; **Stephen Kinsella**, University of Limerick; **Robert Derrell**, Manhattanville College

<Franklin>

<Saturday, March 10 4:00-5:15 p.m.>

[J6] AGENT-BASED COMPUTATIONAL ECONOMICS: MACROECONOMICS

The Fourth of Four sessions sponsored by the NYC Computational Economics & Complexity Workshop

Session Organizer and Chair: **Alan G. Isaac**, American University

Developments in the Role of Agent-Based Modeling in Systemic Risk and Financial Market Regulation

Andre R. Neveu, James Madison University

Real Foundations of Financial Crisis

Mark Setterfield, Trinity College; **Bill Gibson**, University of Vermont

The Distribution of Land, Imperfect Markets, and Modern Agricultural Value Chains: An Agent-based Approach

Heath Henderson, American University

The Distribution and Duration of Wealth: Empirical Evidence and Agent-Based Models

Kevin Capehart, American University

Discussants: **German Creamer**, Stevens Institute of Technology; **Blake LeBaron**, Brandeis University; **Alan Isaac**, American University; **David Dixon**, University of New Mexico

<White Hill>

<Saturday, March 10 4:00-5:15 p.m.>

[J7] IN MEMORIAM: PIERANGELO GAREGNANI, 1930-2011- A ROUNDTABLE CELEBRATORY SESSION

The Seventeenth of Eighteen Sessions sponsored by the Union for Radical Political Economics (URPE)

Session Organizer: **Scott Carter**, The University of Tulsa

Chair: **Duncan Foley**

Sraffa's thought in the 1920s in light of Professor Garegnani's 'Turning Point' thesis

Andrés Lazzarini, CONICET-UBA, Argentina

On Professor Garegnani's vertically-integrated wage goods sector

Scott Carter, The University of Tulsa

Classics and Moderns: Pierangelo Garegnani and the revival of the Classical surplus approach

Gary Mongiovi, St. Johns University

Title TBA

Ed Nell, The New School for Social Research

Sraffa and Garegnani

Ajit Sinha, Indira Gandhi Institute of Development Research

Discussion amongst Participants and Audience

<Whittier>

<Saturday, March 10 4:00-5:15 p.m.>

[J8] International Development from Political Economic Perspectives

The Tenth of Eighteen Sessions Sponsored by the Union for Radical Political Economics (URPE)

Session Organizers: **Xiao Jiang**, The New School for Social Research; **Iren Levina**, University of Massachusetts Amherst

Session Chair: **Ellis Scharfenaker**

An Empirical Study of Marxian Exchange Rate

Hyun Woong Park, University of Massachusetts Amherst

The Political Economy of Economic Growth in Latin America

Luis Villanueva Martinez, The New School for Social Research

Regional Pooling of International Reserves: The Latin American Reserve Fund in Perspective

Luis Rosero, Fitchburg State University

Financialization and Corporate Investment in Korea after the Asian Financial Crisis

HeeYoung Shin, The New School for Social Research

Discussion amongst participants

<Charles River>

<Saturday, March 10 4:00-5:15 p.m.>

[J9] HOUSING MARKETS (JEL Code R)

Session Chair: **Ryan Gallagher**, Northeastern Illinois University

Current Use Property Taxation in Conserving New Hampshire Land: An Empirical Investigation Using Multiple Imputation

Darshana Udayanganie, University of New Hampshire; **Richard England**, University of New Hampshire

Estimating Local Redistribution Through Local School District Property Taxes

Ryan Gallagher, Northeastern Illinois University

Heterogeneity in the Neighborhood Spillover Effects of Foreclosed Properties

Lei Zhang, Edinboro University of Pennsylvania; **Tammy Leonard**, University of Texas at Dallas; **James Murdoch**, University of Texas at Dallas

Discussants: **Ryan Gallagher**, Northeastern Illinois University; **Darshana Udayanganie**, University of New Hampshire; **Christopher Johnson**, University of North Florida

<Emerson>

<Saturday, March 10 4:00-5:15 p.m.>

[J10] GLOBAL WARMING

Session Chair: **Zinnia Mukherjee**, Connecticut College

The Effect of Agricultural Practices on Global Methane and Nitrous Oxide Emissions

Risa Kumazawa; Duquesne University

A Compositional Data Analysis of the Effects of Hypoxia on Lobster Harvest in the Long Island Sound

Zinnia Mukherjee; Connecticut College

Modeling and Measuring the Impact of Climate: A Case Study of New England Ski Resorts

Laura Beaudin; University of New Hampshire

Discussants: **Zinnia Mukherjee**, Connecticut College; **Peter Schwarz**, UNC Charlotte

<Saint James>

<Saturday, March 10 4:00-5:15 p.m.>

[J11] LANGUAGE AND LEARNING

Session Chair: **Ying Zhen**, Clark University

English-Language Proficiency and Earnings of Foreign-Born Immigrants in the United States

Ying Zhen, Clark University

ARE WE WORKING AT THE SAME PLACE? Perceptions of workplace practices and labor retention in early care and education

Lynn Hatch, U.S. Coast Guard Academy

Gender Differences in Labor Market Outcomes for College Graduates in the STEM Fields
Alison Del Rossi, St. Lawrence University

Discussion amongst participants

<Stanhope>

<Saturday, March 10 4:00-5:15 p.m.>

[J14] INTERNATIONAL FINANCIAL ISSUES II (JEL Code F)

Session Chair: **Vikram Kumar**, Davidson College

Liquidity Risk and its Implications for Interest Parity Theory
Vikram Kumar, Davidson College

Time-Varying Financial Spillovers from the US to Frontier Markets
Galin Todorov, Florida International University; **Prasad Bidarkota**, Florida International University

Discussion amongst participants

<Longfellow>

<Saturday, March 10 4:00-5:15 p.m.>

[J15] HETERODOX APPROACHES TO ECONOMICS (JEL Code B)

Session Organizer: **Matías Vernengo**, University of Utah

Session Chair: **Richard Chapman**, Westminster College

The Enigma of India's Structural Dynamics
Suranjana Nabar-Bhaduri, Boston University

From Periphery to Center: US Growth and the Balance of Payments
Nathaniel Cline, University of Utah

Still your grandfather's IMF: Fiscal Policy, Capital Controls and the New IMF
Kirsten Ford, University of Utah; **Matías Vernengo**, University of Utah

The Role of the Investment Function in Long-Run Growth Models: Neo-Kaleckian Models in Retrospect and the Kaldorian Alternative
William McColloch, University of Utah

Discussion among participants

<Copley>

<Saturday, March 10 4:00-5:15 p.m.>

[J16]

<Holmes>

<Saturday, March 10 4:00-5:15 p.m.>

[J17] COMMODITY PRICE AND MARKET (JEL Code G)

Session Chair: **Haito Liang**, CUNY

Does Futures Speculation Destabilize Spot Prices? New Evidence for Commodity Markets
Patrick Stephan, University of Muenster

Commodity Price Speculation: Are there Nonlinear Bubbles?
Barkley Rosser, James Madison University

Discussants: **Jose Faias**, Catolica Lisbon - School of Business and Economics; **Robin Pope**,
University of Bonn

<Cabot>

<Saturday, March 10 4:00-5:15 p.m.>

[J18] JOBS, JOBS, JOBS (JEL Code E)

Session Chair: **Robert Scott**, Monmouth University

Where are the jobs in the United States for the future?
Devaki Chandra, Helen Kaushik Education Foundation

Financial Frictions, Small Firms and Jobless Recoveries
Michael Siemer, Boston University

Unemployment and accumulation: Links between the circuit of capital and unemployment
dynamics in the context of a Marxist based Macroeconomic model
Victor Kasper, Buffalo State College

Labor Heterogeneity, Skill-specific Productivity Shocks and Labor Market Volatility
Dongpeng Liu, UC Riverside

Discussants: **Robert Scott**, Monmouth University; **Bryce Kanago**, University of Northern Iowa

<Cambridge>

<Saturday, March 10 4:00-5:15 p.m.>

[J19] HEALTH AND WEALTH ISSUES (JEL Code I)

Session Chair: **Lenisa Chang**, University of Cincinnati

Testing For Rationality in Health Insurance Choice by Adults in the U.S.: A Panel-Like Error Component Mixed Logit Approach

Ibrahim Niankara, Oklahoma State University

Housing Wealth Effect on Health Spending of Elderly People: Evidence from PSID Data

Elwin Tobing, Azusa Pacific University

Does the Recent Financial Crisis Impact Health and Happiness?

Viktoria Dalko, Harvard University & Hult IBS

Domestic Medical Tourism: Fact or Fiction?

Shishu Zhang, University of the Incarnate Word

Discussion amongst participants

<Constitution>

<Sunday, March 11 8:15-9:30 a.m.>

[K1] ECONOMIC SYSTEMS

Session Organizer and Chair: **Natalia Smirnova**, College of Mount Saint Vincent

What economic policies do assassinations affect?

Wei Gao, Bloomsburg University of Pennsylvania

Remittance Flows and Economic Growth in Mexico: A Single Break Unit Root and Cointegration Analysis, 1970-2009

Miguel Ramirez, Trinity College

<Gloucester>

<Sunday, March 11 8:15-9:30 a.m.>

[K2] BUSINESS CYCLES AND PUBLIC LIBRARY USE IN THE U.S AND LOCAL POLITICAL CYCLES IN THE PHILIPPINES

Session Organizer: **Julio Huato**

Session Chair: **Gabriel Domingo**, UC Davis

Public Library Use Over the Business Cycle

Glenn Graham, SUNY Oswego

Political Cycles in Philippine Municipalities

Gabriel Domingo, UC Davis

Discussants: **Timothy Hubbard**, Texas Tech University; **Eduardo Oreggia**, ITESM CEM

<Winthrop>

<Sunday, March 11 8:15-9:30 a.m.>

[K3] CAUSES OF INEQUALITY IN DEVELOPING NATIONS

Session Chair: **Cem Oyvat**, University of Massachusetts

Agrarian Structures, Urbanization, and Inequality

Cem Oyvat, University of Massachusetts

Corruption, Financial Development, and Income Inequality: Evidence from Commonwealth Countries

Sourav Batabyal, State University of New York at Fredonia

Discussants: **Cem Oyvat**, University of Massachusetts; **Sourav Batabyal**, State University of New York at Fredonia

<Thoreau>

<Sunday, March 11 8:15-9:30 a.m.>

[K4] FERTILITY AND FEMALE LABOR SUPPLY

Session Chair: **Lisa Dettling**, University of Maryland

Twin Transitions

Anna-Maria Aksan, Fairfield University; **Shankha Chakraborty**, University of Oregon

Opting Back In: Home Internet Use and Female Labor Supply

Lisa Dettling, University of Maryland

Multi-Partnered Fertility and Child Support

Terry-Ann Craigie, Connecticut College

Maternal Education, Linkages and Child Nutrition in the Long and Short-run: Evidence from the Ethiopia Demographic and Health Sur

Wei-Chaio Huang, Western Michigan University; **Alemaheu Ambel**, Western Michigan University

Gender Gaps in State Unemployment Rates

Sunita Mondal; University of Pittsburgh

Discussants: **Terry-Ann Craigie**, Connecticut College; **Anna-Maria Aksan**, Fairfield University; **Lisa Dettling**, University of Maryland

<Stuart>

<Sunday, March 11 8:15-9:30 a.m.>

[K5] PRODUCTION AND COMPETITION

Session Chair: **Edinaldo Tebaldi**, Bryant University

How Substitutable are Fixed Factors in Production? Evidence from Pre-Industrial England

Joshua Wilde; University of South Florida

Competitiveness, growth and income distribution in a small economy

Jose Cordero; Universidad de Costa Rica

The Role of Inter vivos giving in General Equilibrium

Jane Yoo; George Washington University

Discussants: **George Vachadze**, College of Staten Island; **Timothy Bian**, Georgetown University; **Natsuki Arai**, Johns Hopkins University

<Franklin>

<Sunday, March 11 8:15-9:30 a.m.>

[K6] RUSSIAN CAPITALISM'S JURASSIC PARK: A CARICATURE OF US ECONOMY

Session Chair: **Ruslan S. Grinberg**, Russian Academy of Science (grinberg@inecon.ru)

Economic Sociodynamic: Russian Context

Alexander Ya. Rubinstein, Russian Academy of Science (arubin@aha.ru)

Russian Capitalism: Mutations of World Crisis Tendencies

Alexander V. Buzgalin, Moscow State University (buzgalin@mail.ru)

Russian and US Corporations: Comparative Analysis of Governance and Investments

Ruslan Dzarasov, Russian Academy of Sciences (dzarasovr@gmail.com)

Discussants: **David M. Kotz**, UMASS; **Neva Goodwin**, Boston

<White Hill>

<Sunday, March 11 8:15-9:30 a.m.>

[K7] SIMULATION EXPERIMENTS

Farmers, Bandits and Soldiers: A Generic System for Addressing Peace Agendas

Khalid Saeed, Worcester Polytechnic Institute

Self-Selection into Policy Relevant Field Experiments

Jonathan James, European University Institute

<Whittier>

<Sunday, March 11 8:15-9:30 a.m.>

[K8] POLITICAL ECONOMY APPROACHES TO MACROECONOMICS: EMPIRICAL STUDIES

The Eleventh of Eighteen Sessions Sponsored by the Union for Radical Political Economics (URPE)

Session Organizers: **Iren Levina**, University of Massachusetts Amherst; **Xiao Jiang**, The New School for Social Research

Session Chair: **Hyun Woong Park**

Class Struggle and Economic Fluctuations: VAR Analysis of the post-War U.S. Economy

Deepankar Basu, University of Massachusetts Amherst; **Ying Chen**, University of Massachusetts Amherst; **Jong-seok Oh**, University of Massachusetts Amherst

The Measurable Value Added of US Outputs: A Look at Turbulent Vibrations

Ellis Scharfenaker, The New School for Social Research

The Productivity-Unemployment Nexus of the US Economy: Short Run versus Long Run Effects

Johann Jaeckel, The New School for Social Research

Is the postwar US economy wage-led or profit-led? Some results from a Structural VAR analysis

Deepankar Basu, University of Massachusetts Amherst; **Leila Davis**, University of Massachusetts Amherst

Discussion amongst participants

<Charles River>

<Sunday, March 11 8:15- 9:30 a.m.>

[K9] TRADE POLICY AND ITS IMPACT (JEL Code F)

Session Chair: **Aleksandr Vashchilko**, KIMEP

[https://editorialexpress.com/cgi-](https://editorialexpress.com/cgi-bin/conference/conference.cgi?action=paper&subaction=info&info3=4)

[bin/conference/conference.cgi?action=paper&subaction=info&info3=4](https://editorialexpress.com/cgi-bin/conference/conference.cgi?action=paper&subaction=info&info3=4)Vertically Related Markets,
Tariffs, and Technology Adoption

Aleksandr Vashchilko, KIMEP

[https://editorialexpress.com/cgi-](https://editorialexpress.com/cgi-bin/conference/conference.cgi?action=paper&subaction=info&info3=48)

[bin/conference/conference.cgi?action=paper&subaction=info&info3=48](https://editorialexpress.com/cgi-bin/conference/conference.cgi?action=paper&subaction=info&info3=48)The Welfare Effects of the
Byrd Amendment

Nicoleta Iliescu, Iona College

[https://editorialexpress.com/cgi-](https://editorialexpress.com/cgi-bin/conference/conference.cgi?action=paper&subaction=info&info3=154)

[bin/conference/conference.cgi?action=paper&subaction=info&info3=154](https://editorialexpress.com/cgi-bin/conference/conference.cgi?action=paper&subaction=info&info3=154)Tariff Pass-through and
Market Structure

Rodney Ludema, Georgetown University; **Zhi Yu**, Shanghai University of Finance and
Economics

Discussants: **Rodney Ludema**, Georgetown University; **Aleksandr Vashchilko**, KIMEP;
Nicoleta Iliescu, Iona College

<Emerson>

<Sunday, March 11 8:15-9:30 a.m.>

[K10] MONEY, PRICES, AND EXCHANGE: PERSPECTIVES FROM THE HISTORY OF ECONOMIC THOUGHT

Session Chair: **Michael J. Murray**, Bemidji State University

Is there an Ideal Islamic Market? An Examination of Islamic Scripture in relation to Exchange,
Prices and Competition

Ayman Reda, Lebanese American University

“In God We Trust”: From the Bible to Thornton’s Paper Credit (A Reconstruction of the Making
of Monetary Theory)

Luis Veuthey, UNED

Jules Dupuit as a Monetary Economist

Guy Numa, State University of New York at Stony Brook

Discussants: **Ayman Reda**, Lebanese American University; **Luis Veuthey**, UNED; **Guy Numa**, State University of New York at Stony Brook

<Saint James>

<Sunday, March 11 8:15-9:30 a.m.>

[K11] INEQUALITY

Session Chair: **Alema Karim**, Rhode Island College

Left Behind: Trends in Earnings Inequality in the US, 1991 to 2009

Markus Schneider, University of Denver

Inequality and Horizontal Inequity in Education in Selected Low and Middle Income Countries

Satis Devkota, Wayne State University; **Mukti Upadhyay**, Eastern Illinois University

Inferences From a Dynamic Wealth Maximizing Particle System That Reproduces a Variety of Patterns in Income Statistics For the Causes of U.S. Labor Income Inequality (Variously Defined), 1961-2010

John Angle, Inequality Process Institute

Discussion amongst participants

<Stanhope>

<Sunday, March 11 8:15-9:30 a.m.>

[K14] TRADE LIBERIZATION (JEL Code F)

Session Chair: **Kishore Kulkarni**, Metropolitan State College of Denver

A Case Study: Impact of International Liberalization on the Indian Economy

Kishore Kulkarni, Metropolitan State College of Denver

GATS Mode 4 of WTO—is there a convergence of economic interests between labor-sending and labor-receiving countries to promote global labor mobility?

Caf Dowlah, CUNY-Queensborough College

Trade Liberalization, Price Dynamics, and Unemployment

Gihoon Hong, Indiana University South Bend

Discussion amongst participants

<Longfellow>

<Sunday, March 11 8:15-9:30 a.m.>

[K15] EXPORTERS, IMPORTERS AND INNOVATION

Session Chair: **Ricardo A. López**, Brandeis University (rlopez@brandeis.edu)

R&D Investment and Capital Imports

Andreas Moxnes, Dartmouth College (andreas.moxnes@dartmouth.edu)

Export Superstars: A Global Perspective

Caroline Freund, The World Bank; **Denisse Pierola**, The World Bank
(mpierola@worldbank.org)

Learning to Export and Export Processing Spillovers

Ana Fernandes, The World Bank; **Heiwai Tang**, Tufts University (heiwai.tang@tufts.edu)

Discussants: **Ben Li**, Boston College (benli36@gmail.com); **Deniz Civril**, Brandeis University
(dcivril@brandeis.edu); **Ricardo A. López**, Brandeis University (rlopez@brandeis.edu)

<Copley>

<Sunday, March 11 8:15-9:30 a.m.>

[K16] HUMAN BEHAVIOR

Session Chair: **James Marshall**, Muhlenberg College

Informal Norms and the Marginalization of Women in Less Developed Countries

Adel Abadeer, Calvin College

What Determines Happiness: Income or Attitude?

Madhu Mohanty, California State University

What Economics Needs to Learn from Anthropology

Pierre Lacour, New York University

<Holmes>

<Sunday, March 11 8:15-9:30 a.m.>

[K17] FINANCIAL CRISIS AND REGULATION (JEL Code G)

Session Chair: **Eric Doviak**, Brooklyn College

The Impact of the Recent Financial Crises and the Resulting Regulations on Bankers' Incentive Compensation

Rick Proctor, Siena College; **James Murtagh**, Siena College

A Minsky-Kindleberger Perspective on the Financial Crisis

Barkley Rosser, James Madison University

Estimating the Effects of SFAS 133 on Risk Management Behavior

Hong Nguyen, University of Scranton

Discussants: **Fangxia Lin**, New York City College of Technology; **Raul Ibarra**, Banco de Mexico; **Manijeh Sabi**, The Sage Colleges

<Cabot>

<Sunday, March 11 8:15-9:30 a.m.>

[K18] ENERGY (JEL Code E)

Causality Between Sectoral Renewable Energy Consumption and Economic Growth In The U.S.

Hung-pin Lin, Shu-Te University

What would Kaldor say about the impact of recent oil discovery on Brazil's prospects of balanced growth?

Leanne Ussher, Queens College CUNY; **Laura Ebert**, SUNY New Paltz

Discussion amongst participants

<Cambridge>

<Sunday, March 11 8:15-9:30 a.m.>

[K19] HEALTH AND WEIGHT ISSUES (JEL Code I)

Session Chair: **Joshua Berning**, University of Connecticut, Food Marketing Policy Center

Does Physician Advice Lead to Weight Loss?

Joshua Berning, University of Connecticut, Food Marketing Policy Center

Prescription Drug Use and Abuse: Theory and Policy Implications

Gabriele Camera, Purdue University; **Bryan Engelhardt**, College of the Holy Cross

Mother Pre-Pregnancy BMI, Weight Gain and Infant Health

Ji Yan, Appalachian State University

Discussion amongst participants

<Constitution>

<Sunday, March 11 9:45- 11:15 a.m.>

[L1] HETERODOX APPROACHES TO ECONOMICS

Session Organizer: **Matías Vernengo**, University of Utah

Session Chair: **Kirsten Ford**, University of Utah

Innovation and the Role of Equity Markets in Developing Countries

Chase DeHan, University of Utah

Business Cycles and Economic Growth in Argentina, Brazil and Mexico through the 20th century

Victor Manuel Isidro, University of Utah

Facing the Global Capitalist Crisis: Can Heterodox Economics Challenge the Dominant Pedagogy?

Hande Togrul, The Inclusion Center for Community and Justice; **Chiara Piovani**, University of Denver

Prerequisites for Sustainable Food Production: A Critique of Capitalist Agriculture

Johan Uribe, University of Utah

Discussion among participants

<Gloucester>

<Sunday, March 11 9:45- 11:15 a.m.>

[L2] LAND INEQUALITY, INSTITUTIONS, FINANCIAL SECTOR DEVELOPMENT AND ECONOMIC GROWTH

Session Organizer and Chair: **Chih Ming Tan**, Clark University

Financial Development, Exchange Rate Regimes and Productivity Growth

Dessislava Slavtcheva, Clark University

Money Doesn't Grow on Trees: How Institutions and Policies Shape Economic Growth

David Coyne, Boston Fed; **Chih Ming Tan**, Clark University

Failure to Launch? The Role of Land Inequality in Transition Delays

Andros Kourtellos, University of Cyprus; **Ioanna Stylianou**, University of Cyprus; **Chih Ming Tan**, Clark University

Discussants: **Chih Ming Tan**, Clark University; **Dessislava Slavtcheva**, Clark University;
David Coyne, Boston Fed

<Winthrop>

<Sunday, March 11 9:45- 11:15 a.m.>

[L3] HETERODOX APPROACHES TO ECONOMICS III

Session Organizer: **Matías Vernengo**

Session Chair: **Steve Bannister**, University of Utah

Inter-State and Industry Variations in Private Sector Union Density in the US
Behroz Baraghoshi, University of Utah

The theory of gluts and the leisure class: A Veblenian contribution
Necati Celik, University of Utah

Implied Economic Intuition and Stand-up Comedy
Luciano Pesci, University of Utah

Exploring the Utah Census of Parolees with Graphical Causal Models
Justin Polchlopek, University of Utah

Discussion among participants

<Thoreau>

<Sunday, March 11 9:45- 11:15 a.m.>

[L4] YOUTH, CRIME, AND POVERTY

Session Chair: **Edinaldo Tebaldi**, Bryant University

Is Income Growth in the United States Pro-Poor? A State Level Analysis
Edinaldo Tebaldi, Bryant University; **Jongsung Kim**, Bryant University

A Dynamic Model of Criminal Behavior of Youth
Yun-Shan Chan, Stony Brook University

Unbundling the Degree Effect in a Job Training Program for Disadvantaged Youth
Maria Bampasidou, University of Florida; **Carlos Flores**, University of Miami; **Alfonso Flores-Lagunes**, SUNY-Binghamton

Discussants: **Yun-Shan Chan**, Stony Brook University; **Maria Bampasidou**, University of Florida; **Edinaldo Tebaldi**, Bryant University

<Stuart>

<Sunday, March 11 9:45- 11:15 a.m.>

[L5]

<Franklin>

<Sunday, March 11 9:45- 11:15 a.m.>

[L6] ISSUES WITH LAND

Hazard, vulnerability and risk of disasters

Lopamudra Banerjee, New School for Social Research, The New School

The impact of the land tenure reform in Madagascar on women's control over land: evidence from Soavinandriana

Marit Widman, Swedish University of Agricultural Science

<White Hill>

<Sunday, March 11 9:45- 11:15 a.m.>

[L7] THE OCCUPY MOVEMENT AND ECONOMIC THEORY

The Eighteenth of Eighteen Sessions sponsored by the Union for Radical Political Economics (URPE)

Scott Carter

Paddy Quick

Julio Huato

<Whittier>

<Sunday, March 11 9:45- 11:15 a.m.>

[L8] RADICAL POLITICAL ECONOMY: THEORY AND APPLICATIONS

The Twelfth of Eighteen Sessions Sponsored by the Union for Radical Political Economics (URPE)

Session Organizers: **Xiao Jiang**, The New School for Social Research; **Iren Levina**, University of Massachusetts Amherst

Session Chair: **Fernando Rugitsky**

Making Sense of Financialization: Neoliberalism and the Feudalization of Capital

Rajesh Bhattacharya, South Asian University; **Ian J. Seda-Irizarry**, University of Massachusetts Amherst

Is a general theory of capitalist instability possible?

Özgür Orhangazi, Kadir Has University

To Explain Scholes' Puzzle – Concurrently on Marx's Theory on Essence and Internal Contradictions of Money and its Development in Modern Economy

Zhun Zhao, The New School for Social Research

The Coming Creative Revolution: A Second Nation-wide War by Villagers?

Yuanyuan Zhang, The New School for Social Research

<Charles River>

<Sunday, March 11 9:45- 11:15 a.m.>

[L9] LAW OF ECONOMICS (JEL CODE K)

Session Chair: **Mark D. White**, College of Staten Island

[https://editorialexpress.com/cgi-](https://editorialexpress.com/cgi-bin/conference/conference.cgi?action=paper&subaction=info&info3=193)

[bin/conference/conference.cgi?action=paper&subaction=info&info3=193](https://editorialexpress.com/cgi-bin/conference/conference.cgi?action=paper&subaction=info&info3=193)I'm a Lawyer, Not an Economist! A plea for plain language Law and Economics

Derek Yonai, Campbell University

New York State Law Enforcement Efficiency – a Data Envelope Analysis of 50 City Police Departments

Gregory DeAngelo, Rensselaer Polytechnic Institute; **Donald Vitaliano**, Rensselaer Polytechnic Institute; **Hannes Lang**, Rensselaer Polytechnic Institute

Discussants: **Yonai**, Campbell University; **Hannes Lang**, Rensselaer Polytechnic Institute

<Emerson>

<Sunday, March 11 9:45-11:15 a.m.>

[L10] EDUCATIONAL ATTAINMENT AND ECONOMIC GROWTH

Session Chair: **Ece Handan Guleryuz**, Florida International University

Social Class Structure and Political Economy of Public Education Spending

Ece Handan Guleryuz, Florida International University

Does an increase in the duration of primary schooling lead to higher earnings? Evidence from Kenya

Agesa Richard, Marshall University

Undergraduate Major, LSAT Score, and First-Year Law School Performance

Lisa Jepsen; University of Northern Iowa

Discussants: **Ece Handan Guleryuz**, Florida International University; **Agesa Richard**, Marshall University

<Saint James>

<Sunday, March 11 9:45-11:15 a.m.>

[L11] BIDDING, BARGAINING, AND LOSING

Session Chair: **David Kingsley**, UMI

Economic Modelling of Suicide When a Person's Income is at Risk
Tomoya Suzuki, Kansai University

How Much Wealth Did the Typical U.S. Family Lose in the Great Recession?
Jay Zagorsky, Center for Human Resource Research

On Bid Disclosure in OCS Wildcat Auctions
Nicolas Melissas, ITAM

Negotiation-proof correlated equilibrium
Nicholas Ziros, University of Cyprus

Discussion amongst participants

<Stanhope>

<Sunday, March 11 9:45-11:15 a.m.>

[L14] EXCHANGE RATE AND ITS IMPACT I (JEL Code F)

Session Chair: **Ilir Dinovic**, Fairfield University

The sustained decline of the United States dollar and shifts in Exchange Rate Arrangements
Ilir Dinovic, Fairfield University

Exchange Rate Pass-Through for Dynamic Strategic Pricing
Jui-Chi Huang, Penn State Berks

A Method for Separating Income & Substitution Effects of Exchange Rate Changes
John Heim, Rensselaer Polytechnic Institute

Discussion amongst participants

<Longfellow>

<Sunday, March 11 9:45-11:15 a.m.>

[L15] OMICRON DELTA EPSILON

Session Chair: **Michael Szenberg**, Pace University

Incentives, Innovation, and Impact: The Validity, Variability, and Value of Structured Finance
Beryl Chang (beryl.chang@nyu.edu), New York University

Default Propagation in a Financial Network: a Multidate Model
Larry Eisenberg (larry@riskengineer.com), New Jersey Institute of Technology

Structural Changes in the American Book Publishing Industry
Michael Szenberg (mszenberg@pace.edu), Pace University; **Lall B. Ramrattan** (lallram@netscape.net), University of California, Berkeley

Discussants: **Suren Kaushik**, Pace University

<Copley>

<Sunday, March 11 9:45-11:15 a.m.>

[L16] PRODUCTION, PRICING, AND MARKET STRUCTURE (JEL Code L)

Revealing Bargaining Power through Actual Wholesale Prices
Carlos Noton, University of Warwick

Exclusive Dealing and Its Effects: The Impact of Large Music Festival on Local Music Venues
Scott Hiller, University of Colorado – Boulder

Discussion amongst participants

<Holmes>

<Sunday, March 11 9:45-11:15 a.m.>

[L17] INSURANCE AND CREDIT RATING (JEL Code G)

Session Chair: **Manijeh Sabi**, The Sage Colleges

Insurance (AIG) at the Core of the Financial Meltdown Genuine Insurance Issuance: its Incompatibility with Competition and Expected Utility Theory its Compatibility with SKAT, the Stages of Knowledge Ahead Theory
Robin Pope, University of Bonn

Race to the Top: Credit Rating Bias from Competition

Yun Wang, University of Pittsburgh; **Yilan Xu**, University of Pittsburgh

Discussants: **Hong V. Nguyen**, University of Scranton; **Barkley Rosser**, James Madison University

<Cabot>

<Sunday, March 11 9:45-11:15 a.m.>

[L18] ECONOMIC BEHAVIOR (JEL Code E)

Dynamic Aggregation of Heterogeneous Interacting Agents and Network

Joseph Stiglitz, Columbia University; **Corrado Di Guilmi**, University of Technology, Sydney; **Mauro Gallegati**, Universita Politecnica delle Marche; **Simone Landini**, IRES Piemonte

Investment Composition and Productivity with Heterogeneous Entrepreneurs

Burak Uras, Tilburg University

Discussion amongst participants

<Cambridge>

<Sunday, March 11 9:45-11:15 a.m.>

[L19] SAFETY NETS AND PUBLIC HEALTH (JEL Code I)

Session Chair: **Garfield Blake**, Georgia Southern University

Does Regionalization of Local Public Health Services Influence Public Spending Levels and Allocative Efficiency?

Laurie Bates, Bryant University; **Rexford Santerre**, University of Connecticut

How Well have Social Protection Schemes in Chile Reduced Household Vulnerability?

Javier Bronfman, American University; **Maria Floro**, American University

Why Do Low-Income Urban Households Not Apply for Welfare Benefits? Evidence from the PATH of Jamaica

Garfield Blake, Georgia Southern University; **Godfrey Gibbison**, Georgia Southern University

Discussion amongst participants

<Constitution>

<Sunday, March 11 11:30-12:45 p.m.>

[M1] NEW FRONTIERS IN DEVELOPMENT FINANCE

Session Organizer: **Ghazal Zulfqar**, University of Massachusetts Boston

Session Chair: **Risa Takenaka**, University of Massachusetts Boston

Trends in Consumption Inequality from Three Decades of Household Surveys in India
Arjun Jayadev, University of Massachusetts Boston

South-South Financial Integration in the Light of Recent Experiences
Armagan Gezici, Keene State College

Financial Diversity, Economic Growth and Stability
Christian Weller and **Ghazal Zulfikar**, University of Massachusetts Boston

Discussants: **Andrew Perumal**, University of Massachusetts Boston; **Alvine Sangang**,
University of Massachusetts Boston

<Gloucester>

<Sunday, March 11 11:30-12:45 p.m.>

[M2] TAX COMPLIANCE IN DEVELOPING ECONOMIES

Session Organizer: **Julio Huato**

Session Chair: **Gabriela Aparicio**, The George Washington University

Tax Monitoring and Compliance: A Regression Discontinuity Approach in Ecuador
Gabriela Aparicio, The George Washington University; **Nicolás Oliva**, Centro de Estudios
Fiscales – SRI

Assessing Tax Fairness: The case of a Small Open Economy
Chrystol Thomas, Central Bank of Barbados

Discussants: **Yoav Wachsman**, Coastal Carolina University; **Gabriela Aparicio**, The George
Washington University

<Winthrop>

<Sunday, March 11 11:30-12:45 p.m.>

[M3] HETERODOX APPROACHES TO ECONOMICS IV

Session Organizer: **Matías Vernengo**

Why Can't They Feed Themselves Anymore? Structural Changes in Food Imports and Food
Production in Sub-Saharan Africa
Jean Arment, University of Utah

China, The Empire That Did Not Bark
Steve Bannister, University of Utah

The Irrelevance of Industrialization in the New International Division of Labor Order: The Case of Mexico

Blanca Lilia Avendaño Vargas, BUAP (Mexico); **Juan Alberto Vázquez Muñoz**, BUAP (Mexico)

Hegemonic Currencies during the Crisis: The Dollar versus the Euro in a Cartalist Perspective
David Fields, University of Utah; **Matías Vernengo**, University of Utah

Discussion among participants

<Thoreau>

<Sunday, March 11 11:30-12:45 p.m.>

[M4] PERSONALITY, RACE, AND DISCRIMINATION

Session Chair: **Brian Volz**, Assumption College

Sexual Orientation and Wage Discrimination in France: the Hidden Side of the Rainbow

Thierry Laurent, University Evry Val D'Essonne

Does Personality Matter in the Labor Market? Lessons from the United Kingdom

Xuelian Zhang, Rutgers University

Discussants: **Brian Volz**, Assumption College; **Thierry Laurent**, University Evry Val D'Essonne; **Xuelian Zhang**, Rutgers University

<Stuart>

<Sunday, March 11 11:30-12:45 p.m.>

[M5] MACROECONOMICS AND MEASUREMENT

Session Chair: **I-Ming Chiu**, Rutgers University-Camden

Reexamining the Macroeconomic Role of Money: A New Structural Approach Modeling Macroeconomic Shocks

Makram El-Shagi, Halle Institute for Economic Research; **Sebastian Giesen**, Halle Institute for Economic Research; **Logan Kelly**, University of Wisconsin - River Falls

Exchange Rate Volatility and Inflation-Inflation Uncertainty

Marzi Bolhassani, Penn State Hazleton

Using Forecast Evaluation to Improve Accuracy of The Greenbook Forecast
Natsuki Arai, Johns Hopkins University

Discussants: **David Vera**, California State University, Fresno; **Noha Emara**, Barnard College

<Franklin>

<Sunday, March 11 11:30-12:45 p.m.>

[M6]

<White Hill>

<Sunday, March 11 11:30-12:45 p.m.>

[M7]

<Whittier>

<Sunday, March 11 11:30-12:45 p.m.>

[M8] **GENDER AND ETHNICITY ISSUES IN THE DEVELOPING WORLD**

The Thirteenth of Eighteen Sessions Sponsored by the Union for Radical Political Economics (URPE)

Session Organizer and Chair: **Cem Oyvatt**, University of Massachusetts Amherst

What Shapes Variations in Rural Indian Women's Work? Agrarian Change versus the U-Hypothesis

Avanti Mukherjee, University of Massachusetts Amherst

Ethnic Wage Differentials in Pakistan's Labor Market

M. Rashid Memon, New School for Social Research

The Determinants of Job Mobility: İzmir as a Case Study

Hasan Tekgüç, Mardin Artuklu University; **Değer Eryar**, İzmir University of Economics

Discussion amongst participants

<Charles River>

<Sunday, March 11 11:30-12:45 p.m.>

[M9] **LOCAL ECONOMIC DEVELOPMENT CONSTRAINTS (JEL Code R)**

Session Chair: **Matt Saboe**, Lehigh University

[https://editorialexpress.com/cgi-](https://editorialexpress.com/cgi-bin/conference/conference.cgi?action=paper&subaction=info&info3=274)

[bin/conference/conference.cgi?action=paper&subaction=info&info3=274](https://editorialexpress.com/cgi-bin/conference/conference.cgi?action=paper&subaction=info&info3=274)Financial Deserts: Exploring the Determinants of Access to Financial Institutions within Jacksonville, FL

Christopher Johnson, University of North Florida

The Financial Impact of Oil Prices on the Housing Market in the Houston Economy

Rachel Ang, University of Phoenix; **Brian Sloboda**, US Postal Service

Politics, diversity and the distribution of federal disaster assistance

Richard Vogel, Farmingdale State College

Discussants: **Matt Saboe**, Lehigh University; **Rachel Ang**, University of Phoenix; **Mark**

[https://editorialexpress.com/cgi-](https://editorialexpress.com/cgi-bin/conference/conference.cgi?action=people&subaction=info&info2=kaz)

[bin/conference/conference.cgi?action=people&subaction=info&info2=kaz](https://editorialexpress.com/cgi-bin/conference/conference.cgi?action=people&subaction=info&info2=kaz) **Kazarosian**, Stonehill

College

<Emerson>

<Sunday, March 11 11:30-12:45 p.m.>

[M10] TESTING MODELS OF ECONOMIC GROWTH

Session Chair: **Gabriel Mendoza-Pichardo**, Universidad Nacional Autónoma de Mexico

Brazil and Mexico 1980-2010: two contrasting economic development under neo-liberalism policies and beyond

Adalmir Marquetti, PUCRS; **Gabriel Mendoza-Pichardo**, Universidad Nacional Autónoma de Mexico

Balance-of-Payments-Constrained Growth Empirics: testing Thirlwall's Law using nonstationary panel data techniques

Raphael Gouvea, Institute for Applied Economic Research; **Gilberto Tadeu Lima**, University of São Paulo

Discussants: **Raphael Gouvea**, Institute for Applied Economic Research; **Gabriel Mendoza-Pichardo**, Universidad Nacional Autónoma de Mexico

<Saint James>

<Sunday, March 11 11:30-12:45 p.m.>

[M11] INTERNATIONAL HEALTH AND POVERTY

Session Chair: **Megan Silbert**, Salem College

The Economic Impact of Heart Disease and Type 2 Diabetes Mellitus on Economic Growth in Selected Caribbean Countries

Marquitta Webb, University of the West Indies; **Daren Conrad**, Bowie State University

Repeated Natural Disaster and Poverty on Island Nations: A Decade of Evidence from Indonesia

Megan Silbert, Salem College; **Pilar Useche**, University of Florida

The social value of informal care provided to dependent people in Spain

Juan Oliva-Moreno, UCLM; **Cristina Vilaplana Prieto**, Universidad de Murcia; **Ruben Osuna**, UNED

The Stronger Sex? The Effects of Compulsory Schooling Reforms on Gender Differences in Disability Exit

Nabanita Datta Gupta, Aarhus School of Business and Social Sciences

Discussion amongst participants

<Stanhope>

<Sunday, March 11 11:30-12:45 p.m.>

[M14] FOREIGN AID (JEL Code F)

Session Chair: **Paul Ojeaga**, University of Bergamo

Does Aid Lead to Trade? A Sectoral Approach

Paul Ojeaga, University of Bergamo; **Michael Quinn**, Bentley University

Aid Effectiveness in Sub-Saharan Africa

Yaya Sissoko, Indiana University of Pennsylvania; **Niloufer Sohrabji**, Simmons College

Discussion amongst participants

<Longfellow>

<Sunday, March 11 11:30-12:45 p.m.>

[M15] EFFICIENCY, PROFITABILITY, AND MONETARY POLICY

Session Chair: **Stephen M. Miller**, University of Nevada, Las Vegas (stephen.miller@unlv.edu)

Efficiency in the Individual Life Insurance Business in India: A Company Level Analysis

Kankana Mukherjee, Babson College (kmukherjee@babson.edu); **Subhash C. Ray**, University of Connecticut (subhash.ray@uconn.edu); **Evangelia Desli**, Aristotle University of Thessaloniki (edesli@hotmail.com)

Liquidity Risk and Bank Efficiency: Evidence from the European Union

Emmanouel Mamatzakis, University of Sussex (E.Mamatzakis@sussex.ac.uk); **Alexia Ventouri**, University of Sussex (A.Ventouri@sussex.ac.uk)

Stock Market Returns and Monetary Policy: UK Evidence

Georgios E Chortareas, University of Athens, Greece (gchortar@econ.uoa.gr); **Emmanouil Noikokyris**, Kingston University (E.Noikokyris@kingston.ac.uk)

Firm Profitability: Mean-Reverting or Random-Walk Behavior?

Giorgio Canarella, California State University, Los Angeles (gcanare@calstatela.edu) and University of Nevada, Las Vegas (giorgio.canarella@unlv.edu); **Stephen M. Miller**, University of Nevada, Las Vegas (stephen.miller@unlv.edu); **Mahmoud M. Nourayi**, Loyola Marymount University (mnourayi@lmu.edu)

Discussion amongst participants

<Copley>

<Sunday, March 11 11:30-12:45 p.m.>

[M16] IMPERFECT MARKETS (JEL Code L)

Firm Corruption in the Presence of an Auditor

Michael Dietrich, University of Sheffield; **Julian McHardy**, University of Sheffield; **Abhijit Sharma**, Bradford University

Sequential Entry and Merger in Spatial Price Discrimination

Guangliang Ye, Renmin University of China

Hidden Costs of Offshore Outsourcing: An Analysis of offshoring decisions

Deeparghya Mukherjee, IIM Bangalore

Insurance Competition under Asymmetric Categorization: Evidence from the Washington Automobile Insurance Market

Kevin Shaver, Duquesne University

Discussion amongst participants

<Holmes>

<Sunday, March 11:30-12:45 p.m.>

[M17]

<Cabot>

<Sunday, March 11 11:30-12:45 p.m.>

[M18] FISCAL POLICY AND ECONOMIC GROWTH (JEL Code E)

Session Chair: **Jane Yoo**, George Washington University

Does Fiscal Policy Matter? Blinder and Solow Revisited

Dmitry Plotnikov, University Of California, Los Angeles; **Roger Farmer**, University of California, Los Angeles

Credit Constraints, Profitability and Animal Spirits in a Stock-Flow Consistent Model of Investment and Growth

Daniele Tavani, Colorado State University

Can Crowd Out Hamper Stimulus Programs in Recessions

John Heim, Rensselaer Polytechnic Institute

Discussants: **Jonathan Haughton**, Suffolk University; **Suvayan De**, West Virginia State University; **Jose Cordero**, Universidad de Costa Rica

<Cambridge>

<Sunday, March 11 11:30-12:45 p.m.>

[M19] EDUCATION (JEL Code I)

Session Chair: **Lauren Calimeris**,

Publishing Trends in Economics Across Colleges and Universities, 1991-2007

Anne Winkler, University of Missouri-St. Louis

Freshmen Retention Rates at US Regional Public Universities

Nicole Bissessar, Kent State University At Ashtabula; **Oscar Flores**, Minnesota State University Moorhead; **Marion Styles**, Kent State University

Are there complementarities in the education production function?

John List, University of Chicago; **Jeffrey Livingston**, Bentley University; **Susanne Neckermann**, University of Mannheim & ZEW

School Crowding, Year-Round Schooling, and Mobile Classroom Use: Evidence from North Carolina

Kathryn Rouse, Elon University; **Steven McMullen**, Calvin College

Discussion amongst participants

Index

Name of Participant and Session Code(s)

A

Abadeer, Adel K16
Abdelal, Rawi A2
Akira Motomura D3
Akresh, Richard D10
Aksan, Anna-Maria K4
Alexandrakis, Constantine I1
Ali, Mona B8, D8
Altuzarra, Amaia D16
Ambel, Alemaheu K4
Amin, Vikesh H11
Ampaabeng, Samuel Kofi C4
Amponsah, William B10
An, Yonghong F16
Anderson, Andrew I11
Anderson, Lori A5
Anderson, Stacey C18
Ang, Rachel M9
Angle, John K11
Aparicio, Gabriela M2
Arai, Natsuki K5
Argys, Laura I4, J4
Arment, Jean M3
Ashraf, Mohammad D6
Asiedu, Elizabeth D10
Averett, Susan L. G4, J4
Axelrod, David A18, B18
Ayyagari, Padmaja C19
Aziz, Fahima C16

B

Bagchi, Shantanu A4, H10
Balagyozyan, Aram A3, F3
Baliamoune-Lutz, Mina B10, D10, G10
Baltaduonis, Rimvydas A11

Bampasidou, Maria L4
Banerjee, Lopamudra A8, C8, L7
Bannister, Steve B15, L3, M3
Bansak, Cynthia I5
Baragar, Fletcher C8, D8
Baraghoshi, Behroz I19, L3
Barbosa, Nelson G3, I3
Barenberg, Andy B7
Barkoulas, John B14
Barr, Jason F6, I6
Barreiro-Pereira, Fernando E9
Bartolini, Stefano B5
Basu, Deepankar E7, H8, K8
Batabyal, Amitrajeet A9
Batabyal, Sourav F17, H17, K3
Bates, Laurie L19
Baughman, Reagan F4, G4, I4
Beaudin, Laura J10
Bee, Adam D11
Beggs, Mike C8
Berning, Joshua K19
Bhardwaj, Shilpi C19
Bhatta, Rhea D6
Bhattacharya, Rajesh L8
Bhattacharya, Snehashish A8
Bian, Timothy H18, K5
Bianchi, Marina H2, I2
Bidarkota, Prasad D14, J14
Bilginsoy, Cihan I19
Binatli, Ayla Ogus B3, H18
Biondo, Alessio Emanuele I2
Bissessar, Nicole M19
Bivens, L. Josh E8
Blake, Garfield L19
Bolhassani, Marzi H18
Bonitsis, Theologos Homer A1, B1, G2, I9, J2
Bosley, Stacie H11
Bouvet, Florence F1
Breunig, Ian I19
Bronfman, Javier I10, L19

Bruggink, Thomas H. C3, D3

Bui, Trung H6

Bustillo, Ricardo H14

Buzgalin, Alexander V. K6

C

Cai, Jinghan B3

Caiani, Alessandro H15

Cakan, Esin A3, F3

Caldentey, Esteban Pérez B15, C15

Calimeris, Lauren E6, M19

Callahan, Brian P. E3

Camera, Gabriele K19

Canarella, Giorgio M15

Canidio, Andrea D19

Capehart, Kevin J6

Cardamone, Emina A4, C10

Carter, Scott A8, B8, C8, D8, G7, J7, L7

Carvalho, Laura F5

Caserta, Maurizio I2

Casimir, Arthur Schiller C1

Cavusoglu, Nevin I14

Celik, Necati L3

Cesur, Resul F4, G4, H4, I4, J4

Chakraborty, Shankha K4

Chan, Phoebe D16

Chan, Yun-Shan L4

Chandra, Devaki E4, J18, J5

Chandrasekara, Ray F10

Chang, Beryl L15

Chang, Lenisa J19

Chang, Myong-Hun F6, I6

Chapman, Richard J15

Chatterjee, Chiradip F15

Chen, Cheng A11

Chen, Shu-Heng D5, G6, I6

Chen, Yanan H11

Chen, Yijuan D16

Chen, Ying B7, K8

Chernomas, Robert D8

Chernykh, Lucy B4
Chiang, Tsun-Feng A18, B18
Chie, Bin-Tzong G6
Chih, Yao-Yu C14
Chiu, I-Ming J5
Chortareas, Georgios E. M15
Chou, Shin-Yi
Chou, Shin-Yi A11, D6, I4, J4
Chou, Tzu-Chaun G6
Christie, Tom C3
Chu, Fong-Ling I16
Chua, Kenn Garry L. C9
Cleveland, Mary M. D15
Cline, Nathaniel H3, J15
Cochrane, Joseph F10
Cogliano, Jonathan I8
Collier, Trevor C. D3, E3
Compton, Benjamin C10
Congdon-Hohman, Joshua A5
Conger, Darius J. C3
Conrad, Daren M11
Consedine, Timothy F9
Consoli, Andrea I2
Constantinides, Marietta E11
Conway, Karen F4, G4, J4
Coombes, Trevor F2
Cordero, Jose K5, M18
Corman, Hope H4
Correa, Eugenia H1
Correa, Ricardo E14
Costantini, Orsola E2
Cotet, Anca F4, G4
Coyne, David L2
Craighead, William H6
Craigie, Terry-Ann K4
Crawford, Constance B16
Crawford, Corinne B16
Creamer, Germán G6, J6
Cristea, Mirela B1
Cruz, Ryan E. C3

Cueto, Jose Caraballo E7
Cunningham, Steven R. D2

D

Dadak, Kazimierz B14
Dafnos, George J2
Dahi, Omar S. C2, J1
Dalko, Viktoria A17, E17, G2, J19
Datta, Anusua B6
Dave, Dhaval F4, G4
Davis, Leila K8
de Carvalho, Laura G3, I3
De Pace, Pierangelo G14
de Walque, Damien D10
De, Suvayan B18, M18
Deacle, Scott B17, C17, D17
DeAngelo, Gregory B6, L9
DeHan, Chase L1
Decker, Sandra J4
Del Rossi, Alison J11
Demir, Firat C2, G15, J1
Denaux, Zulal F14
Derrell, Robert A18, J5
DeSimone, Jeff H4
Desli, Evangelia M15
Dettling, Lisa K4
Devkota, Satis K11
Di Guilmi, Corado L18
Dietrich, Michael M16
Dills, Angela H4, I4
Dilmaghani, Maryam B5
Dinovic, Ilir L14
Dittrich, Marcus D7
Dixon, David
Dixon, David I6, J6
Domingo, Gabriel K2
dos Santos, Paulo L H8
Doviak, Eric E17, F17, K17
Dowlah, Caf K14
Doyran, Mine Aysen A17, B17

Doytch, Nadia B2, C9, D4
Dudley, Dean D11, G11
Duggan, Marie A8, B8, C8
Dunn, Stephen 18
Dustin, Sara E18
Dutt, Amitava K. C2
Dwyer, Shane C4
Dzarasov, Ruslan K6

E

Ebert, Laura K18
Eichacker, Nina B8, D8
Eichler, Stefan B17
Eisenberg, Larry L15
Elmslie, Bruce C19
Elyasiani, Elyas D17
Emara, Noha G18, M5
Endut, Norhana I5
Engelhardt, Bryan K19
England, Richard J9
Eren, Mesut A14
Eren, Selcuk F8
Ericson, Keith C18, G18
Erturk, Korkut F5
Eryar, Deger M8

F

Faias, Jose I17, J17
Farmer, Roger M18
Fazzari, Steven E8
Feenberg, Daniel G9
Feigenbaum, James
Feigenbaum, James C10, H10
Feliciano, Zadia M. B2
Folkerson, James A. G8
Ferguson, Thomas E2, G8, H1
Fernandes, Ana K15
Ferrante, Francesco D5, H2
Ferreira, Miguel I17
Fields, David M3

Finkle, Aaron I11
Finnoff, Kade G7
Fisher, Eloy H3
Fletcher, Erin D6
Flores, Carlos L4
Flores, Oscar M19
Flores-Lagunes, Alfonso L4
Floro, Maria I10, L19
Foley, Christina C1
Foley, Duncan J7
Fontana, Giuseppe H1
Ford, Kirsten L1, J15
Forti, Annette C18
Franzini, Maurizio H2, I2
Freedman, Craig H16
Freedman, Ora C16
Freund, Caroline K15
Fuess, Scott Jr. H11
Fukuda-Parr, Sakiko G15
Fulop, Marcel B9

G

Gabel, David B2
Gaffney, Mason D15
Galizzi, Monica A16
Gall, Thomas D19
Gallagher, Kevin P. A2, C2, J1,
Gallagher, Ryan J9
Gallegati, Mauro L18
Gamber, Ed C7, I5
Gao, Jia I4
Gao, Wei K1
Garazzini, Jakob F16
Garces-Voisinat, Juan-Pedro A15
Garcia, Viridiana D4
Garcia-Fuentes, Pablo B10
Gershenson, Seth E6
Gete, Pedro H18
Gevorkyan, Aleksandr V. B19
Gevorkyan, Arkady B19

Geyfman, Victoria B4
Geylani, Pinar Celikkol I11
Gezahegn, Mahlet D10
Gezici, Armagan A8, B8, C8, D8, G7, M1
Ghani, Dr. Waqar A3
Ghosh, Amit F14
Giannikos, Christos F3
Gibbison, Godfrey L19
Gibson, Bill J6
Gilgenbach, Ruth A6, C6
Gillham, Cynthia F9
Giovannoni, Olivier E2
Girasa, Roy E4
Githinji, Mwangi wa B7, G10, J1
Gius, Mark I19
Go, Laurence Anthony L. C9
Goldman, Joseph A14
Goodwin, Neva K6
Gould, Dr. David D4
Gouvea, Raphael M10
Grabel, Ilene A2
Graham, Glenn H10, K2
Gratton-Lavoie, Chiara A16
Gray, Nathan C8
Gray, Wayne E1, G1
Greatrex, Caitlin D17, E17, G16
Green, Jeffrey C16
Greenlaw, Steven E1
Greenstein, Joshua G15
Greenwood-Nimmo, Matthew F5
Grinberg, Ruslan S. K6
Grivoyannis, Constantine Haralambos B1
Grivoyannis, Elias C. I9
Groothuis, Peter A. C3
Gu, Weishi (Grace) A18
Guang, Tian C9
Guertler, Oliver B11
Guleryuz, Ece Handan L10
Gumau-Brisa, Fabia I5
Gunter, Frank A16, G15

Gupta, Nabanita Datta M11

Gurtler, Marc B11

H

Ha, Inhyuck "Steve" F1

Hagmann, David F6

Hamouda, Omar C7

Hannsgen, Greg D18, I18

Hanson, Kobena G10

Hantula, Donald D5

Harris, David C17, D17

Hatch, Lynn A. G7, J11

Haughton, Jonathan F18, M18

Heim, John L14, M18, H18

Heintz, James A8

Henderson, Heath I6, J6

Hennessey, Jessica A4

Henshaw, Meredith A10

Hernandez, Francisco Martinez E7

Hernandez, Gonzalo J1

Hernandez, Ignacio Perrotini H3

Hernandez, Manuel H17

Hill, Brian C11

Hiller, Scott L16

Hillesland, Marya I10

Hong, Chang F14

Hong, Gihoon K14

Hong, Wang C9

Hsu, Sara

Hsu, Sara A10, F10

Hu, Bingjie D4

Hu, Tianyan I4, J4

Hu, Yingyao F16

Hua, Yuhua D11

Huang, Jui-Chi L14

Huang, Wei-Chiao K4

Huang, Wen-Hsiu I16

Huato, Julio C8, D8, K2, L7, M2

Hubbard, Timothy A4, K2

Hutchinson, Christa C4

I

Ibarra, Carlos A. A8, D8
Ibarra, Raul H17, K17
Ilgaz, Doruk B17, C17
Iliescu, Nicoleta K9
Iorgulescu, Raluca A10, F10
Isaac, Alan F6, I6, J6
Isidro, Victor Manuel L1
Islamaj, Ergys H6

J

Jaeckel, Johann K8
Jaenicke, Edward C. A6
James, Jonathan E6, K7
Jayadev, Arjun M1
Jepsen, Lisa L10
Jewell, R. Todd D3
Jia, Man E6
Jiang, Xiao
Jiang, Xiao H8, I8, J8, K8, L8
Jin, Wang G1
Jin, Yi D10
Johnson, Christopher J9, M9
Jolly, Nicholas B9
Jones, Robert C6

K

Kai, Zhao E16
Kallianiotis, John N. A1, G2
Kallon, Kelfala G15
Kalonda-Kanyama, Isaac D10
Kam, Eric F2
Kanago, Bryce A18, J18
Karim, Alema H11, K11
Karmann, Alexander B17
Karner, Paul A15
Kasibhatla, Krishna M. G2, I9
Kasper, Victor B16, D18, J18
Kaushik, Surendra K. E4, L15

Kazarosian, Mark E9, M9
Kazemi, Hossein S. B3
Kazianga, Harounan D10
Kearney, Tim B9
Kelly, Inas Rashad J4
Kelly, Logan J5
Kelly, Michael I5
Khandker, Shahidur F18
Khitarishvili, Tamar F11
Khurana, Indu F11
Kim, Chong-Uk F1
Kim, Jan R. F1
Kim, Jongsung L4
Kim, Young-Ham H14
Kim, Yun H7
Kingsley, David D11, L11
Kinsella, Stephen J5
Kitissou, Kpoti D10, E11
Klein, Lawrence R. B4
Kling, Rober I4
Ko, Chiu Yu B3
Kohn, Jennifer F4, G4
Koka, Katerina A18, G18
Konstantinidis, Charalampos B7
Kotz, David M. K6
Kourtellos, Andros L2
Kozlova, Olesia I14
Krichevskiy, Dmitriy A6
Kulkarni, Kishore K14
Kumar, Vikram J14
Kumazawa, Risa A10, J10
Kurtz, Kenneth I6
Kushnirsky, Fyodor I. B4
Kutan, Ali D14
Kyoko, Mona F3

L

Laajaj, Rachid G5
Lacour, Pierre K16
Lakicevic, Milan C17, E14

Landini, Simone L18
Lang, Hannes B6, L9
Laopodis, Nikiforos T. C17, D17
Laramie, Anthony J. B3
Laurent, Thierry M4
LaVoice, Jessica C1
Lavoie, Marc C3, E8
Lazzarini, Andres J7
Le Marca, Massimiliano I3
Leautier, Frannie A. G10
LeBaron, Blake G6, J6
LeClair, Mark A6
Lee, Kyuho F1
Leeds, Daniel D3
Leeds, Michael A. D3
Leonard, Tammy J9
Lesser, Mary H. G16
Lester, Bijou Yang D5
Levina, Iren H8, I8, J8, K8, L8
Levy, Ariel D17, E17, F17
Levy-Orlik, Noemí B15, F2
Li, Ben K15
Li, Josefina Y. C5
LI, Sanxi B11
Li, Suhui F4, G4
Li, Yuming B3
Liang, Haitao G17, I17, J17
Liebner, Jeffery I5
Lim, Gieyoung F1
Lim, Youngok I11
Lima, Gilberto Tadeu A15, M10
Lin, Fangxia I17, K17
Lin, Hung-pin K18
List, John M19
Liu, Dongpeng J18
Liu, Yizao A4
Livingston, Jeffrey M19
Lohi, Julie B10
Lopez, Ricardo A. K15
Lu, Cuicui F16

Lu, Susan C10, B16

Lu, Zhou D19

Ludema, Rodney K9

Lumbantobing, Rotua C11

M

Macdonald, Sean F17

Maditinos, Dimitrios G2

Maggi, Mark F9

Mahar, Jordan B5

Maksymenko, Svitlana B4

Malindretos, John G2

Maltritz, Dominik B17, D17, E17

Mamatzakis, Emmanouel M15

Marquetti, Adalmir C15, M10

Marshall, James C16, K16

Martinez, Luis Vilanueva J8

Mason, Josh W. E8

Masterson, Thomas B8, F8

Matheson, Victor C3, D3, E3

Mathews, Don H16

Matos, Pedro I17

Matthews, Nicola G8

Mbemba, Augustin B14

McColloch, William J15

McDonough, Carol A11

McGee, Robert T. D1

McHardy, Jolian M16

McLaughlin, Kevin A1

McMullen, Steven M19

Melissas, Nicolas L11

Memon, M. Rashid M8

Mendoza-Pichardo, Gabriel C15, M10

Meyerhoefer, Chad J4

Michl, Thomas E8

Mickens, Alvin A3

Miller, Fabienne D11

Miller, John A. B8

Miller, Stephen M. M15

Mirtcheva, Donka F4, G4, I4, J4

Mitchell, James F5
Mitra, Rajarshi G10
Moe, Thorvald F7
Mohanty, Madhu K16
Mohsin, Mohammed A1
Mondal, Sunita K4
Mongiovi, Gary J7
Montgomery, Heather A17, B17, C17
Moore, Rebecca G18
Morely, James I5
Moretti, Laura D18
Moulton, Shawn D11
Moxnes, Andreas K15
Mozumder, Pallab F15
Mukherjee, Avanti E11, M8
Mukherjee, Deeparghya M16
Mukherjee, Kankana M15
Mukherjee, Zinnia D2, J10
Mulholland, Sean B6, C3, E3
Mundra, Kusum H4
Mungan, Murat E16
Munoz, Juan Alberto Vazquez H3, M3
Muradoglu, Gulnur D14
Murdoch, James J9
Murray, Michael C5, H16, K10
Murray, Thomas D9
Murtagh, James G17, H17, K17
Mustapha, Nazeem I16

N

Nabar-Bhaduri, Suranjana J15
Nakabayashi, Masaki D9
Ndikumana, Léonce D10
Neckermann, Susanne M19
Nell, Ed J7
Nersisyan, Yeva F7
Neveu, Andre R. F6, G6, I14, J6
Nguyen, Hong V. I17, K17, L17
Niankara, Ibrahim J19
Nijkamp, Peter A9

Nikiforos, Michalis G3
Noikokyris, Emmanouil M15
Noton, Carlos L16
Nourayi, Mahmoud M. M15
Ntoko, Kidaya A10
Numa, Guy H16, K10
Nur-tegin, Kanybek D19

O

Ocampo, José Antonio A2, F5
Oh, Catherine A6
Oh, Jong-seok K8
Ohn, Jonathan B4
Ojeaga, Paul M14
Olitsky, Neal C6
Oliva, Nicolas M2
Oliva-Moreno, Juan M11
Omer, Muhammad F17, H17
Onji, Kazuki I18
Orcutt, Bonnie C1
Oreggia, Eduardo H10, K2
Orge-Guentes, Daniela I10
Orhangazi, Ozgur L8
Orzechowski, Paul B18
Osuna, Ruben M11
Ouandlous, Arav B14
Ovsiyenko, Yevgeniya H5
Oyvat, Cem B7, E7, K3, M8

P

Panterov, George G6
Papadimitriou, Dimitri F7
Pape, Adreas Duus F6, I6
Pargianas, Christos I1
Parguez, Alain E2
Park, Hyun Woong I8, J8, K8
Park, Kihyun A1
Park, Sangwon F1
Paschalidis, Athanasios G2
Paszkievicz, Laura G9

Paul, Biru B18, I18
Paulin, Geoffry F9, G9
Peddle, Francis K. D15
Pena, Anita B6, I4
Penarrieta, Luis Castro I15
Peoples, James G11
Perez-Caldentey, Esteban H3
Perez-Lopez, Daniel A5
Perry, Nathan B15, C14, H3
Perumal, Andrew M1
Pesci, Luciano L3
Petsas, Iordanis I1
Piatek, Sean B16
Pham, Van C1
Phelps, Charlotte D. D5
Phillipe-Rochon, Louis F2
Pickbourn, Lynda A8, F8
Pierola, Denisse K15
Piovani, Chiara L1
Plotnikov, Dmitry M18
Polachek, Solomon H11
Polchlopek, Justin L3
Polimeni, John A10, F10
Politis, Evangelos I9
Pope, Robin B11, J17, L17
Pressman, Steven C7
Prieto, Cristina Vilaplana M11
Proano, Christian I3
Proctor, Rick K17
Pugno, Maurizio H2, I2

Q

Qingqing, Dai C9
Quick, Paddy L7
Quinn, Michael M14

R

Rada, Codrina D8, E8, G3
Radovic, Milivoje C17, E14
Raheem, Nejem F15

Ramirez, Miguel K1
Ramrattan, Lall B. L15
Rao, Smriti G7
Ray, Subhash C. M15
Razmi, Arslan C2, J1
Reda, Ayman K10
Rengifo, Erick D17
Restrepo-Tobon, Diego A17, E17
Reyes, Jessica E1
Rezai, Armon G3, I3
Richard, Agesa L10
Richiardi, Matteo F16
Richie, Cristina H5
Rivera-Solis, Luis Eduardo B1, J2
Rodriguez, Armando F3
Rodriquez, Carlos H14
Romanov, Dmitri B9
Ros, Jaime C2
Rosero, Luis C15, J8
Rosser, Barkley F17, I17, J17, K17, L17
Rothert, Jacek E14
Rotthoff, Kurt W. C3, D3, E3
Rouse, Kathryn M19
Rubinstein, Alexander Ya. K6
Ruebeck, Christopher F6, I6
Rugitsky, Fernando I8, L8
Ruiu, Gabriele D5
Ryoo, Soon A8, B8, E8

S

Sabi, Manijeh H17, K17, L17
Sabia, Joseph J. G4, H4, J4
Saboe, Matt A9, M9
Saeed, Khalid K7
Saffer, Henry G4
Sangang, Alvine M1
Santa-Clara, Pedro I17
Santerre, Rexford L19
Santow, Leonard J. D1
Sapra, Ritu B9

Sapriza, Horacio E14
Sarolli, Giandomenico H6
Sarracino, Francesco B5, C5
Sassi, Aliya A14
Sawers, Larry F6
Sawyer, Malcolm H1
Scharfenaker, Ellis J8, K8
Schmidt, Lucie J4
Schmidt, Ted P. B8
Schneider, Markus K11
Schonerwald, Carlos C14
Schwarz, Peter F10, J10
Scott, Robert H7, J18
Seccareccia, Mario E2, H1
Seda-Irizarry, Ian J. L8
Seeley, Karl H15
Selim, Eman C5
Sella, Lisa F16
Sen, Bisakha J4
Serrano, Felipe D16
Setterfield, Mark
Setterfield, Mark G6, J6
Sewell, Ellen A16
Shankar, Kameshwari H9
Sharma, Abhijit M16
Sharma, Rajneesh A3
Sharma, Shital G1
Shaver, Kevin M16
Shin, Yongcheol F5
Shulman, Steven I19
Siemer, Michael J18
Silbert, Megan M11
Sing, HeeYoung J8
Sinha, Ajit J7
Sissoko, Yaya M14
Skott, Peter E8
Slavtcheva, Dessislava L2
Sloboda, Brian M9
Smirnova, Elena A3
Smirnova, Natalia G16, K1

Smith, Julie I5
Smith, Michael D9
Smithin, John F2
Sobanski, Karol B17
Sohrabji, Niloufer B3, M14
Sousa, Ricardo D14
Spector, Lee E18, H18
Stagliano, A.J. A3
Stanley, Denise A16
Starr, Martha B5
Steiger, Christina F1
Stephan, Patrick G17, H17, J17
Stewart, John D3
Stiglitz, Joseph L18
Stillwaggon, Eileen F6
Stillwagon, Josh F14
Stodder, James D18, F18
Stone, Courtenay C16, H18
Storeygard, Adam E9
Styles, Marion M19
Stylianou, Ioanna L2
Sudjana, Brasukra D14
Summers, Peter J5
Suzuki, Tomoya L11
Svec, Justin A4, H10
Synnott, Thomas W. D1
Szymanski, Stefan E3
Szenberg, Michael L15

T

Ta, Chung-Ching D5
Tabriztchi, Rod C. A3
Tabriztchi, Sirousse A3
Tai, Chung-Ching G6
Takenaka, Risa M1
Talassinis, Eleftherios G2
Tan, Chih Ming C4, L2
Tan, Congyan D4
Tanaka, Iwao B2
Tang, Heiwai K15

Tashiro, Sanae E11
Tassier, Troy F6
Tavani, Daniele D8, E18, F5, G3, M18
Tawadros, George E10
Taylor, Lance I3
Taylor, Larry B4
Tcherneva, Pavlina H1
Tebaldi, Edinaldo K5, L4, J5
Tekguc, Hasan M8
Tekin, Erdal G4
Terrizzi, Sabrina H4, J4
Thalassinos, Eleftherios A1, B1, I9, J2
Thelen, Nina D4
Thomas, Chrystol C10, M2
Thuy, Le Thanh I4
Tien, Pao-Lin I5
Tobing, Elwin J19
Todd, Walker G8
Todorov, Galin D14, J14
Togrul, Hande L1
Tokunaga, Junji B19
Tomljanovich, March I5
Torres, Raymond F5
Trudeau, Jenn F4
Trupkin, Danilo H17
Tung, Chen-Yuan G6
Tur-Sinai, Aviad B9

U

Uctum, Merih B2
Udayanganie, Darshana J9
Upadhyay, Mukti D10, K11
Upadhyaya, Kamal F3
Uras, Burak B18, L18
Uribe, Johan L1
Useche, Pilar M11
Ussher, Leanne G6, K18

V

Vachadze, George C9, H7, K5

Vail, Thomas W. D1
Vanderslice, Lane C8
VanGilder, Jennifer C11
Vargas, Blanca Lilia Avendano H3, M3
Vashchilko, Aleksandr K9
Vasquez Mazariegos, William F. F15
Vasudevan, Ramaa B8, C8, D8, F5
Ventouri, Alexia M15
Vera, David I18, M5
Vera, Leonardo B15
Vernengo, Matías B15, C15, H3, L1, J15, L3, M3
Veuthey, Luis K10
Vicril, Deniz K15
Vitaliano, Donald L9
Vlad, Valerica H14
Vlasenko, Polina D2
Vogel, Richard E9, M9
Volz, Brian C11, M4
Von Arnim, Rudiger F5, G3
Vulanovic, Milos A17, C17, E14

W

wa Githinji, Mwangi G10
Wachsman, Yoav A4, M2
Waknis, Parag E18, H18
Wamboye, Evelyn G10
Wang, Bin G11, J5
Wang, Justin D11
Wang, Yang F4, J4
Wang, Yun B11, H17, L17
Wark, Elizabeth C1
Webb, Marquitta M11
Weller, Christian M1
White, Mark D. B5, C5, G5, H5, L9
Widman, Marit I10, L7
Wie, Dainn D17, E17
Wiig, Henrik I10
Wilde, Joshua K5, I18
Winkler, Anne M19
Wolff, Edward F8

Wray, L. Randall F7, G8
Wu, Weifeng A18, B18

X

Xia, Le B3
Xu, Yilan L17

Y

Yaari, Gur F6
Yamaguchi, Masao H9
Yan, Ji D6, K19
Yang, Lee-Xieng D5
Yang, Muzhe H4, J4
Yang, Yibai I15
Yankow, Jeffrey F11
Yasar, Yavuz H18, I18
Ye, Guangliang M16
Yee, Janice C1
Yonai, Derek L9
Yoo, Jane F17, G17, K5, M18
Yu, Sung-Eun I18
Yu, Pingkang C6, F17, G17
Yu, Zhi K9

Z

Zacharias, Ajit A8, F8
Zagorsky, Jay L11
Zampera, Vicky A1
Zegeye, Abera C16
Zhang, Doris Yuanyuan E7
Zhang, Lei A9, J9
Zhang, Ling C9
Zhang, Shishu J19
Zhang, Xuelian M4
Zhang, Yanchun D4
Zhang, Yuanyuan L8
Zhao, Zhun L8
Zhen, Ying J11
Zhu, Julie D2
Zhuang, Hong G14

Zimbalist, Andy D3

Ziros, Nicholas L11

Zlate, Andrei E14

Zorzetto, Silvia G5

Zulfiqar, Ghazal M1