



VILLAGE RESIDENCES

Apartment Layout and Photos

Prospective Corporate Intern Residents



A Standard Village Apartment Layout

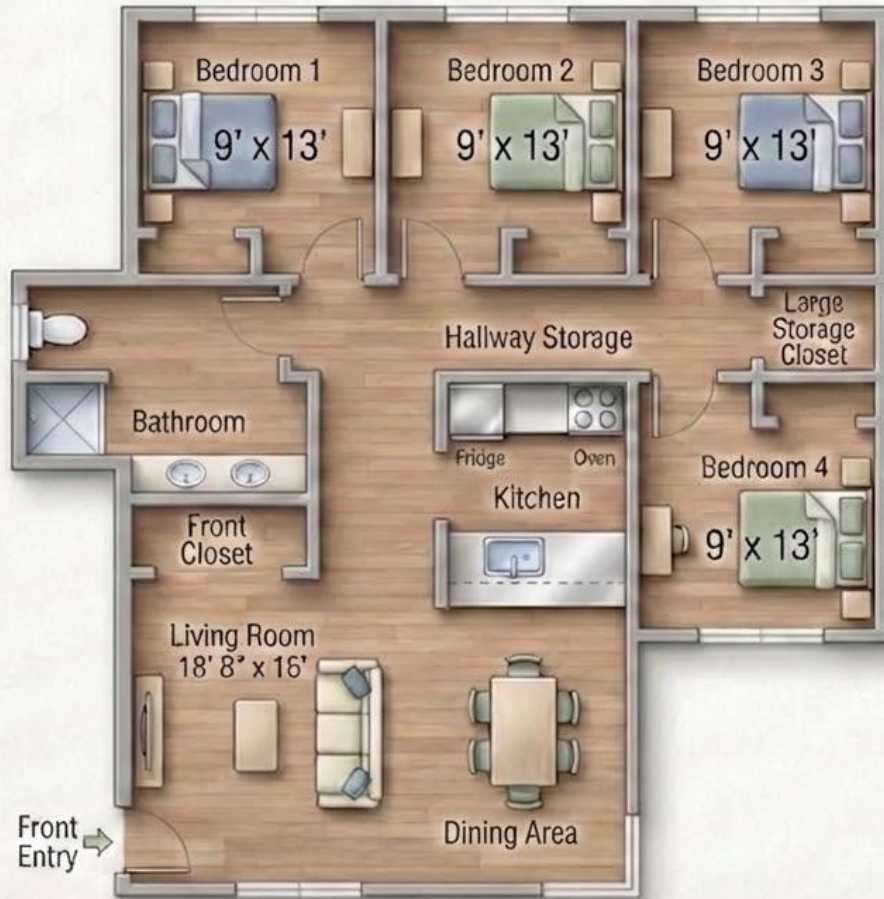

Each Village apartment houses four residents in single bedrooms with a shared kitchen, bathroom, and living space. All bedrooms are approximately 9' x 13'. Living room is approximately 18' 8" x 16'.

-  Bed (Twin XL)
-  Desk + chair
-  Dresser
-  Closet
-  Couch + seating in living room
-  Dining table + chairs

Your Private Bedroom

Comfort and Productivity in Your Own Space



Extra-long twin bed



Study desk & ergonomic chair



Rolling 2-drawer dresser &
built-in closet



Overhead bookshelf storage



Standard Village Apartment

Spacious & Functional Living



Spacious Bedroom



Bedroom Closet



Desk/Storage

Modern Kitchen Layout

Culinary Convenience at Home



Full-size refrigerator



Electric 4-burner stove & oven



Microwave & stainless sink



Generous cabinet storage

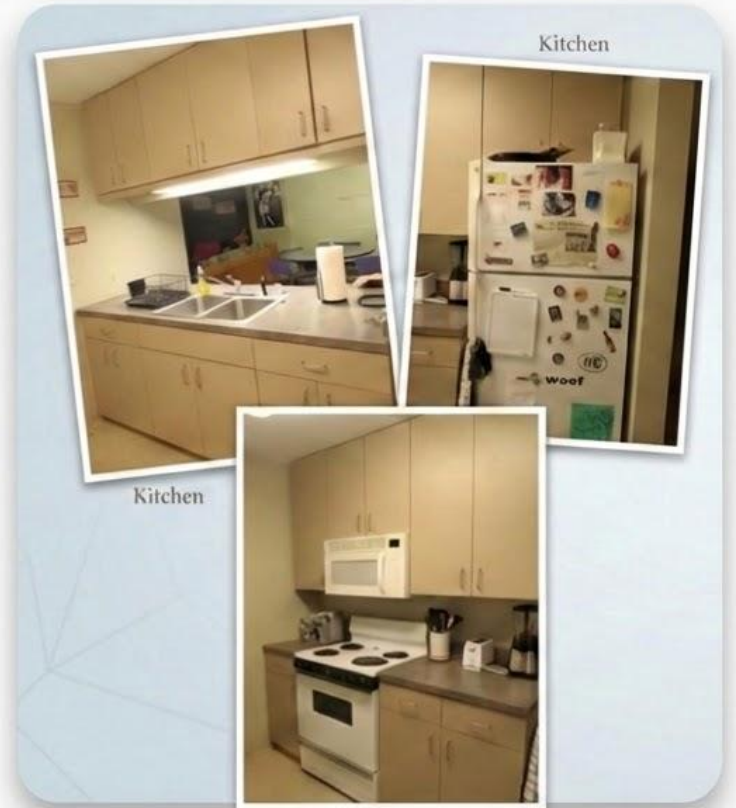

The Kitchen



Kitchen



Kitchen Pantry



Kitchen



Kitchen



Living & Dining Area

Relax and Connect with Roommates



Comfortable sofa & lounge chair



Modern coffee & end tables



Dining table with 4 chairs



Cable TV access provided

The Village Apartments - Interior Views



Living Room & Dining Area



Dining Area



Hallway



Hallway



Hallway

The Village Apartments: Bathroom Details



Bathroom



Bathroom



Bathroom



Bathroom

Preparing for Your Move

Essential Checklist for a Smooth Arrival



What to Bring



- ✓ Bed linens & pillows
- ✓ Towels & toiletries
- ✓ Kitchenware (pots, pans, plates)
- ✓ Personal electronics & lamps
- ✓ Cleaning supplies



What's Provided



- ✓ All major furniture pieces
- ✓ High-speed internet access
- ✓ Kitchen appliances
- ✓ Built-in storage solutions
- ✓ Utilities (Water, Electricity)



Layouts may vary slightly by building. All provided furniture must remain in the apartment. We look forward to seeing you!

Thomases Commons Front Entrance



Aerial Views of the Village Residence Community

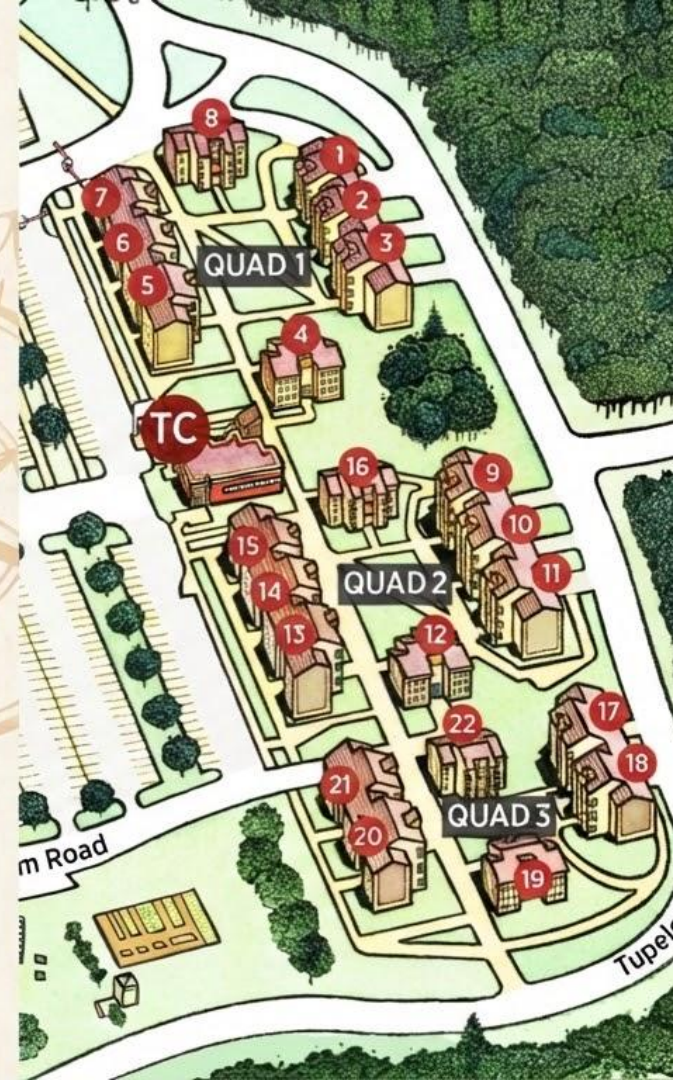



QUAD
1

THOMASES
COMMONS (TC)

QUAD
2

QUAD
2



The Village Apartment Area

22 Stairwells (buildings)
(there are 12 separate building groups)



Quads

- Quad 1 (01-08)
- Quad 2 (09-16)
- Quad 3 (17-22)



The Thomases Commons (TC)

This building contains the Village hall office, the Laundry room, social/study lounge, vending machine room, and Village residents' mailboxes.



Summer Corporate Intern Housing Program | Ramapo College of New Jersey

Program Information & Guides

 [Guide to Corporate Intern Housing](#)

 [Instructions / Policies](#)

 [Timeline](#)

 [Cost Info](#)

 [FAQ's](#)

Required Forms & Contacts

 [Required Forms Before Move-In](#)

 [Corporate Intern Summer Check-in Agreement Form](#)

 [Summer Emergency Contact & Missing Person Contact Information Form](#)

 [Corporate Contact Summary Form](#)
[Summer Corporate Contact Summary Form](#)